

# Traffic Count Services Contract

## DESCRIPTION

- ✓ Contract 9985-27 covers Traffic Count Services for all agencies within the Commonwealth.
- ✓ There is no minimum dollar amount per order.
- ✓ Blanket purchase orders may be used by the contracting agency for a set period of time (e.g., month, quarter, etc., up to but no longer than one fiscal year).
- ✓ Contractor counts must be accepted by contracting agency prior to payment. A 10% dollar retainer shall be deducted from monthly invoices. The retainer shall be released to the contractor when 85% of the total number of counts listed on the purchase order has been accepted by the contracting agency.

## CONTRACT INFO

Contract Number & Title SAP Outline Agreement Number Begins with 460000xxx.	9985-27 Traffic Count Services (SAP 4600007760, -7761, -7762, -7763, -7765, -7766, -7767, -7768, -7769, -7770, -9517)
Number of Suppliers	(11) Multiple Suppliers
Validity Period	04/01/2003-03/31/2008 (Final Renewal)
DGS Point of Contact	James Kling
Contact Phone# Email	717.703.2939 jkling@state.pa.us

## PRICING HIGHLIGHTS

Type of Count	Supplier Price Sheet
<b>Manual Counts</b>	Per supplier, per district, per price sheet.
<b>Volume Counts</b>	Per supplier, per district, per price sheet.
<b>Vehicle Classification Counts</b>	Per supplier, per district, per price sheet.

## PROCESS TO PURCHASE

- ✓ Go to DGS website at [www.portal.state.pa.us](http://www.portal.state.pa.us).
- ✓ Reference statewide contract 9985-27.
- ✓ Review *Contract Terms and Conditions*; *Supplier List*; and *Item Sheets Per Supplier, Per Type, and Per Price Sheet*.
- ✓ Currently, eleven suppliers are available for eleven districts.
- ✓ Contractors must maintain worker's compensation, public liability, and property damage insurance at their expense.
- ✓ Contractors are to use only those counters listed under the DGS Traffic Counter contract 9985-17. This contract may also be referenced at the DGS website, [www.portal.state.pa.us](http://www.portal.state.pa.us).

**SPECIAL CONTRACT TERMS AND CONDITIONS (CONT'D)**

**OPTION TO RENEW:** The Contract or any part of the Contract may be renewed for three (3) additional one (1) year terms by mutual agreement between the Department of General Services (DGS) and the Contractor(s). If the Contract is renewed, the same terms and conditions shall apply, and a new performance security or rider supplementing the original security if applicable will be required for each renewal term.

**PROPOSAL FORMS:** Bidders are cautioned to return all sheets of this Invitation for bids, except those specifications/bid sheets upon which no bid is submitted. Otherwise, the bid may be rejected.

**PROJECT MANAGER:** The Contractor shall designate a Project Manager to coordinate activities between the Contracting Agency and the Contractor for each project received by the Contractor from the Contracting Agency. All daily operational issues and their resolutions are to be handled by the Contractor's Project Manager. The Project Manager designated by the Contractor shall not be changed during any project unless the Contractor provides a five (5) day written notice to the Contracting Agency contact person.

**BILLING REQUIREMENTS:** The Contractor(s) is required to establish separate billing accounts with each using agency and invoice them monthly as directed. Invoices shall be itemized with adequate detail as required by agencies to verify charges. In no instance shall any payment be made for services that have not been "Accepted" and are not in accordance with the prices on the quote provided by the Contractor to the requesting agency. The Contractor shall deduct a 10% dollar retainage from each invoice submitted to the Contracting Agency. Invoices can only include Accepted Counts. "Accepted" means that the Contracting Agency has validated the accuracy of the Count Data for that location based on historical data and directional variation factors. Contractors shall be notified in writing of acceptance of each count within thirty (30) days of receipt of Counts. Counts not taken for any reason will be counted as non-acceptable Counts. Written correspondence including e-mail from the Contracting Agency indicating which Counts have been "Accepted" must be attached to each monthly invoice. Invoices must be delineated by fee structure and type of count.

**BLANKET CONTRACT PURCHASE ORDERS:** Commonwealth agencies may issue Blanket Contract Purchase Orders against this Contract. Such orders may cover all anticipated requirements for a set period of time (i.e. a month, quarter, or year.)

**Note:** The maximum period of time of a Contract Purchase Order shall be one year. These orders constitute the Contractor's authority to perform the services at the requesting agency site(s). All Contract Purchase Orders received by the Contractor up to and including the expiration date of the Contract are acceptable and must be performed in accordance with the Contract Purchase Order and the Contract. The period of performance under any Contract Purchase Order can extend beyond the expiration date of the Contract, but cannot exceed the performance time periods specified in the Contract. While no Contract Purchase Orders can be issued under the Contract after the expiration date of the Contract, the Contract does not expire and continues to be in effect for all existing Contract Purchase Orders until the performance time periods of the existing orders have expired. Each Contract Purchase Order will be deemed to incorporate the terms and conditions set forth in the Contract.

**PERFORMANCE SECURITY:** There shall be a 10% dollar retainage that the Contracting Agency shall deduct and withhold from each monthly invoice submitted by the Contractor. The retainage shall be released to the Contractor when 85% of the total number of Counts on the Purchase Order have been accepted. A Count not taken for any reason will be counted as a non-accepted Count.

**PRE-BID CONFERENCE:** The pre-proposal conference is for information only. Prospective bidders are encouraged to attend the pre-bid Conference to be held on January 24, 2003 at 10:30 AM via video-conference at all Eleven (11) Department of Transportation Engineering District Offices, addresses provided on page Seven (7). The purpose of the Conference is to clarify any points in the bid. Answers furnished during the conference will not be official until verified in writing, by the issuing office. Questions must be forwarded in writing to the buyer listed below to ensure that sufficient analysis can be made before an answer is supplied, e-mail preferred, by the close-of-business 5:00 pm January 13, 2003, please include 9985-27, the bid number. The answers to these questions shall be read at the Pre-Bid conference and posted to our website as specified below in "DGS Response to Bidders Questions".

Norman J. Kee, Buyer  
 Bureau of Purchases  
 Department of General Services  
 Room 414 North Office Building  
 Harrisburg, PA 17125  
 email: [nkee@state.pa.us](mailto:nkee@state.pa.us)

**DGS RESPONSE TO BIDDERS QUESTIONS:** DGS does not respond individually to written questions, all responses shall be posted to the DGS Procurement WebSite approximately ten (10) Commonwealth business days after the pre-bid conference in the form of Flyer(s). The posting of Flyer(s) to the website is the Official Notification to bidders of changes and clarification and no further notice shall be provided. **Attach the Flyer(s) to the original copy of your invitation bid proposal. Failure to do so may result in disqualification of your bid.** DGS WebSite [www.dgs.state.pa.us](http://www.dgs.state.pa.us) click Doing Business with DGS, click Bid Opportunities, click Supply and Service, click Bid Opportunities Search, insert 9985-27 bid number.

**BIDDING INSTRUCTIONS:**

- A. Bidders may submit for any number of Districts (Note: the Districts for this contract coincide with PENNDOT's 11 Engineering Districts).
- B. Bidder's pricing may vary from District to District. Prices for a District apply to all counts within the geographic area of the District. (map & list included in bid)
- C. Pricing applies 365 days per year.
- D. A separate price sheet must be submitted for each District and each type of count for which you are bidding.
- E. Bidders must submit a price for all price tiers and all roadway configurations on each price sheet (i.e., the entire price sheet must be completed with pricing). Bids not meeting this criteria may be considered non-responsive.
- F. Except for "Manual Counts", bidders must delineate pricing on the price sheets, and pricing may vary by:
  - a. District
  - b. Type of count
  - c. Number of counts (tiers delineated on price sheets)
  - d. And roadway configuration

- G. Manual Count pricing must be a "per person per hour" fixed fee.
- H. **Prices/bids are to include all costs** (including but not limited to travel expenses, benefits, overhead, profit, waste, un-accepted counts, etc.).

Although this Contract is written primarily for the Department of Transportation, other Commonwealth Agencies may avail themselves of these services. Prices provided by Contractor in each Engineering District shall apply to all Commonwealth Agencies within the Engineering District without exception.

**BIDDER QUALIFICATIONS:**

- a) Three acceptable references for traffic counts.
- b) A list of all contracts that have included traffic counts over the last 2 years, listing the locality, type, contact name and phone number.
- c) Subcontracting is not permitted under this contract without prior written consent of the Department of General Services Buyer.

**SPECIFICATIONS APPLICABLE TO ALL COUNTS:**

1. All counting operations are to be conducted with the safety of the crew and motoring public as the priority. The Contractor shall follow all Department of Transportation safety requirements and recommendations, particularly the "Work Zone Traffic Control, Traffic Counter Installations and Removal" found in *Exhibit A*.
2. Should the Contractor conclude that data collection at any site is not possible or presents unacceptable risk, the Contractor shall notify the Contracting Agency in writing within 5 calendar days of the site visit. Notification shall consist of identification of the location and a full description of the problem.
3. Any count not taken for any reason will be considered a non-accepted count.
4. Count data must be in either 15-minutes or 1-hour intervals, to be specified in the purchase order.
5. Contractor must initiate data collection within 30 calendar days of receipt of the purchase order.
6. All count data must be submitted within the following timeframes:
  - a. For purchase orders for 1 to 20 counts, 45 calendar days from receipt of the purchase order.
  - b. For purchase orders for 21 to 100 counts, 90 calendar days from receipt of the purchase order.
  - c. For purchase orders for 101 to 300 counts, 180 calendar days from receipt of the purchase order.
7. In addition to supplying the count data to the Contracting Agency, the Contractor shall e-mail a copy of all counts taken to [ra-penndotcounts@state.pa.us](mailto:ra-penndotcounts@state.pa.us)
8. The following items will be specified in each purchase order:
  - a. Type and number of counts by roadway configuration
  - b. Duration of the count(s) (e.g., 8, 24, 48 hours, etc.)
  - c. Scheduling requirements (e.g., particular day, holiday-exclusions, weekend exclusions, etc.)
  - d. Location(s)
  - e. Any special data format needs not specified herein (limited to *Microsoft* suite of products)
  - f. Bin requirements (e.g., number of vehicle classes, turns, etc.)

9. **Prices/bids are to include all costs** (including but not limited to travel expenses, benefits, overhead, profit, waste, un-accepted counts, etc.).
10. Multiple and simultaneous purchase orders from the same Contracting Agency with the same Contractor are permissible.
11. Contractor shall use only those counters listed on Department of General Services "Traffic Counters" contract #9905-17 as amended that may be found on the DGS web-site: [www.dgs.state.pa.us](http://www.dgs.state.pa.us) click Doing Business with DGS, click View Statewide Contracts, insert contract number.

Currently Approved Counters (PA DGS Contract #9905-17)	
Manufacturer	Model
Manual Counters (Type 1)	
Diamond Traffic Products	Titan 64 Titan Intersection Counter
Jamar Technologies	DB-400 TDC-8 TDC-12
Road Tube Volume Counters (Type 2)	
Diamond Traffic Products	Pegasus 2RT 324K Memory
International Road Dynamics	TCC540 Traffic Counter
Jamar	TRAX Mite TRAX I
MetroCount	MC 5600 Base
PAT America	Mini-TRS-4RT
Peek Traffic	ADR750-2RT
TimeMark, Inc.	Gamma 6060001

Road Tube Class Counters (Type 4)	
Diamond Traffic Products	Unicorn Limited 2RT 1 Meg Memory
International Road Dynamics	TCC540 Traffic Counter
Jamar	TRAX I TRAX Mite TRAX RD
MetroCount	MC 5600 Regular
PAT America	Mini-TRS-4RT
Peek Traffic	ADR1000/4RT
TimeMark	Delta 3L 6034002

**ADDITIONAL VOLUME COUNTS SPECIFICATIONS:**

12. Counts are to include all lanes and all directions of traffic. For non-divided roads, both directions shall be counted together. On parallel (divided) roads, a separate volume count must be taken for each direction. All directions must be counted in the same time period.
13. All counts on State Routes (SR) must be submitted in a format identical to the output for PENNDOT's Traffic Data Upload System (TDUS), specifically the Volume Count Record Layout. This format is detailed in *Exhibit B*. TDUS software may be obtained from PENNDOT's Bureau of Planning & Research by faxing a request to PENNDOT's Bureau of Planning & Research, Traffic Analysis Section at 717-783-9152.

**ADDITIONAL VEHICLE CLASSIFICATION COUNTS SPECIFICATIONS:**

14. Counts are to include all lanes and the count data shall be submitted by lane and direction.
15. All counts on State Routes (SR) must be submitted in a format identical to the output for PENNDOT's Traffic Data Upload System (TDUS), specifically the Machine Vehicle Classification Layout. This format is detailed in *Exhibit C*. TDUS software may be obtained from PENNDOT's Bureau of Planning & Research by faxing a request to PENNDOT's Bureau of Planning & Research, Traffic Analysis Section at 717-783-9152.

**ADDITIONAL MANUAL COUNTS SPECIFICATIONS:**

16. Manual counts may include, but are not limited to: turning movements, volume, and vehicle classification counts.
17. Contracting Agency may request a quote for the number of people needed to take a particular count or counts.
18. Invoices must be itemized as cost per person per hour.
19. Unless otherwise specified in the Purchase Order, manual counts must include all lanes and all directions of traffic.

## DISTRICTS

<b>PENNDOT Engineering District</b>	<b>Counties</b>	<b>PENNDOT Engineering District</b>	<b>Counties</b>
<b>District 1</b> 255 Elm Street Oil City, PA 16301 814-678-7085	Crawford Erie Forest Mercer Venango Warren	<b>District 6</b> 7000 Geerdes Boulevard King of Prussia, PA 19406 610-205-6700	Bucks Chester Delaware Montgomery Philadelphia
<b>District 2</b> 1924 Daisy Street Clearfield, PA 16830 814-765-0400	Cameron Centre Clearfield Clinton Elk Juniata McKean Mifflin Potter	<b>District 8</b> 176 Kost Road Carlisle, PA 17013 717-787-6653	Adams Cumberland Dauphin Franklin Lancaster Lebanon Perry York
<b>District 3</b> 715 Jordan Avenue Montoursville, PA 17754 570-368-8686	Bradford Columbia Lycoming Montour Northumberland Snyder Sullivan Tioga Union	<b>District 9</b> 1620 North Juniata Street Hollidaysburg, PA 16648 814-696-7250	Bedford Blair Cambria Fulton Huntingdon Somerset
<b>District 4</b> O'Neill Highway Dunmore, PA 18512 570-963-4061	Lackawanna Luzerne  Pike Susquehanna Wayne  Wyoming	<b>District 10</b> Route 286 South Indiana, PA 15701 724-357-2800	Armstrong Butler Clarion Indiana Jefferson
<b>District 5</b> 1713 Lehigh Street Allentown, PA 18103 610-798-4200	Berks Carbon Lehigh Monroe Northampton Schuylkill	<b>District 11</b> 45 Thoms Run Road Bridgeville, PA 15017 412-429-5000	Allegheny Beaver  Lawrence
		<b>District 12</b> North Gallatin Avenue Uniontown, PA 15401 724-439-7315	Fayette Greene Washington Westmoreland

**PRICE SHEET for Volume or Class Counts**

DISTRICT: \_\_\_\_\_ TYPE OF COUNTS (Circle) Volume Class SUBMITTER: \_\_\_\_\_

**NOTE:** A separate Price Sheet must be completed for each District in which you wish to place a bid and for each type of count. Bidders must submit a bid price for every price tier and every roadway configuration below. Any bids not so complete will be determined to be non-responsive. **Prices/Bids are to include ALL costs** (including but not limited to travel expenses, benefits, overhead, profit, waste, un-acceptable counts, etc.). Multiple and simultaneous purchase orders from the same contracting agency are permissible.

ENTER YOUR PRICE FOR A **SINGLE** COUNT FOR EACH ROADWAY CONFIGURATION AND TIER.

Roadway Configuration		TIER (Number of Counts in Purchase Order)		
		1 to 20	21 to 100	101 to 300
TWO Lane	WITH physical barrier			
	WITHOUT physical barrier			
FOUR Lane	WITH physical barrier			
	WITHOUT physical barrier			
SIX Lane	WITH physical barrier			
	WITHOUT physical barrier			
EIGHT Lane	WITH physical barrier			
	WITHOUT physical barrier			

## PRICE SHEET for Manual Counts

SUBMITTER: \_\_\_\_\_

**NOTE:** Enter a price only in the District(s) in which you are willing to take manual counts; prices may vary by District.

**Prices/Bids are to include ALL costs** (including but not limited to travel expenses, benefits, overhead, profit, waste, un-acceptable counts, etc.).

District	Hourly price per person
1	
2	
3	
4	
5	
6	
8	
9	
10	
11	
12	

**SENSITIVE INFORMATION/NEWS RELEASES:** Except as enumerated below the Contractor(s) shall not:

- (A) Publish or otherwise disclose, except to the Commonwealth and except matters of public record, any information or data obtained during the course of performance under the Contract, except with the consent of the ordering Commonwealth agency.
- (B) Release news relating to the performance of this Contract unless prior approved by the ordering agency. The ordering Commonwealth agency reserves the sole right to issue news releases regarding any incidents that may occur during the Contract term.

**METHOD OF AWARD: (MULTIPLE AWARD):** Except as otherwise provided, award will be made to all responsible and responsive bidders, who comply with the "Eligibility Requirements". Prices are not a factor in receiving an award for this Contract. Pricing must, however, apply to all agencies of the Commonwealth and shall be a factor in the agencies final selection. Commonwealth agencies shall select Contractors for the required service from the list of Contractors on the Contract based upon best value.

**UPDATE OPTION AND APPLICATION:** New Contractors may be added each calendar quarter during the Contract period or any renewal period by presenting the proper credentials, as outlined in the "Eligibility Requirements". Contractor(s) renewing their Contract agree to comply with the original terms and conditions and the Special Contract Terms And Conditions, as provided in the original Contract. In addition Contractor(s) may add additional Districts quarterly to their existing contract or during any renewal period, geographic pricing by District is acceptable.

**TRANSITION FROM EXISTING SERVICE CONTRACTS:** Some agencies may have existing Service Purchase Contracts for the services listed in this Contract. Upon award of this Contract, 9985-27 Traffic Count Services, agencies under the Governor's jurisdiction may continue their own Contracts but may not execute any renewal or extension options. At that point, the agencies must use this Contract.

**PRICE LISTS:** Bidders must submit a copy of their price list, no later than two days after notification from DGS for their services listed above in the "Statement of Work". All charges, including wages and benefits, equipment costs, costs for supervision, overhead, insurance etc. shall be included. The Contractor may not charge a higher price than that provided on their District price list, but may negotiate lower prices with the Contracting Agency. Contractors may not submit surcharges of any type, mileage or any other charges that were not previously disclosed on their original price list. At no time may a Contractor unilaterally change the services or prices of the Contract.

It shall be the responsibility of the Contractor to distribute new price lists to Commonwealth agencies. Approval of yearly price updates or adding additional locations must be approved in advance by the DGS Buyer. Approval of requests for yearly pricing updates will not affect the pricing under existing Contract Purchase Orders.

**DISTRICT PRICING:** District pricing is acceptable.

**UPDATE PRICE OPTION:** Contractors may adjust their prices one (1) time every twelve (12) month period during the Contract term and at any renewal. A Contractor seeking to update its price list shall submit a letter with adjusted prices in accordance with the Consumer Price Index Table 4. <http://stats.bls.gov/news.release/cpi.t04.htm> (Unadjusted percent change to the effective month/year of contract to preceding month/year) for Urban Wage Earners and Clerical Workers (CPI-W) for all U.S. Cities to the DGS Buyer requesting approval of the updated price list. Scroll to "Commodity and Service Group", sub heading Transportation services that is published by the U.S. Government's Department of Labor Bureau of Labor Statistics. The list will always be for the preceding full month more or less depending when the list is updated. The Contractor shall itemize all hourly price or other price changes in a clear and concise fashion. If approved, a Contract change notice will be issued by the Buyer, Department of General Services replacing the price list with the updated price list to the Contract. **(Example:** The Percent (%) change from September 2001 to September 2002 was 4.3%, this percentage would be added to the Contractor(s) Original Rate. Rates charged by the Contractor if other than hourly shall use the same percentage (%) factoring. If the Contractor(s) original rate was \$11.05 the New Rate would be \$11.53, additional years will be based upon the preceding year.)

**INSURANCE:** Contractors shall, at their expense, procure and maintain during the term of the Contract, the following types of insurance, issued by companies acceptable to the DGS and authorized to conduct such business under the laws of the Commonwealth of Pennsylvania:

- a. Worker's Compensation Insurance for all of the Contractor's employees and those of any subcontractor, engaged in work at the site of the project as required by law.
- b. Public Liability and Property Damage Insurance to protect the Commonwealth, the Contractor, and any and all subcontractors from claims for damages to property, including loss of use resulting from any property damage, which may arise from the activities performed under the Contract or the failure to perform under the Contract, whether such performance or nonperformance be by the Contractor, by any subcontractor, or by anyone directly or indirectly employed by either. The limits of such insurance shall be in an amount not less than \$500,000 each person and \$2,000,000 each occurrence, personal injury and property damage combined. Such policies shall be occurrence rather than claims-made policies and shall not contain any endorsements or any other form designated to limit and restrict any action by the Commonwealth, as an additional insured, against the insurance coverage in regard to work performed for the Commonwealth.

Prior to commencement of the work under any contract purchase order, the Contractor(s), shall provide the ordering agency with current certificates of insurance naming the Commonwealth of Pennsylvania as an additional insured. These certificates shall contain a provision that the coverage's afforded under the policies will not be cancelled or changed until at least thirty (30) days' written notice has been given to the agency.

The ordering agency shall be under no obligation to obtain such certificates from the Contractor(s). The agencies' failure to obtain same certificates shall not be deemed a waiver of Contractor's obligation to obtain and furnish certificates. DGS and the agencies, shall have the right to inspect the original insurance policies held by the Contractor(s).

**MINIMUM ORDER:** There is no minimum order; all agencies shall use this contract.

**INQUIRIES:** Direct all questions concerning this Contract to Norman Kee, Telephone No. (717) 787-7675, e-mail [nkee@state.pa.us](mailto:nkee@state.pa.us)

The total number of pages for the Special Contract Terms And Conditions for this Contract is twelve (12).

The contractor(s) identified by an "X" in the Act 57 of May 15, 1988 column has agreed to sell the awarded item(s) at the same prices and/or discounts, and in accordance with the contractual terms and conditions as amended by Act 142 of 2002, local public procurement units to participate in those contracts for supplies, services, or construction entered into by DGS that are made available to local public procurement units and any other Commonwealth Purchasing agencies. A "local public procurement unit" is defined as: any political subdivision, public authority, any tax exempt nonprofit educational or public health institution or organization and any nonprofit fire company, any nonprofit rescue company, any nonprofit ambulance company and to the extent provided by law, any other entity, including a council of governments or an area government that expends public funds for the procurement of supplies, services and construction. Those local public procurement units listed above which issue orders under the contract are the intended beneficiaries under the contract and are real parties in interest with the right to sue and be sued without joining the Commonwealth of Pennsylvania Department of General Services as a party and any other Commonwealth Purchasing agencies. Local public procurement units that elect to participate in the contract will order items directly from the contractor and will be responsible for payment directly to the contractor.

Act 57	SUFFIX	CONTRACTOR NAME/ADDRESS	TELEPHONE NO.	FAX NO.	CONTACT PERSON
YES		The Traffic Group Inc. 9900 Franklin Square Dr., Suite H Baltimore, MD. 21236	410-931-6600	410-931-6601	Donald Hayes
YES		Computerized Traffic Data Inc. 14444 Beach Blvd. Suite 18-332 Jacksonville, FLA. 32250	904-992-9355	904-223-0021	Michael Lowery
YES		John J. Clark & Associates 5933 Baum Blvd. Pittsburgh, PA. 15206	412-361-3200	412-361-3319	John J. Clark
YES		Count Electronics P.O. Box 30 7166 Deerville Ave Ext. Uhrichsville, OH. 44683	740-922-3183	None	Todd M. Renicker
YES		GAI Consultants, Inc. 570 Beatty Road Monroeville, PA. 15146	412-856-9220	412-372-2161	David F. Kundrat
YES		MCV Associates, Inc. 4605-C Pinecrest Office Park Drive Alexandria, VA. 22312	703-914-4850	703-914-4851	Jawahar Mehara
		Tri-State Traffic Data, Inc. 184 baker Road Coatesville, PA. 19320	610-466-1469	610-466-1470	Patrick J. Fiore
YES		McMahon Associates, Inc. 425 Commerce Drive Suite 200 Fort Washington, PA. 19034	215-283-9444	215-283-9445	Joseph J. Desantis

YES		Transportation Resource Group, Inc. 204 N. George Street, Suite 110 York, PA. 17401	717-846-4660	717-846-4858	Jon A. Seitz
		URBITRAN 150 River Road, Bldg. E. Montville, N.J. 07045-9421	973-299-2910 ext. 202	973-299-0347	Gary W. Davies
YES		Gilmore & Associates, Inc. 350 East Butler Avenue New Britain, PA. 18901	215-345-4330	215-345-8606	Eric M. Kaufman
YES		Progressive Engineering Technologies Corp. (PET) 6660-H Dobbin Road Columbia, MD. 21045	410-381-1995	410-381-7829	John Reed

**TRAFFIC COUNT SERVICES  
ITEM SHEET**

ITEM NO.	SAP VENDOR NUMBER & CONTRACT NUMBER	PRICE LIST EFFECTIVE DATE AND AREAS OF SERVICE	COMPANY NAME	FIN #
1.	SAP #199427 4600007770	District Coverage: 6 & 8 For Volume, Class and Manual See attached Price Sheets	The Traffic Group Inc. 9900 Franklin Square Drive, Suite H Baltimore, Md. 21236-5915	52-1391057
2.	SAP # 183578 4600007760	District Coverage: All except 6 & 11 For Volume and Class Manual: <u>ALL DISTRICTS</u> See attached Price Sheets	Computerized Traffic Data Inc. 14286 Beach Blvd. Ste 19-355 Jacksonville, FLA. 32250-1568	59-2835963
3.	SAP # 162863 4600007761	District Coverage: 1,9,10,11 & 12 <u>MANUAL ONLY</u> See attached Price Sheets	John J. Clark & Associates 5933 Baum Blvd. Pittsburgh, PA. 15206-3807	36-3467928
4.	SAP # 185620 4600007762	District Coverage: ALL For <u>Volume</u> and <u>Manual</u> District Coverage: 1,2,3,4,5,8,9,10,11 & 12 For <u>Class</u> See attached Price Sheets	Count Electronics P. O. Box 30 7166 Deerville Ave Uhrichsville, OH. 44683-0030	34-1830939
5.	SAP # 150549 4600007763	District Coverage: 1, 10, 11 & 12 For Volume, Class & Manual See attached Price Sheets	GAI Consultants, Inc. 385 East Waterfront Drive Homestead, PA 15120-5005	25-1260999
6.	SAP # 199420 4600007764	District Coverage: ALL For <u>Volume</u> and <u>Manual</u> See attached Price Sheets	MCV Associates, Inc. 4605-C Pinecrest Office Park Drive Alexandria, VA. 22312	54-1553636

**TRAFFIC COUNT SERVICES  
ITEM SHEET**

7.	SAP # 134600 4600007765	District Coverage: ALL For Volume, Class & Manual See attached Price Lists	Tri-State Traffic Data, Inc. 184 Baker Road Coatesville, PA. 19320-1402	23-2843075
8.	SAP # 128483 4600007766	District Coverage: 4, 5, 6 & 8 For Volume, Class & Manual See attached Price Sheets	McMahon Associates, Inc. 425 Commerce Drive Suite 200 Fort Washington, PA. 19034-2713	23-2462387
9.	SAP # 184714 4600007767	District Coverage: 3, 5, 6, 8 & 9 For Volume, Class & Manual See attached Price Sheets	Transportation Resource Group, Inc. 204 N. George Street, Suite 110 York, PA. 17401-1108	23-2553315
10.	SAP # 197783 4600007768	District Coverage: 3, 4, & 5 For Volume & Class See attached Price Sheets	URBITRAN 150 River Road, Bldg. E Montville, N.J. 07045-9421	13-5429150
11.	SAP # 201700-001 4600009517	District Coverage: 5 & 6 For Volume, Class & Manual See attached Price Sheets	Gilmore & Associates, Inc. 350 East Butler Avenue New Britain, PA. 18901-5209	23-1992323
12.	SAP # 197783 4600007769	District Coverage: 6, 8, 9, 11 & 12 For Class Counts only See attached Price Sheets	Progressive Engineering Technologies Corp. (PET) 6660-H Dobbin Road Columbia, MD. 21045-4844	52-1733642

DATE: November 8, 1994

470-94-71

SUBJECT: Work Zone Traffic Control  
Traffic Counter Installations and Removal

EXHIBIT A

TO: District Engineers \_\_\_\_\_

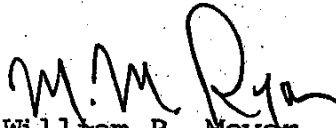
FROM:   
William R. Moyer, P.E.  
Deputy Secretary for Highway Administration

The following will establish the Work Zone Traffic Control Guidelines for the installation and removal of traffic counters on various types of highways. This policy updates and rescinds the policy on the same subject dated November 3, 1987.

1. General. The basic figure from Publication 203 (67 Pa. Code, Chapter 203) which should be used for the installation and removal of traffic counters is Figure 5. A copy of this figure is attached.

1.1 Signs. When advance warning signs are used in accordance with Figure 5, they shall read "WORK AREA AHEAD" and have three 16" x 16" minimum size orange flags attached to the top of each sign by staffs that are a minimum of 24" long. A copy of this sign standard is attached.

Supplementary signs, such as "COUNTER INSTALLATION AHEAD", may be erected in addition to the "WORK AREA AHEAD" signs if so desired. These supplemental signs shall not be used in lieu of the "WORK AREA AHEAD" signs.

1.2 Vehicle. The vehicle used in the work area during the installation or removal of traffic counters shall be equipped with a flashing or revolving yellow strobe light or a bar of lights. If additional strobe lights are installed, they should be installed at the back of the vehicle on the right and left side of the vehicle (the lights should be mounted on the roof of vans and panel trucks and on upright shafts at the back of pick up trucks). If a bar of lights is installed, it should be located on top of the vehicle so it will be visible to all approaching drivers.

1.3 Attire. All traffic counter installation personnel shall wear an orange vest, shirt or jacket. During inclement weather, orange or yellow rain gear

Work Zone Traffic Control  
Traffic Counter Installations and Removal  
Page 2

may be substituted for the orange vest, shirt or jacket. For nighttime conditions, similar outside garments shall be reflectorized.

2. Specific Guidelines. Since the installation and removal of traffic counters normally takes less than 60 minutes, the signs and channelizing devices shown on Figure 5 may be eliminated if the work vehicle (with activated flashing or revolving yellow lights) is located in the work area, and the vehicle and traffic counter personnel can be seen by approaching traffic for a distance, in feet, equal to 10 times the legal speed limit. In addition, if the counter equipment cannot be safely installed due to a narrow shoulder, placement in a travel lane, insufficient sight distance, heavy traffic volume or any other unsafe condition, the traffic counter personnel shall be assisted by a flagger, a uniformed police officer, or a shadow vehicle on the roadway.

We expect all Department and municipal traffic counter installation and removal operations to conform to these guidelines. If you have any questions on this matter, please contact Richard Sesny of the Traffic Engineering and Operations Division at (717) 783-6080.

Attachments

470/TF/bmm

cc: Secretary Yerusalim, Room 1200  
William R. Moyer, P.E., Room 1220  
Michael M. Ryan, P.E., Room 1212  
Fred W. Bowser, P.E., Room 1118  
Joseph Filippino, P.E., Room 1212  
Gary L. Hoffman, P.E., Room 1004  
Wayne W. Kober, Room 1009  
Richard H. Harris, Room 105  
Thomas E. Bryer, P.E., Room 203  
Thomas TenEyck, P.E., Room 906  
Joseph McGinnis, Room 906  
Thomas Reindollar, Room 906  
James Tenaglia, P.E., Room 216  
Dave Cough, FHWA  
Phil Catalano, PA Turnpike Commission  
District Traffic Engineer, Engineering District \_\_\_\_\_  
\*Library Services, Room 112  
Arthur H. Breneman, P.E., Room 215  
Richard J. Sesny, P.E., Room 215  
\*Attachments available in Room 215

Work Area Ahead Sign, W21-7.

The Work Area Ahead Sign, W21-7, shall be authorized for use in advance of obstructions or restrictions that a motorist may encounter at construction, maintenance, or utility work areas. The 48 inches by 48 inches size may indicate the actual distance in lieu of the legend "AHEAD".



COLOR - LEGEND AND BORDER  
BACKGROUND

BLACK (NON-REFLECTORIZED)  
ORANGE (REFLECTORIZED)

SIGN SIZE	DIMENSIONS						
	A	B	C	D	E	F	G
36 x 36	36	6	2 1/2	9	8 1/2	10 1/2	2 1/2
48 x 48	48	8	3 1/2	12 1/2	11 1/2	14	2 1/2

SIGN SIZE	SERIES			MAR- GIN	BOR- DER	BLANK STD
	1	2	3			
36 x 36	C	C	C	1/2	1/2	83-36
48 x 48	C	C	C	3/4	1 1/4	83-48

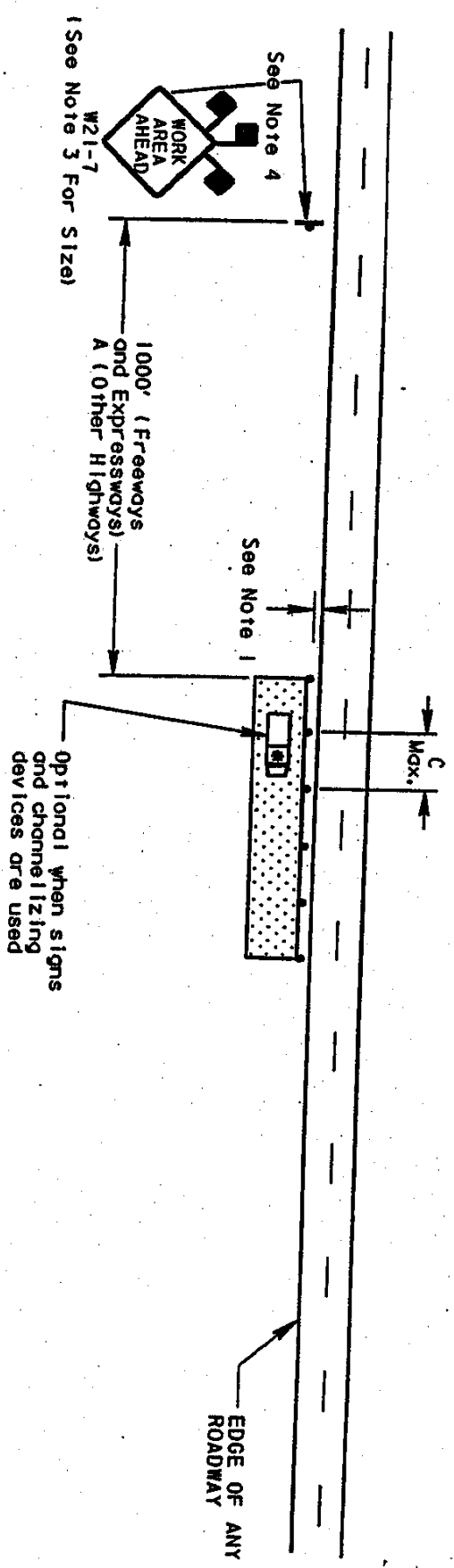

**SYMBOLS**

Work area

Sign

- Channelizing device
- Vehicle with a flashing or revolving yellow light

S Normal speed limit

S	A	C
(MPH)	(FT)	(FT)
25	250	50
30	300	60
35	350	70
40	400	80
45	450	90
50	500	100
55	550	110

**NOTES**

- This figure applies for stationary short-term operations adjacent to any roadway. However, the traffic control devices prescribed in this figure are not required if the work area is more from the edge of any roadway.
- All distances may be adjusted slightly to fit field conditions.
- Work Area Ahead Signs shall be a minimum size of 48" x 48" for freeways and expressways, and 36" x 36" minimum for all other highways.
- For divided highways and one-way highways where it is physically possible, advance warning signs should also be placed on the left-hand side of the roadway.
- The Work Area Ahead Signs may be replaced with other appropriate signs (Low Shoulder Sign, No Guide Rail Sign, and so forth).
- During hours of darkness, all signs shall be reflectorized or illuminated, and each advance warning sign shall have a Type A or Type B light.
- For operations 60 minutes or less in duration, all signs and channelizing devices may be eliminated if a vehicle with an activated flashing or revolving yellow light is used.

FIGURE 5. STATIONARY SHORT-TERM OPERATION - ADJACENT TO ANY ROADWAY

### Traffic Data Upload System (TDUS) Volume Count Record Layout

**Exhibit B**

**Sample Axle Count** H02142000610000500051720013002455SR 0155 SR 1021 7404RAINY 02 05172001RTK05172001  
D002900240011002600250136030704790334028803190367035303680406049005060488025202170195012000750073

DEND

1	2-3	4	5-6	7-10	11-14	15-18	19-26	27	28-29	30-31	32-33	34-53	54-73	74-77	78-87	88-90	91-98	99-101	102-109	110-139	140
Record Type	District	Jurisdiction	County Code	State Route/Federal ID	Segment	Offset	Count Date	Count Type	Start Hour	Ending Hour	Speed Limit	Begin Location	End Location	Traffic counter number	Weather	Set by	Setup date	Entered Initials	Entered Date	Comments	Machine Count Lane
H	02	1	42	0006	1000	0500	05172001	3	*00*	24	55	SR 0155	SR 1021	7404	Rainy	02	05172001	RTK	05172001		

\*\* Start hour must begin with 00 for axle counts.

Column	Field Length	*Alpha/Numeric	Description
1	1	A	Record Type- H (Header)
2-3	2	N	District
4	1	N	Jurisdiction (1 State, 5 Local Fed. Aid)
5-6	2	N	County Code
7-10	4	X	State Route/ Federal ID (Capital Letter designator for Local Federal Aid)
11-14	4	N	Segment
15-18	4	N	Offset (state system only when Jurisdiction Code 1)
19-26	8	N	Count Date (MO-DAY-YEAR)
27	1	N	Count Type- 2 (Machine Class), 3 (Axle Sensor), 4 (Loop Sensor)
28-29	2	N	Start Hour (Military format, 01=Machine Class, 00=Axle & Loop Sensor)
30-31	2	N	Ending Hour (Military format ending at 24)
32-33	2	N	Speed Limit
34-53	20	X	Begin Location
54-73	20	X	End Location
74-77	4	N	Traffic Counter Number
78-87	10	X	Weather
88-90	3	X	Set by (See Agency listings for 2 digit Agency Code)
91-98	8	N	Setup Date (MO-DAY-Year)
99-101	3	X	Entered Initials (Initials of person entering data)
102-109	8	N	Entered Date (Retrieval Date, MO-DAY-YEAR)
110-139	30	X	Comments
140	1	N	Machine Count Lane

Detail Record- Axle Sensor/Loop Count

Column	Field Length	*Alpha/Numeric	Description
1	1	A	Record Type- D (Detail)
2-97	96	N	24 hourly readings (4 digits perhour x 24 hrs.



**9985-27**

**Traffic Count Services**

**PRICE LISTS**

**FOR**

1. The Traffic Group, Inc.
2. 9. McMahon Associates, Inc.
3. Computerized Traffic Data Inc.
4. John J. Clark & Associates
5. Count Electronics
6. GAI Consultants, Inc.
7. MCV Associates, Inc.
8. Tri-State Data, Inc.
9. Transportation Resource Group, Inc.
10. URBITRAN
11. Gilmore & Associates, Inc.
12. Progressive Engineering Technologies Corp. (PET)

### PRICE SHEET for Manual Counts

**SUBMITTER:** The Traffic Group, Inc.

**NOTE:** Enter a price only in the District(s) in which you are willing to take manual counts; prices may vary by District.

**Prices/Bids are to include ALL costs** (including but not limited to travel expenses, benefits, overhead, profit, waste, un-acceptable counts, etc.).

District	Hourly price per person
1	-----
2	-----
3	-----
4	-----
5	-----
6	\$70.00
8	\$70.00
9	-----
10	-----
11	-----
12	-----

## PRICE SHEET for Volume or Class Counts

DISTRICT: 6 TYPE OF COUNTS (Circle) Volume SUBMITTER: The Traffic Group, Inc.

**NOTE:** A separate Price Sheet must be completed for each District in which you wish to place a bid and for each type of count. Bidders must submit a bid price for every price tier and every roadway configuration below. Any bids not so complete will be determined to be non-responsive. **Prices/Bids are to include ALL costs** (including but not limited to travel expenses, benefits, overhead, profit, waste, un-acceptable counts, etc.). Multiple and simultaneous purchase orders from the same contracting agency are permissible.

ENTER YOUR PRICE FOR A **SINGLE** COUNT FOR EACH ROADWAY CONFIGURATION AND TIER.

Roadway Configuration		TIER (Number of Counts in Purchase Order)		
		1 to 20	21 to 100	101 to 300
TWO Lane	WITH physical barrier	\$108	\$105	\$105
	WITHOUT physical barrier	\$72	\$70	\$70
FOUR Lane	WITH physical barrier	\$135	\$128	\$128
	WITHOUT physical barrier	\$142	\$135	\$135
SIX Lane	WITH physical barrier	\$170	\$162	\$162
	WITHOUT physical barrier	\$178	\$169	\$169
EIGHT Lane	WITH physical barrier	\$227	\$215	\$215
	WITHOUT physical barrier	\$227	\$215	\$215

## PRICE SHEET for Volume or Class Counts

DISTRICT: 6 TYPE OF COUNTS (Circle) Class SUBMITTER: The Traffic Group, Inc.

**NOTE:** A separate Price Sheet must be completed for each District in which you wish to place a bid and for each type of count. Bidders must submit a bid price for every price tier and every roadway configuration below. Any bids not so complete will be determined to be non-responsive. **Prices/Bids are to include ALL costs** (including but not limited to travel expenses, benefits, overhead, profit, waste, un-acceptable counts, etc.). Multiple and simultaneous purchase orders from the same contracting agency are permissible.

ENTER YOUR PRICE FOR A **SINGLE** COUNT FOR EACH ROADWAY CONFIGURATION AND TIER.

Roadway Configuration		TIER (Number of Counts in Purchase Order)		
		1 to 20	21 to 100	101 to 300
TWO Lane	WITH physical barrier	\$170	\$160	\$160
	WITHOUT physical barrier	\$170	\$160	\$160
FOUR Lane	WITH physical barrier	\$300	\$285	\$285
	WITHOUT physical barrier	\$380	\$361	\$361
SIX Lane	WITH physical barrier	\$470	\$446	\$446
	WITHOUT physical barrier	\$550	\$522	\$522
EIGHT Lane	WITH physical barrier	\$540	\$513	\$513
	WITHOUT physical barrier	\$684	\$650	\$650

## PRICE SHEET for Volume or Class Counts

DISTRICT: 8 TYPE OF COUNTS (Circle) Class SUBMITTER: The Traffic Group, Inc.

**NOTE:** A separate Price Sheet must be completed for each District in which you wish to place a bid and for each type of count. Bidders must submit a bid price for every price tier and every roadway configuration below. Any bids not so complete will be determined to be non-responsive. **Prices/Bids are to include ALL costs** (including but not limited to travel expenses, benefits, overhead, profit, waste, un-acceptable counts, etc.). Multiple and simultaneous purchase orders from the same contracting agency are permissible.

ENTER YOUR PRICE FOR A **SINGLE** COUNT FOR EACH ROADWAY CONFIGURATION AND TIER.

Roadway Configuration		TIER (Number of Counts in Purchase Order)		
		1 to 20	21 to 100	101 to 300
TWO Lane	WITH physical barrier	\$170	\$160	\$160
	WITHOUT physical barrier	\$170	\$160	\$160
FOUR Lane	WITH physical barrier	\$300	\$285	\$285
	WITHOUT physical barrier	\$380	\$361	\$361
SIX Lane	WITH physical barrier	\$470	\$446	\$446
	WITHOUT physical barrier	\$550	\$522	\$522
EIGHT Lane	WITH physical barrier	\$540	\$513	\$513
	WITHOUT physical barrier	\$684	\$650	\$650

## PRICE SHEET for Volume or Class Counts

DISTRICT: **8** TYPE OF COUNTS (Circle) Volume SUBMITTER: The Traffic Group, Inc.

**NOTE:** A separate Price Sheet must be completed for each District in which you wish to place a bid and for each type of count. Bidders must submit a bid price for every price tier and every roadway configuration below. Any bids not so complete will be determined to be non-responsive. **Prices/Bids are to include ALL costs** (including but not limited to travel expenses, benefits, overhead, profit, waste, un-acceptable counts, etc.). Multiple and simultaneous purchase orders from the same contracting agency are permissible.

ENTER YOUR PRICE FOR A **SINGLE** COUNT FOR EACH ROADWAY CONFIGURATION AND TIER.

Roadway Configuration		TIER (Number of Counts in Purchase Order)		
		1 to 20	21 to 100	101 to 300
TWO Lane	WITH physical barrier	\$108	\$105	\$105
	WITHOUT physical barrier	\$72	\$70	\$70
FOUR Lane	WITH physical barrier	\$135	\$128	\$128
	WITHOUT physical barrier	\$142	\$135	\$135
SIX Lane	WITH physical barrier	\$170	\$162	\$162
	WITHOUT physical barrier	\$178	\$169	\$169
EIGHT Lane	WITH physical barrier	\$227	\$215	\$215
	WITHOUT physical barrier	\$227	\$215	\$215

## PRICE SHEET for Manual Counts

**SUBMITTER:** McMahon Associates, Inc.

**NOTE:** Enter a price only in the District(s) in which you are willing to take manual counts; prices may vary by District.

**Prices/Bids are to include ALL costs** (including but not limited to travel expenses, benefits, overhead, profit, waste, un-acceptable counts, etc.).

District	Hourly price per person
1	
2	
3	
4	\$ 110.00
5	\$ 90.00
6	\$ 70.00
8	\$ 110.00
9	
10	
11	
12	

**PRICE SHEET for Volume or Class Counts**DISTRICT: 4-0 TYPE OF COUNTS (Circle) Volume Class SUBMITTER: McMahon Associates,

**NOTE:** A separate Price Sheet must be completed for each District in which you wish to place a bid and for each type of count. Bidders must submit a bid price for every price tier and every roadway configuration below. Any bids not so complete will be determined to be non-responsive. **Prices/Bids are to include ALL costs** (including but not limited to travel expenses, benefits, overhead, profit, waste, un-acceptable counts, etc.). Multiple and simultaneous purchase orders from the same contracting agency are permissible.

ENTER YOUR PRICE FOR A **SINGLE** COUNT FOR EACH ROADWAY CONFIGURATION AND TIER.

Roadway Configuration		TIER (Number of Counts in Purchase Order)		
		1 to 20	21 to 100	101 to 300
TWO Lane	WITH physical barrier	\$1,755	\$1,755	\$1,755
	WITHOUT physical barrier	\$1,730	\$1,730	\$1,730
FOUR Lane	WITH physical barrier	\$3,625	\$3,625	\$3,625
	WITHOUT physical barrier	\$2,920	\$2,920	\$2,920
SIX Lane	WITH physical barrier	\$3,800	\$3,800	\$3,800
	WITHOUT physical barrier	\$3,055	\$3,055	\$3,055
EIGHT Lane	WITH physical barrier	\$3,980	\$3,980	\$3,980
	WITHOUT physical barrier	\$3,980	\$3,980	\$3,980

**PRICE SHEET for Volume or Class Counts**

DISTRICT: 4-0 TYPE OF COUNTS (Circle) Volume Class SUBMITTER: McMahon Associates,

**NOTE:** A separate Price Sheet must be completed for each District in which you wish to place a bid and for each type of count. Bidders must submit a bid price for every price tier and every roadway configuration below. Any bids not so complete will be determined to be non-responsive. **Prices/Bids are to include ALL costs** (including but not limited to travel expenses, benefits, overhead, profit, waste, un-acceptable counts, etc.). Multiple and simultaneous purchase orders from the same contracting agency are permissible.

ENTER YOUR PRICE FOR A **SINGLE** COUNT FOR EACH ROADWAY CONFIGURATION AND TIER.

Roadway Configuration		TIER (Number of Counts in Purchase Order)		
		1 to 20	21 to 100	101 to 300
TWO Lane	WITH physical barrier	\$1,850	\$1,850	\$1,850
	WITHOUT physical barrier	\$1,850	\$1,850	\$1,850
FOUR Lane	WITH physical barrier	\$4,340	\$4,340	\$4,340
	WITHOUT physical barrier	\$3,460	\$3,460	\$3,460
SIX Lane	WITH physical barrier	\$4,755	\$4,755	\$4,755
	WITHOUT physical barrier	\$3,785	\$3,785	\$3,785
EIGHT Lane	WITH physical barrier	\$4,755	\$4,755	\$4,755
	WITHOUT physical barrier	\$4,755	\$4,755	\$4,755

**PRICE SHEET for Volume or Class Counts**

DISTRICT: 5-0 TYPE OF COUNTS (Circle) Volume Class SUBMITTER: McMahon Associates,

**NOTE:** A separate Price Sheet must be completed for each District in which you wish to place a bid and for each type of count. Bidders must submit a bid price for every price tier and every roadway configuration below. Any bids not so complete will be determined to be non-responsive. **Prices/Bids are to include ALL costs** (including but not limited to travel expenses, benefits, overhead, profit, waste, un-acceptable counts, etc.). Multiple and simultaneous purchase orders from the same contracting agency are permissible.

ENTER YOUR PRICE FOR A **SINGLE** COUNT FOR EACH ROADWAY CONFIGURATION AND TIER.

Roadway Configuration		TIER (Number of Counts in Purchase Order)		
		1 to 20	21 to 100	101 to 300
TWO Lane	WITH physical barrier	\$1,310	\$1,310	\$1,310
	WITHOUT physical barrier	\$1,285	\$1,285	\$1,285
FOUR Lane	WITH physical barrier	\$2,730	\$2,730	\$2,730
	WITHOUT physical barrier	\$2,200	\$2,200	\$2,200
SIX Lane	WITH physical barrier	\$2,910	\$2,910	\$2,910
	WITHOUT physical barrier	\$2,335	\$2,335	\$2,335
EIGHT Lane	WITH physical barrier	\$3,080	\$3,080	\$3,080
	WITHOUT physical barrier	\$3,080	\$3,080	\$3,080

**PRICE SHEET for Volume or Class Counts**

DISTRICT: 5-0 TYPE OF COUNTS (Circle) Volume Class SUBMITTER: McMahon Associates,

**NOTE:** A separate Price Sheet must be completed for each District in which you wish to place a bid and for each type of count. Bidders must submit a bid price for every price tier and every roadway configuration below. Any bids not so complete will be determined to be non-responsive. **Prices/Bids are to include ALL costs** (including but not limited to travel expenses, benefits, overhead, profit, waste, un-acceptable counts, etc.). Multiple and simultaneous purchase orders from the same contracting agency are permissible.

ENTER YOUR PRICE FOR A **SINGLE** COUNT FOR EACH ROADWAY CONFIGURATION AND TIER.

Roadway Configuration		TIER (Number of Counts in Purchase Order)		
		1 to 20	21 to 100	101 to 300
TWO Lane	WITH physical barrier	\$1,405	\$1,405	\$1,405
	WITHOUT physical barrier	\$1,405	\$1,405	\$1,405
FOUR Lane	WITH physical barrier	\$3,445	\$3,445	\$3,445
	WITHOUT physical barrier	\$2,740	\$2,740	\$2,740
SIX Lane	WITH physical barrier	\$3,860	\$3,860	\$3,860
	WITHOUT physical barrier	\$3,070	\$3,070	\$3,070
EIGHT Lane	WITH physical barrier	\$3,860	\$3,860	\$3,860
	WITHOUT physical barrier	\$3,860	\$3,860	\$3,860

**PRICE SHEET for Volume or Class Counts**DISTRICT: 6-0 TYPE OF COUNTS (Circle) Volume Class SUBMITTER: McMahon Associates,

**NOTE:** A separate Price Sheet must be completed for each District in which you wish to place a bid and for each type of count. Bidders must submit a bid price for every price tier and every roadway configuration below. Any bids not so complete will be determined to be non-responsive. **Prices/Bids are to include ALL costs** (including but not limited to travel expenses, benefits, overhead, profit, waste, un-acceptable counts, etc.). Multiple and simultaneous purchase orders from the same contracting agency are permissible.

ENTER YOUR PRICE FOR A **SINGLE** COUNT FOR EACH ROADWAY CONFIGURATION AND TIER.

Roadway Configuration		TIER (Number of Counts in Purchase Order)		
		1 to 20	21 to 100	101 to 300
TWO Lane	WITH physical barrier	\$ 890	\$ 890	\$ 890
	WITHOUT physical barrier	\$ 870	\$ 870	\$ 870
FOUR Lane	WITH physical barrier	\$1,900	\$1,900	\$1,900
	WITHOUT physical barrier	\$1,550	\$1,550	\$1,550
SIX Lane	WITH physical barrier	\$2,080	\$2,080	\$2,080
	WITHOUT physical barrier	\$1,680	\$1,680	\$1,680
EIGHT Lane	WITH physical barrier	\$2,250	\$2,250	\$2,250
	WITHOUT physical barrier	\$2,250	\$2,250	\$2,250

**PRICE SHEET for Volume or Class Counts**

DISTRICT: 6-0 TYPE OF COUNTS (Circle) Volume Class SUBMITTER: McMahon Associates,

**NOTE:** A separate Price Sheet must be completed for each District in which you wish to place a bid and for each type of count. Bidders must submit a bid price for every price tier and every roadway configuration below. Any bids not so complete will be determined to be non-responsive. **Prices/Bids are to include ALL costs** (including but not limited to travel expenses, benefits, overhead, profit, waste, un-acceptable counts, etc.). Multiple and simultaneous purchase orders from the same contracting agency are permissible.

ENTER YOUR PRICE FOR A **SINGLE** COUNT FOR EACH ROADWAY CONFIGURATION AND TIER.

Roadway Configuration		TIER (Number of Counts in Purchase Order)		
		1 to 20	21 to 100	101 to 300
TWO Lane	WITH physical barrier	\$ 990	\$ 990	\$ 990
	WITHOUT physical barrier	\$ 990	\$ 990	\$ 990
FOUR Lane	WITH physical barrier	\$2,615	\$2,615	\$2,615
	WITHOUT physical barrier	\$2,085	\$2,085	\$2,085
SIX Lane	WITH physical barrier	\$3,030	\$3,030	\$3,030
	WITHOUT physical barrier	\$2,415	\$2,415	\$2,415
EIGHT Lane	WITH physical barrier	\$3,030	\$3,030	\$3,030
	WITHOUT physical barrier	\$3,030	\$3,030	\$3,030

**PRICE SHEET for Volume or Class Counts**

DISTRICT: 8-0 TYPE OF COUNTS (Circle) Volume Class SUBMITTER: McMahon Associates,

**NOTE:** A separate Price Sheet must be completed for each District in which you wish to place a bid and for each type of count. Bidders must submit a bid price for every price tier and every roadway configuration below. Any bids not so complete will be determined to be non-responsive. **Prices/Bids are to include ALL costs** (including but not limited to travel expenses, benefits, overhead, profit, waste, un-acceptable counts, etc.). Multiple and simultaneous purchase orders from the same contracting agency are permissible.

ENTER YOUR PRICE FOR A **SINGLE** COUNT FOR EACH ROADWAY CONFIGURATION AND TIER.

Roadway Configuration		TIER (Number of Counts in Purchase Order)		
		1 to 20	21 to 100	101 to 300
TWO Lane	WITH physical barrier	\$1,755	\$1,755	\$1,755
	WITHOUT physical barrier	\$1,730	\$1,730	\$1,730
FOUR Lane	WITH physical barrier	\$3,625	\$3,625	\$3,625
	WITHOUT physical barrier	\$2,920	\$2,920	\$2,920
SIX Lane	WITH physical barrier	\$3,800	\$3,800	\$3,800
	WITHOUT physical barrier	\$3,055	\$3,055	\$3,055
EIGHT Lane	WITH physical barrier	\$3,980	\$3,980	\$3,980
	WITHOUT physical barrier	\$3,980	\$3,980	\$3,980

**PRICE SHEET for Volume or Class Counts**DISTRICT: 8-0 TYPE OF COUNTS (Circle) Volume Class SUBMITTER: McMahon Associates,

**NOTE:** A separate Price Sheet must be completed for each District in which you wish to place a bid and for each type of count. Bidders must submit a bid price for every price tier and every roadway configuration below. Any bids not so complete will be determined to be non-responsive. **Prices/Bids are to include ALL costs** (including but not limited to travel expenses, benefits, overhead, profit, waste, un-acceptable counts, etc.). Multiple and simultaneous purchase orders from the same contracting agency are permissible.

ENTER YOUR PRICE FOR A **SINGLE** COUNT FOR EACH ROADWAY CONFIGURATION AND TIER.

Roadway Configuration		TIER (Number of Counts in Purchase Order)		
		1 to 20	21 to 100	101 to 300
TWO Lane	WITH physical barrier	\$1,850	\$1,850	\$1,850
	WITHOUT physical barrier	\$1,850	\$1,850	\$1,850
FOUR Lane	WITH physical barrier	\$4,340	\$4,340	\$4,340
	WITHOUT physical barrier	\$3,460	\$3,460	\$3,460
SIX Lane	WITH physical barrier	\$4,755	\$4,755	\$4,755
	WITHOUT physical barrier	\$3,785	\$3,785	\$3,785
EIGHT Lane	WITH physical barrier	\$4,755	\$4,755	\$4,755
	WITHOUT physical barrier	\$4,755	\$4,755	\$4,755

**PRICE SHEET for Manual Counts**SUBMITTER: COMPUTERIZED TRAFFIC DATA, INC**NOTE:** Enter a price only in the District(s) in which you are willing to take manual counts; prices may vary by District.**Prices/Bids are to include ALL costs** (including but not limited to travel expenses, benefits, overhead, profit, waste, un-acceptable counts, etc.).

District	Hourly price per person
1	\$ 60.00
2	\$ 55.00
3	\$ 55.00
4	\$ 60.00
5	\$ 55.00
6	\$ 75.00
8	\$ 50.00
9	\$ 50.00
10	\$ 55.00
11	\$ 75.00
12	\$ 50.00

COMPUTERIZED TRAFFIC DATA, INC.  
 14444 Beach Blvd., Suite 18-332  
 Jacksonville, FL 32250

**PRICE SHEET for Volume or Class Counts**

DISTRICT: 1 TYPE OF COUNTS (Circle) Volume Class SUBMITTER: \_\_\_\_\_

**NOTE:** A separate Price Sheet must be completed for each District in which you wish to place a bid and for each type of count. Bidders must submit a bid price for every price tier and every roadway configuration below. Any bids not so complete will be determined to be non-responsive. Prices/Bids are to include ALL costs (including but not limited to travel expenses, benefits, overhead, profit, waste, un-acceptable counts, etc.). Multiple and simultaneous purchase orders from the same contracting agency are permissible.

ENTER YOUR PRICE FOR A **SINGLE** COUNT FOR EACH ROADWAY CONFIGURATION AND TIER.

Roadway Configuration		TIER (Number of Counts in Purchase Order)		
		1 to 20	21 to 100	101 to 300
TWO Lane	WITH physical barrier	\$ 150.00	\$ 135.00	\$ 120.00
	WITHOUT physical barrier	\$ 150.00	\$ 135.00	\$ 120.00
FOUR Lane	WITH physical barrier	\$ 170.00	\$ 155.00	\$ 155.00
	WITHOUT physical barrier	\$ 208.00	\$ 193.00	\$ 193.00
SIX Lane	WITH physical barrier	\$ 185.00	\$ 170.00	\$ 170.00
	WITHOUT physical barrier	\$ 215.00	\$ 200.00	\$ 200.00
EIGHT Lane	WITH physical barrier	\$ 395.00	\$ 380.00	\$ 380.00
	WITHOUT physical barrier	\$ 642.00	\$ 580.00	\$ 580.00



COMPUTERIZED TRAFFIC DATA, I  
 14444 Beach Blvd., Suite 18-332  
 Jacksonville, FL 32250

**PRICE SHEET for Volume or Class Counts**

DISTRICT: 2 TYPE OF COUNTS (Circle) Volume Class SUBMITTER: \_\_\_\_\_

**NOTE:** A separate Price Sheet must be completed for each District in which you wish to place a bid and for each type of count. Bidders must submit a bid price for every price tier and every roadway configuration below. Any bids not so complete will be determined to be non-responsive. **Prices/Bids are to include ALL costs** (including but not limited to travel expenses, benefits, overhead, profit, waste, un-acceptable counts, etc.). Multiple and simultaneous purchase orders from the same contracting agency are permissible.

ENTER YOUR PRICE FOR A **SINGLE** COUNT FOR EACH ROADWAY CONFIGURATION AND TIER.

Roadway Configuration		TIER (Number of Counts in Purchase Order)		
		1 to 20	21 to 100	101 to 300
TWO Lane	WITH physical barrier	\$140.00	\$125.00	\$110.00
	WITHOUT physical barrier	\$140.00	\$125.00	\$110.00
FOUR Lane	WITH physical barrier	\$160.00	\$145.00	\$145.00
	WITHOUT physical barrier	\$198.00	\$183.00	\$183.00
SIX Lane	WITH physical barrier	\$175.00	\$160.00	\$160.00
	WITHOUT physical barrier	\$205.00	\$190.00	\$190.00
EIGHT Lane	WITH physical barrier	\$385.00	\$370.00	\$370.00
	WITHOUT physical barrier	\$632.00	\$570.00	\$570.00

COMPUTERIZED TRAFFIC DATA, II  
14444 Beach Blvd., Suite 18-332  
Jacksonville, FL 32250

## PRICE SHEET for Volume or Class Counts

DISTRICT: 2 TYPE OF COUNTS (Circle) Volume Class SUBMITTER: \_\_\_\_\_

**NOTE:** A separate Price Sheet must be completed for each District in which you wish to place a bid and for each type of count. Bidders must submit a bid price for every price tier and every roadway configuration below. Any bids not so complete will be determined to be non-responsive. **Prices/Bids are to include ALL costs** (including but not limited to travel expenses, benefits, overhead, profit, waste, un-acceptable counts, etc.). Multiple and simultaneous purchase orders from the same contracting agency are permissible.

ENTER YOUR PRICE FOR A **SINGLE** COUNT FOR EACH ROADWAY CONFIGURATION AND TIER.

Roadway Configuration		TIER (Number of Counts in Purchase Order)		
		1 to 20	21 to 100	101 to 300
TWO Lane	WITH physical barrier	\$240.00	\$210.00	\$180.00
	WITHOUT physical barrier	\$240.00	\$210.00	\$180.00
FOUR Lane	WITH physical barrier	\$380.00	\$350.00	\$350.00
	WITHOUT physical barrier	\$414.00	\$384.00	\$384.00
SIX Lane	WITH physical barrier	\$644.00	\$584.00	\$554.00
	WITHOUT physical barrier	\$893.00	\$778.00	\$663.00
EIGHT Lane	WITH physical barrier	\$1022.00	\$890.00	\$758.00
	WITHOUT physical barrier	\$2034.00	\$1770.00	\$1506.00

COMPUTERIZED TRAFFIC DATA, II  
14444 Beach Blvd., Suite 18-332  
Jacksonville, FL 32250

## PRICE SHEET for Volume or Class Counts

DISTRICT: 3 TYPE OF COUNTS (Circle) Volume Class SUBMITTER: \_\_\_\_\_

**NOTE:** A separate Price Sheet must be completed for each District in which you wish to place a bid and for each type of count. Bidders must submit a bid price for every price tier and every roadway configuration below. Any bids not so complete will be determined to be non-responsive. **Prices/Bids are to include ALL costs** (including but not limited to travel expenses, benefits, overhead, profit, waste, un-acceptable counts, etc.). Multiple and simultaneous purchase orders from the same contracting agency are permissible.

ENTER YOUR PRICE FOR A **SINGLE** COUNT FOR EACH ROADWAY CONFIGURATION AND TIER.

Roadway Configuration		TIER (Number of Counts in Purchase Order)		
		1 to 20	21 to 100	101 to 300
TWO Lane	WITH physical barrier	\$140.00	\$125.00	\$110.00
	WITHOUT physical barrier	\$140.00	\$125.00	\$110.00
FOUR Lane	WITH physical barrier	\$160.00	\$145.00	\$145.00
	WITHOUT physical barrier	\$198.00	\$183.00	\$183.00
SIX Lane	WITH physical barrier	\$175.00	\$160.00	\$160.00
	WITHOUT physical barrier	\$205.00	\$190.00	\$190.00
EIGHT Lane	WITH physical barrier	\$385.00	\$370.00	\$370.00
	WITHOUT physical barrier	\$632.00	\$570.00	\$570.00

COMPUTERIZED TRAFFIC DATA, I  
 14444 Beach Blvd., Suite 18-332  
 Jacksonville, FL 32250

**PRICE SHEET for Volume or Class Counts**

DISTRICT: 3 TYPE OF COUNTS (Circle) Volume Class SUBMITTER: \_\_\_\_\_

**NOTE:** A separate Price Sheet must be completed for each District in which you wish to place a bid and for each type of count. Bidders must submit a bid price for every price tier and every roadway configuration below. Any bids not so complete will be determined to be non-responsive. **Prices/Bids are to include ALL costs** (including but not limited to travel expenses, benefits, overhead, profit, waste, un-acceptable counts, etc.). Multiple and simultaneous purchase orders from the same contracting agency are permissible.

ENTER YOUR PRICE FOR A **SINGLE** COUNT FOR EACH ROADWAY CONFIGURATION AND TIER.

Roadway Configuration		TIER (Number of Counts in Purchase Order)		
		1 to 20	21 to 100	101 to 300
TWO Lane	WITH physical barrier	\$240.00	\$210.00	\$180.00
	WITHOUT physical barrier	\$240.00	\$210.00	\$180.00
FOUR Lane	WITH physical barrier	\$380.00	\$350.00	\$350.00
	WITHOUT physical barrier	\$414.00	\$384.00	\$384.00
SIX Lane	WITH physical barrier	\$644.00	\$584.00	\$554.00
	WITHOUT physical barrier	\$893.00	\$778.00	\$663.00
EIGHT Lane	WITH physical barrier	\$1022.00	\$890.00	\$758.00
	WITHOUT physical barrier	\$2034.00	\$1770.00	\$1506.00

COMPUTERIZED TRAFFIC DATA, I  
 1444 Beach Blvd., Suite 18-332  
 Jacksonville, FL 32250

**PRICE SHEET for Volume or Class Counts**

DISTRICT: 4 TYPE OF COUNTS (Circle) Volume Class SUBMITTER: \_\_\_\_\_

**NOTE:** A separate Price Sheet must be completed for each District in which you wish to place a bid and for each type of count. Bidders must submit a bid price for every price tier and every roadway configuration below. Any bids not so complete will be determined to be non-responsive. **Prices/Bids are to include ALL costs** (including but not limited to travel expenses, benefits, overhead, profit, waste, un-acceptable counts, etc.). Multiple and simultaneous purchase orders from the same contracting agency are permissible.

ENTER YOUR PRICE FOR A **SINGLE** COUNT FOR EACH ROADWAY CONFIGURATION AND TIER.

Roadway Configuration		TIER (Number of Counts in Purchase Order)		
		1 to 20	21 to 100	101 to 300
TWO Lane	WITH physical barrier	\$ 150.00	\$ 135.00	\$ 120.00
	WITHOUT physical barrier	\$ 150.00	\$ 135.00	\$ 120.00
FOUR Lane	WITH physical barrier	\$ 170.00	\$ 155.00	\$ 155.00
	WITHOUT physical barrier	\$ 208.00	\$ 193.00	\$ 193.00
SIX Lane	WITH physical barrier	\$ 185.00	\$ 170.00	\$ 170.00
	WITHOUT physical barrier	\$ 215.00	\$ 200.00	\$ 200.00
EIGHT Lane	WITH physical barrier	\$ 395.00	\$ 380.00	\$ 380.00
	WITHOUT physical barrier	\$ 642.00	\$ 580.00	\$ 580.00

COMPUTERIZED TRAFFIC DATA, II  
 14444 Beach Blvd., Suite 18-332  
 Jacksonville, FL 32250

**PRICE SHEET for Volume or Class Counts**

DISTRICT: 4 TYPE OF COUNTS (Circle) Volume Class SUBMITTER: \_\_\_\_\_

**NOTE:** A separate Price Sheet must be completed for each District in which you wish to place a bid and for each type of count. Bidders must submit a bid price for every price tier and every roadway configuration below. Any bids not so complete will be determined to be non-responsive. **Prices/Bids are to include ALL costs** (including but not limited to travel expenses, benefits, overhead, profit, waste, un-acceptable counts, etc.). Multiple and simultaneous purchase orders from the same contracting agency are permissible.

ENTER YOUR PRICE FOR A **SINGLE** COUNT FOR EACH ROADWAY CONFIGURATION AND TIER.

Roadway Configuration		TIER (Number of Counts in Purchase Order)		
		1 to 20	21 to 100	101 to 300
TWO Lane	WITH physical barrier	\$ 250.00	\$ 220.00	\$ 190.00
	WITHOUT physical barrier	\$ 250.00	\$ 220.00	\$ 190.00
FOUR Lane	WITH physical barrier	\$ 390.00	\$ 360.00	\$ 360.00
	WITHOUT physical barrier	\$ 424.00	\$ 394.00	\$ 394.00
SIX Lane	WITH physical barrier	\$ 654.00	\$ 594.00	\$ 564.00
	WITHOUT physical barrier	\$ 903.00	\$ 788.00	\$ 673.00
EIGHT Lane	WITH physical barrier	\$ 1032.00	\$ 900.00	\$ 768.00
	WITHOUT physical barrier	\$ 2044.00	\$ 1780.00	\$ 1516.00

COMPUTERIZED TRAFFIC DATA, I  
14444 Beach Blvd., Suite 18-332  
Jacksonville, FL 32250

## PRICE SHEET for Volume or Class Counts

DISTRICT: 5 TYPE OF COUNTS (Circle) Volume Class SUBMITTER: \_\_\_\_\_

**NOTE:** A separate Price Sheet must be completed for each District in which you wish to place a bid and for each type of count. Bidders must submit a bid price for every price tier and every roadway configuration below. Any bids not so complete will be determined to be non-responsive. **Prices/Bids are to include ALL costs** (including but not limited to travel expenses, benefits, overhead, profit, waste, un-acceptable counts, etc.). Multiple and simultaneous purchase orders from the same contracting agency are permissible.

ENTER YOUR PRICE FOR A **SINGLE** COUNT FOR EACH ROADWAY CONFIGURATION AND TIER.

Roadway Configuration		TIER (Number of Counts in Purchase Order)		
		1 to 20	21 to 100	101 to 300
TWO Lane	WITH physical barrier	\$140.00	\$125.00	\$110.00
	WITHOUT physical barrier	\$140.00	\$125.00	\$110.00
FOUR Lane	WITH physical barrier	\$160.00	\$145.00	\$145.00
	WITHOUT physical barrier	\$198.00	\$183.00	\$183.00
SIX Lane	WITH physical barrier	\$175.00	\$160.00	\$160.00
	WITHOUT physical barrier	\$205.00	\$190.00	\$190.00
EIGHT Lane	WITH physical barrier	\$385.00	\$370.00	\$370.00
	WITHOUT physical barrier	\$632.00	\$570.00	\$570.00

COMPUTERIZED TRAFFIC DATA, II  
 14444 Beach Blvd., Suite 18-332  
 Jacksonville, FL 32250

**PRICE SHEET for Volume or Class Counts**

DISTRICT: 5 TYPE OF COUNTS (Circle) Volume Class SUBMITTER: \_\_\_\_\_

**NOTE:** A separate Price Sheet must be completed for each District in which you wish to place a bid and for each type of count. Bidders must submit a bid price for every price tier and every roadway configuration below. Any bids not so complete will be determined to be non-responsive. Prices/Bids are to include ALL costs (including but not limited to travel expenses, benefits, overhead, profit, waste, un-acceptable counts, etc.). Multiple and simultaneous purchase orders from the same contracting agency are permissible.

ENTER YOUR PRICE FOR A **SINGLE** COUNT FOR EACH ROADWAY CONFIGURATION AND TIER.

Roadway Configuration		TIER (Number of Counts in Purchase Order)		
		1 to 20	21 to 100	101 to 300
TWO Lane	WITH physical barrier	\$240.00	\$210.00	\$180.00
	WITHOUT physical barrier	\$240.00	\$210.00	\$180.00
FOUR Lane	WITH physical barrier	\$380.00	\$350.00	\$350.00
	WITHOUT physical barrier	\$414.00	\$384.00	\$384.00
SIX Lane	WITH physical barrier	\$644.00	\$584.00	\$554.00
	WITHOUT physical barrier	\$893.00	\$778.00	\$663.00
EIGHT Lane	WITH physical barrier	\$1022.00	\$890.00	\$758.00
	WITHOUT physical barrier	\$2034.00	\$1770.00	\$1506.00

COMPUTERIZED TRAFFIC DATA,  
14444 Beach Blvd., Suite 18-332  
Jacksonville, FL 32250

**PRICE SHEET for Volume or Class Counts**

DISTRICT: 8 TYPE OF COUNTS (Circle) Volume Class SUBMITTER: \_\_\_\_\_

**NOTE:** A separate Price Sheet must be completed for each District in which you wish to place a bid and for each type of count. Bidders must submit a bid price for every price tier and every roadway configuration below. Any bids not so complete will be determined to be non-responsive. **Prices/Bids are to include ALL costs** (including but not limited to travel expenses, benefits, overhead, profit, waste, un-acceptable counts, etc.). Multiple and simultaneous purchase orders from the same contracting agency are permissible.

ENTER YOUR PRICE FOR A **SINGLE** COUNT FOR EACH ROADWAY CONFIGURATION AND TIER.

Roadway Configuration		TIER (Number of Counts in Purchase Order)		
		1 to 20	21 to 100	101 to 300
TWO Lane	WITH physical barrier	\$ 130.00	\$ 115.00	\$ 100.00
	WITHOUT physical barrier	\$ 130.00	\$ 115.00	\$ 100.00
FOUR Lane	WITH physical barrier	\$ 150.00	\$ 135.00	\$ 135.00
	WITHOUT physical barrier	\$ 188.00	\$ 173.00	\$ 173.00
SIX Lane	WITH physical barrier	\$ 165.00	\$ 150.00	\$ 150.00
	WITHOUT physical barrier	\$ 195.00	\$ 180.00	\$ 180.00
EIGHT Lane	WITH physical barrier	\$ 375.00	\$ 360.00	\$ 360.00
	WITHOUT physical barrier	\$ 622.00	\$ 560.00	\$ 560.00

COMPUTERIZED TRAFFIC DATA  
14444 Beach Blvd., Suite 18-332  
Jacksonville, FL 32250

## PRICE SHEET for Volume or Class Counts

DISTRICT: 8 TYPE OF COUNTS (Circle) Volume (Class) SUBMITTER: \_\_\_\_\_

**NOTE:** A separate Price Sheet must be completed for each District in which you wish to place a bid and for each type of count. Bidders must submit a bid price for every price tier and every roadway configuration below. Any bids not so complete will be determined to be non-responsive. **Prices/Bids are to include ALL costs** (including but not limited to travel expenses, benefits, overhead, profit, waste, un-acceptable counts, etc.). Multiple and simultaneous purchase orders from the same contracting agency are permissible.

ENTER YOUR PRICE FOR A SINGLE COUNT FOR EACH ROADWAY CONFIGURATION AND TIER.

Roadway Configuration		TIER (Number of Counts in Purchase Order)		
		1 to 20	21 to 100	101 to 300
TWO Lane	WITH physical barrier	\$230.00	\$200.00	\$170.00
	WITHOUT physical barrier	\$230.00	\$200.00	\$170.00
FOUR Lane	WITH physical barrier	\$370.00	\$340.00	\$340.00
	WITHOUT physical barrier	\$404.00	\$374.00	\$374.00
SIX Lane	WITH physical barrier	\$634.00	\$574.00	\$544.00
	WITHOUT physical barrier	\$883.00	\$768.00	\$653.00
EIGHT Lane	WITH physical barrier	\$1012.00	\$880.00	\$748.00
	WITHOUT physical barrier	\$2024.00	\$1760.00	\$1496.00

COMPUTERIZED TRAFFIC DATA  
 1444 Beach Blvd., Suite 18-332  
 Jacksonville, FL 32250

**PRICE SHEET for Volume or Class Counts**

DISTRICT: 9 TYPE OF COUNTS (Circle) Volume Class SUBMITTER: \_\_\_\_\_

**NOTE:** A separate Price Sheet must be completed for each District in which you wish to place a bid and for each type of count. Bidders must submit a bid price for every price tier and every roadway configuration below. Any bids not so complete will be determined to be non-responsive. Prices/Bids are to include ALL costs (including but not limited to travel expenses, benefits, overhead, profit, waste, un-acceptable counts, etc.). Multiple and simultaneous purchase orders from the same contracting agency are permissible.

ENTER YOUR PRICE FOR A SINGLE COUNT FOR EACH ROADWAY CONFIGURATION AND TIER.

Roadway Configuration		TIER (Number of Counts in Purchase Order)		
		1 to 20	21 to 100	101 to 300
TWO Lane	WITH physical barrier	\$ 130.00	\$ 115.00	\$ 100.00
	WITHOUT physical barrier	\$ 130.00	\$ 115.00	\$ 100.00
FOUR Lane	WITH physical barrier	\$ 150.00	\$ 135.00	\$ 135.00
	WITHOUT physical barrier	\$ 188.00	\$ 173.00	\$ 173.00
SIX Lane	WITH physical barrier	\$ 165.00	\$ 150.00	\$ 150.00
	WITHOUT physical barrier	\$ 195.00	\$ 180.00	\$ 180.00
EIGHT Lane	WITH physical barrier	\$ 375.00	\$ 360.00	\$ 360.00
	WITHOUT physical barrier	\$ 622.00	\$ 560.00	\$ 560.00

COMPUTERIZED TRAFFIC DATA  
 14444 Beach Blvd., Suite 18-332  
 Jacksonville, FL 32250

**PRICE SHEET for Volume or Class Counts**

DISTRICT: 9 TYPE OF COUNTS (Circle) Volume Class SUBMITTER: \_\_\_\_\_

**NOTE:** A separate Price Sheet must be completed for each District in which you wish to place a bid and for each type of count. Bidders must submit a bid price for every price tier and every roadway configuration below. Any bids not so complete will be determined to be non-responsive. Prices/Bids are to include ALL costs (including but not limited to travel expenses, benefits, overhead, profit, waste, un-acceptable counts, etc.). Multiple and simultaneous purchase orders from the same contracting agency are permissible.

ENTER YOUR PRICE FOR A SINGLE COUNT FOR EACH ROADWAY CONFIGURATION AND TIER.

Roadway Configuration		TIER (Number of Counts in Purchase Order)		
		1 to 20	21 to 100	101 to 300
TWO Lane	WITH physical barrier	\$230.00	\$200.00	\$170.00
	WITHOUT physical barrier	\$230.00	\$200.00	\$170.00
FOUR Lane	WITH physical barrier	\$370.00	\$340.00	\$340.00
	WITHOUT physical barrier	\$404.00	\$374.00	\$374.00
SIX Lane	WITH physical barrier	\$634.00	\$574.00	\$544.00
	WITHOUT physical barrier	\$883.00	\$768.00	\$653.00
EIGHT Lane	WITH physical barrier	\$1012.00	\$880.00	\$748.00
	WITHOUT physical barrier	\$2024.00	\$1760.00	\$1496.00

COMPUTERIZED TRAFFIC DATA, II  
14444 Beach Blvd., Suite 18-332  
Jacksonville, FL 32250

## PRICE SHEET for Volume or Class Counts

DISTRICT: 10 TYPE OF COUNTS (Circle) Volume Class SUBMITTER: \_\_\_\_\_

**NOTE:** A separate Price Sheet must be completed for each District in which you wish to place a bid and for each type of count. Bidders must submit a bid price for every price tier and every roadway configuration below. Any bids not so complete will be determined to be non-responsive. **Prices/Bids are to include ALL costs** (including but not limited to travel expenses, benefits, overhead, profit, waste, un-acceptable counts, etc.). Multiple and simultaneous purchase orders from the same contracting agency are permissible.

ENTER YOUR PRICE FOR A **SINGLE** COUNT FOR EACH ROADWAY CONFIGURATION AND TIER.

Roadway Configuration		TIER (Number of Counts in Purchase Order)		
		1 to 20	21 to 100	101 to 300
TWO Lane	WITH physical barrier	\$ 140.00	\$ 125.00	\$ 110.00
	WITHOUT physical barrier	\$ 140.00	\$ 125.00	\$ 110.00
FOUR Lane	WITH physical barrier	\$ 160.00	\$ 145.00	\$ 145.00
	WITHOUT physical barrier	\$ 198.00	\$ 183.00	\$ 183.00
SIX Lane	WITH physical barrier	\$ 175.00	\$ 160.00	\$ 160.00
	WITHOUT physical barrier	\$ 205.00	\$ 190.00	\$ 190.00
EIGHT Lane	WITH physical barrier	\$ 385.00	\$ 370.00	\$ 370.00
	WITHOUT physical barrier	\$ 632.00	\$ 570.00	\$ 570.00

COMPUTERIZED TRAFFIC DATA, II  
 14444 Beach Blvd., Suite 18-332  
 Jacksonville, FL 32250

**PRICE SHEET for Volume or Class Counts**

DISTRICT: 10 TYPE OF COUNTS (Circle) Volume Class SUBMITTER: \_\_\_\_\_

**NOTE:** A separate Price Sheet must be completed for each District in which you wish to place a bid and for each type of count. Bidders must submit a bid price for every price tier and every roadway configuration below. Any bids not so complete will be determined to be non-responsive. Prices/Bids are to include ALL costs (including but not limited to travel expenses, benefits, overhead, profit, waste, un-acceptable counts, etc.). Multiple and simultaneous purchase orders from the same contracting agency are permissible.

ENTER YOUR PRICE FOR A **SINGLE** COUNT FOR EACH ROADWAY CONFIGURATION AND TIER.

Roadway Configuration		TIER (Number of Counts in Purchase Order)		
		1 to 20	21 to 100	101 to 300
TWO Lane	WITH physical barrier	\$240.00	\$210.00	\$180.00
	WITHOUT physical barrier	\$240.00	\$210.00	\$180.00
FOUR Lane	WITH physical barrier	\$380.00	\$350.00	\$350.00
	WITHOUT physical barrier	\$414.00	\$384.00	\$384.00
SIX Lane	WITH physical barrier	\$644.00	\$584.00	\$554.00
	WITHOUT physical barrier	\$893.00	\$778.00	\$663.00
EIGHT Lane	WITH physical barrier	\$1022.00	\$890.00	\$758.00
	WITHOUT physical barrier	\$2034.00	\$1770.00	\$1506.00

COMPUTERIZED TRAFFIC DATA,  
14444 Beach Blvd., Suite 18-332  
Jacksonville, FL 32250

**PRICE SHEET for Volume or Class Counts**

DISTRICT: 12 TYPE OF COUNTS (Circle) Volume Class SUBMITTER: \_\_\_\_\_

**NOTE:** A separate Price Sheet must be completed for each District in which you wish to place a bid and for each type of count. Bidders must submit a bid price for every price tier and every roadway configuration below. Any bids not so complete will be determined to be non-responsive. **Prices/Bids are to include ALL costs** (including but not limited to travel expenses, benefits, overhead, profit, waste, un-acceptable counts, etc.). Multiple and simultaneous purchase orders from the same contracting agency are permissible.

ENTER YOUR PRICE FOR A **SINGLE** COUNT FOR EACH ROADWAY CONFIGURATION AND TIER.

Roadway Configuration		TIER (Number of Counts in Purchase Order)		
		1 to 20	21 to 100	101 to 300
TWO Lane	WITH physical barrier	\$ 130.00	\$ 115.00	\$ 100.00
	WITHOUT physical barrier	\$ 130.00	\$ 115.00	\$ 100.00
FOUR Lane	WITH physical barrier	\$ 150.00	\$ 135.00	\$ 135.00
	WITHOUT physical barrier	\$ 188.00	\$ 173.00	\$ 173.00
SIX Lane	WITH physical barrier	\$ 165.00	\$ 150.00	\$ 150.00
	WITHOUT physical barrier	\$ 195.00	\$ 180.00	\$ 180.00
EIGHT Lane	WITH physical barrier	\$ 375.00	\$ 360.00	\$ 360.00
	WITHOUT physical barrier	\$ 622.00	\$ 560.00	\$ 560.00

COMPUTERIZED TRAFFIC DATA  
 14444 Beach Blvd., Suite 18-332  
 Jacksonville, FL 32250

**PRICE SHEET for Volume or Class Counts**

DISTRICT: 12 TYPE OF COUNTS (Circle) Volume Class SUBMITTER: \_\_\_\_\_

**NOTE:** A separate Price Sheet must be completed for each District in which you wish to place a bid and for each type of count. Bidders must submit a bid price for every price tier and every roadway configuration below. Any bids not so complete will be determined to be non-responsive. **Prices/Bids are to include ALL costs** (including but not limited to travel expenses, benefits, overhead, profit, waste, un-acceptable counts, etc.). Multiple and simultaneous purchase orders from the same contracting agency are permissible.

ENTER YOUR PRICE FOR A **SINGLE** COUNT FOR EACH ROADWAY CONFIGURATION AND TIER.

Roadway Configuration		TIER (Number of Counts in Purchase Order)		
		1 to 20	21 to 100	101 to 300
TWO Lane	WITH physical barrier	\$230.00	\$200.00	\$170.00
	WITHOUT physical barrier	\$230.00	\$200.00	\$170.00
FOUR Lane	WITH physical barrier	\$370.00	\$340.00	\$340.00
	WITHOUT physical barrier	\$404.00	\$374.00	\$374.00
SIX Lane	WITH physical barrier	\$634.00	\$574.00	\$544.00
	WITHOUT physical barrier	\$883.00	\$768.00	\$653.00
EIGHT Lane	WITH physical barrier	\$1012.00	\$880.00	\$748.00
	WITHOUT physical barrier	\$2024.00	\$1760.00	\$1496.00

## PRICE SHEET for Manual Counts

**SUBMITTER:** john j. CLARK & ASSOCIATES

**NOTE:** Enter a price only in the District(s) in which you are willing to take manual counts; prices may vary by District.

**Prices/Bids are to include ALL costs** (including but not limited to travel expenses, benefits, overhead, profit, waste, un-acceptable counts, etc.).

District	Hourly price per person
1	\$125
2	
3	
4	
5	
6	
8	
9	\$110
10	\$110
11	\$80
12	\$110

**PRICE SHEET for Manual Counts****SUBMITTER:** COUNT ELECTRONICS**NOTE:** Enter a price only in the District(s) in which you are willing to take manual counts; prices may vary by District.**Prices/Bids are to include ALL costs** (including but not limited to travel expenses, benefits, overhead, profit, waste, un-acceptable counts, etc.).

District	Hourly price per person
1	\$25.00/HR
2	\$25.00/HR
3	\$30.00/HR
4	\$35.00/HR
5	\$35.00/HR
6	\$35.00/HR
8	\$30.00/HR
9	\$25.00/HR
10	\$25.00/HR
11	\$20.00/HR
12	\$20.00/HR

**PRICE SHEET for Volume or Class Counts**

**DISTRICT:** 1 **TYPE OF COUNTS (Circle)** Volume **Class** **SUBMITTER:** COUNT ELECTRONICS

**NOTE:** A separate Price Sheet must be completed for each District in which you wish to place a bid and for each type of count. Bidders must submit a bid price for every price tier and every roadway configuration below. Any bids not so complete will be determined to be non-responsive. **Prices/Bids are to include ALL costs** (including but not limited to travel expenses, benefits, overhead, profit, waste, un-acceptable counts, etc.). Multiple and simultaneous purchase orders from the same contracting agency are permissible.

**ENTER YOUR PRICE FOR A SINGLE COUNT FOR EACH ROADWAY CONFIGURATION AND TIER.**

Roadway Configuration		TIER (Number of Counts in Purchase Order)		
		1 to 20	21 to 100	101 to 300
TWO Lane	WITH physical barrier	\$ 70.00EA	\$ 65.00EA	\$ 60.00EA
	WITHOUT physical barrier	\$ 65.00EA	\$ 60.00EA	\$ 55.00EA
FOUR Lane	WITH physical barrier	\$115.00EA	\$110.00EA	\$105.00EA
	WITHOUT physical barrier	\$110.00EA	\$105.00EA	\$100.00EA
SIX Lane	WITH physical barrier	\$775.00EA	\$750.00EA	\$725.00EA
	WITHOUT physical barrier	\$775.00EA	\$750.00EA	\$725.00EA
EIGHT Lane	WITH physical barrier	\$925.00EA	\$900.00EA	\$875.00EA
	WITHOUT physical barrier	\$925.00EA	\$900.00EA	\$875.00EA

**PRICE SHEET for Volume or Class Counts**

DISTRICT: 2 TYPE OF COUNTS (Circle) Volume Class SUBMITTER: COUNT ELECTRONICS

**NOTE:** A separate Price Sheet must be completed for each District in which you wish to place a bid and for each type of count. Bidders must submit a bid price for every price tier and every roadway configuration below. Any bids not so complete will be determined to be non-responsive. **Prices/Bids are to include ALL costs** (including but not limited to travel expenses, benefits, overhead, profit, waste, un-acceptable counts, etc.). Multiple and simultaneous purchase orders from the same contracting agency are permissible.

ENTER YOUR PRICE FOR A **SINGLE** COUNT FOR EACH ROADWAY CONFIGURATION AND TIER.

Roadway Configuration		TIER (Number of Counts in Purchase Order)		
		1 to 20	21 to 100	101 to 300
TWO Lane	WITH physical barrier	\$ 75.00EA	\$ 70.00EA	\$ 65.00EA
	WITHOUT physical barrier	\$ 70.00EA	\$ 65.00EA	\$ 60.00EA
FOUR Lane	WITH physical barrier	\$125.00EA	\$120.00EA	\$115.00EA
	WITHOUT physical barrier	\$120.00EA	\$115.00EA	\$110.00EA
SIX Lane	WITH physical barrier	\$800.00EA	\$775.00EA	\$750.00EA
	WITHOUT physical barrier	\$800.00EA	\$775.00EA	\$750.00EA
EIGHT Lane	WITH physical barrier	\$950.00EA	\$925.00EA	\$900.00EA
	WITHOUT physical barrier	\$950.00EA	\$925.00EA	\$900.00EA

**PRICE SHEET for Volume or Class Counts**

DISTRICT: 3 TYPE OF COUNTS (Circle) Volume Class SUBMITTER: COUNT ELECTRONICS

**NOTE:** A separate Price Sheet must be completed for each District in which you wish to place a bid and for each type of count. Bidders must submit a bid price for every price tier and every roadway configuration below. Any bids not so complete will be determined to be non-responsive. **Prices/Bids are to include ALL costs** (including but not limited to travel expenses, benefits, overhead, profit, waste, un-acceptable counts, etc.). Multiple and simultaneous purchase orders from the same contracting agency are permissible.

ENTER YOUR PRICE FOR A **SINGLE** COUNT FOR EACH ROADWAY CONFIGURATION AND TIER.

Roadway Configuration		TIER (Number of Counts in Purchase Order)		
		1 to 20	21 to 100	101 to 300
TWO Lane	WITH physical barrier	\$ 80.00EA	\$ 75.00EA	\$ 70.00EA
	WITHOUT physical barrier	\$ 75.00EA	\$ 70.00EA	\$ 65.00EA
FOUR Lane	WITH physical barrier	\$135.00EA	\$130.00EA	\$125.00EA
	WITHOUT physical barrier	\$130.00EA	\$125.00EA	\$120.00EA
SIX Lane	WITH physical barrier	\$825.00EA	\$800.00EA	\$775.00EA
	WITHOUT physical barrier	\$825.00EA	\$800.00EA	\$775.00EA
EIGHT Lane	WITH physical barrier	\$975.00EA	\$950.00EA	\$925.00EA
	WITHOUT physical barrier	\$975.00EA	\$950.00	\$925.00EA

**PRICE SHEET for Volume or Class Counts**

DISTRICT: 4 TYPE OF COUNTS (Circle) Volume Class SUBMITTER: COUNT ELECTRONICS

**NOTE:** A separate Price Sheet must be completed for each District in which you wish to place a bid and for each type of count. Bidders must submit a bid price for every price tier and every roadway configuration below. Any bids not so complete will be determined to be non-responsive. **Prices/Bids are to include ALL costs** (including but not limited to travel expenses, benefits, overhead, profit, waste, un-acceptable counts, etc.). Multiple and simultaneous purchase orders from the same contracting agency are permissible.

ENTER YOUR PRICE FOR A **SINGLE** COUNT FOR EACH ROADWAY CONFIGURATION AND TIER.

Roadway Configuration		TIER (Number of Counts in Purchase Order)		
		1 to 20	21 to 100	101 to 300
TWO Lane	WITH physical barrier	\$ 85.00EA	\$ 80.00EA	\$ 75.00EA
	WITHOUT physical barrier	\$ 80.00EA	\$ 75.00EA	\$ 70.00EA
FOUR Lane	WITH physical barrier	\$ 145.00EA	\$ 140.00EA	\$ 135.00EA
	WITHOUT physical barrier	\$ 140.00EA	\$ 135.00EA	\$ 130.00EA
SIX Lane	WITH physical barrier	\$ 850.00EA	\$ 825.00EA	\$ 800.00EA
	WITHOUT physical barrier	\$ 850.00EA	\$ 825.00EA	\$ 800.00EA
EIGHT Lane	WITH physical barrier	\$1000.00EA	\$ 975.00EA	\$ 950.00EA
	WITHOUT physical barrier	\$1000.00EA	\$ 975.00EA	\$ 950.00EA

**PRICE SHEET for Volume or Class Counts**

DISTRICT: 5 TYPE OF COUNTS (Circle) Volume Class SUBMITTER: COUNT ELECTRONICS

**NOTE:** A separate Price Sheet must be completed for each District in which you wish to place a bid and for each type of count. Bidders must submit a bid price for every price tier and every roadway configuration below. Any bids not so complete will be determined to be non-responsive. Prices/Bids are to include ALL costs (including but not limited to travel expenses, benefits, overhead, profit, waste, un-acceptable counts, etc.). Multiple and simultaneous purchase orders from the same contracting agency are permissible.

ENTER YOUR PRICE FOR A **SINGLE** COUNT FOR EACH ROADWAY CONFIGURATION AND TIER.

Roadway Configuration		TIER (Number of Counts in Purchase Order)		
		1 to 20	21 to 100	101 to 300
TWO Lane	WITH physical barrier	\$ 85.00EA	\$ 80.00EA	\$ 75.00EA
	WITHOUT physical barrier	\$ 80.00EA	\$ 75.00EA	\$ 70.00EA
FOUR Lane	WITH physical barrier	\$ 145.00EA	\$ 140.00EA	\$ 135.00EA
	WITHOUT physical barrier	\$ 140.00EA	\$ 135.00EA	\$ 130.00EA
SIX Lane	WITH physical barrier	\$ 850.00EA	\$ 825.00EA	\$ 800.00EA
	WITHOUT physical barrier	\$ 850.00EA	\$ 825.00EA	\$ 800.00EA
EIGHT Lane	WITH physical barrier	\$1000.00EA	\$ 975.00EA	\$ 950.00EA
	WITHOUT physical barrier	\$1000.00EA	\$ 975.00EA	\$ 950.00EA

**PRICE SHEET for Volume or Class Counts**

DISTRICT: 6 TYPE OF COUNTS (Circle) Volume Class SUBMITTER: COUNT ELECTRONICS

**NOTE:** A separate Price Sheet must be completed for each District in which you wish to place a bid and for each type of count. Bidders must submit a bid price for every price tier and every roadway configuration below. Any bids not so complete will be determined to be non-responsive. **Prices/Bids are to include ALL costs** (including but not limited to travel expenses, benefits, overhead, profit, waste, un-acceptable counts, etc.). Multiple and simultaneous purchase orders from the same contracting agency are permissible.

ENTER YOUR PRICE FOR A **SINGLE** COUNT FOR EACH ROADWAY CONFIGURATION AND TIER.

Roadway Configuration		TIER (Number of Counts in Purchase Order)		
		1 to 20	21 to 100	101 to 300
TWO Lane	WITH physical barrier	\$ 85.00EA	\$ 80.00EA	\$ 75.00EA
	WITHOUT physical barrier	\$ 80.00EA	\$ 75.00EA	\$ 70.00EA
FOUR Lane	WITH physical barrier	\$ 145.00EA	\$ 140.00EA	\$ 135.00EA
	WITHOUT physical barrier	\$ 140.00EA	\$ 135.00EA	\$ 130.00EA
SIX Lane	WITH physical barrier	\$ 850.00EA	\$ 825.00EA	\$ 800.00EA
	WITHOUT physical barrier	\$ 850.00EA	\$ 825.00EA	\$ 800.00EA
EIGHT Lane	WITH physical barrier	\$1000.00EA	\$ 975.00EA	\$ 950.00EA
	WITHOUT physical barrier	\$1000.00EA	\$ 975.00EA	\$ 950.00EA

**PRICE SHEET for Volume or Class Counts**DISTRICT: 8 TYPE OF COUNTS (Circle) Volume Class SUBMITTER: COUNT ELECTRONICS

**NOTE:** A separate Price Sheet must be completed for each District in which you wish to place a bid and for each type of count. Bidders must submit a bid price for every price tier and every roadway configuration below. Any bids not so complete will be determined to be non-responsive. **Prices/Bids are to include ALL costs** (including but not limited to travel expenses, benefits, overhead, profit, waste, un-acceptable counts, etc.). Multiple and simultaneous purchase orders from the same contracting agency are permissible.

ENTER YOUR PRICE FOR A **SINGLE** COUNT FOR EACH ROADWAY CONFIGURATION AND TIER.

Roadway Configuration		TIER (Number of Counts in Purchase Order)		
		1 to 20	21 to 100	101 to 300
TWO Lane	WITH physical barrier	\$ 80.00EA	\$ 75.00EA	\$ 70.00EA
	WITHOUT physical barrier	\$ 75.00EA	\$ 70.00EA	\$ 65.00EA
FOUR Lane	WITH physical barrier	\$135.00EA	\$130.00EA	\$125.00EA
	WITHOUT physical barrier	\$130.00EA	\$125.00EA	\$120.00EA
SIX Lane	WITH physical barrier	\$825.00EA	\$800.00EA	\$775.00EA
	WITHOUT physical barrier	\$825.00EA	\$800.00EA	\$775.00EA
EIGHT Lane	WITH physical barrier	\$975.00EA	\$950.00EA	\$925.00EA
	WITHOUT physical barrier	\$975.00EA	\$950.00	\$925.00EA

**PRICE SHEET for Volume or Class Counts**

**DISTRICT:** 9 **TYPE OF COUNTS (Circle)** Volume **Class** **SUBMITTER:** COUNT ELECTRONICS

**NOTE:** A separate Price Sheet must be completed for each District in which you wish to place a bid and for each type of count. Bidders must submit a bid price for every price tier and every roadway configuration below. Any bids not so complete will be determined to be non-responsive. **Prices/Bids are to include ALL costs** (including but not limited to travel expenses, benefits, overhead, profit, waste, un-acceptable counts, etc.). Multiple and simultaneous purchase orders from the same contracting agency are permissible.

**ENTER YOUR PRICE FOR A SINGLE COUNT FOR EACH ROADWAY CONFIGURATION AND TIER.**

Roadway Configuration		TIER (Number of Counts in Purchase Order)		
		1 to 20	21 to 100	101 to 300
TWO Lane	WITH physical barrier	\$ 75.00EA	\$ 70.00EA	\$ 65.00EA
	WITHOUT physical barrier	\$ 70.00EA	\$ 65.00EA	\$ 60.00EA
FOUR Lane	WITH physical barrier	\$125.00EA	\$120.00EA	\$115.00EA
	WITHOUT physical barrier	\$120.00EA	\$115.00EA	\$110.00EA
SIX Lane	WITH physical barrier	\$800.00EA	\$775.00EA	\$750.00EA
	WITHOUT physical barrier	\$800.00EA	\$775.00EA	\$750.00EA
EIGHT Lane	WITH physical barrier	\$950.00EA	\$925.00EA	\$900.00EA
	WITHOUT physical barrier	\$950.00EA	\$925.00EA	\$900.00EA

**PRICE SHEET for Volume or Class Counts**

DISTRICT: 10 TYPE OF COUNTS (Circle) Volume Class SUBMITTER: COUNT ELECTRONICS

**NOTE:** A separate Price Sheet must be completed for each District in which you wish to place a bid and for each type of count. Bidders must submit a bid price for every price tier and every roadway configuration below. Any bids not so complete will be determined to be non-responsive. **Prices/Bids are to include ALL costs** (including but not limited to travel expenses, benefits, overhead, profit, waste, un-acceptable counts, etc.). Multiple and simultaneous purchase orders from the same contracting agency are permissible.

ENTER YOUR PRICE FOR A **SINGLE** COUNT FOR EACH ROADWAY CONFIGURATION AND TIER.

Roadway Configuration		TIER (Number of Counts in Purchase Order)		
		1 to 20	21 to 100	101 to 300
TWO Lane	WITH physical barrier	\$ 70.00EA	\$ 65.00EA	\$ 60.00EA
	WITHOUT physical barrier	\$ 65.00EA	\$ 60.00EA	\$ 55.00EA
FOUR Lane	WITH physical barrier	\$115.00EA	\$110.00EA	\$105.00EA
	WITHOUT physical barrier	\$110.00EA	\$105.00EA	\$100.00EA
SIX Lane	WITH physical barrier	\$775.00EA	\$750.00EA	\$725.00EA
	WITHOUT physical barrier	\$775.00EA	\$750.00EA	\$725.00EA
EIGHT Lane	WITH physical barrier	\$925.00EA	\$900.00EA	\$875.00EA
	WITHOUT physical barrier	\$925.00EA	\$900.00EA	\$875.00EA

**PRICE SHEET for Volume or Class Counts**

DISTRICT: 11 TYPE OF COUNTS (Circle) Volume Class SUBMITTER: COUNT ELECTRONICS

**NOTE:** A separate Price Sheet must be completed for each District in which you wish to place a bid and for each type of count. Bidders must submit a bid price for every price tier and every roadway configuration below. Any bids not so complete will be determined to be non-responsive. Prices/Bids are to include ALL costs (including but not limited to travel expenses, benefits, overhead, profit, waste, un-acceptable counts, etc.). Multiple and simultaneous purchase orders from the same contracting agency are permissible.

ENTER YOUR PRICE FOR A **SINGLE** COUNT FOR EACH ROADWAY CONFIGURATION AND TIER.

Roadway Configuration		TIER (Number of Counts in Purchase Order)		
		1 to 20	21 to 100	101 to 300
TWO Lane	WITH physical barrier	\$ 65.00EA	\$ 60.00EA	\$ 55.00EA
	WITHOUT physical barrier	\$ 60.00EA	\$ 55.00EA	\$ 50.00EA
FOUR Lane	WITH physical barrier	\$105.00EA	\$100.00EA	\$ 95.00EA
	WITHOUT physical barrier	\$100.00EA	\$ 95.00EA	\$ 90.00EA
SIX Lane	WITH physical barrier	\$750.00EA	\$725.00EA	\$700.00EA
	WITHOUT physical barrier	\$750.00EA	\$725.00EA	\$700.00EA
EIGHT Lane	WITH physical barrier	\$900.00EA	\$875.00EA	\$850.00EA
	WITHOUT physical barrier	\$900.00EA	\$875.00EA	\$850.00EA

**PRICE SHEET for Volume or Class Counts**DISTRICT: 12 TYPE OF COUNTS (Circle) Volume Class SUBMITTER: COUNT ELECTRONICS

**NOTE:** A separate Price Sheet must be completed for each District in which you wish to place a bid and for each type of count. Bidders must submit a bid price for every price tier and every roadway configuration below. Any bids not so complete will be determined to be non-responsive. **Prices/Bids are to include ALL costs** (including but not limited to travel expenses, benefits, overhead, profit, waste, un-acceptable counts, etc.). Multiple and simultaneous purchase orders from the same contracting agency are permissible.

ENTER YOUR PRICE FOR A **SINGLE** COUNT FOR EACH ROADWAY CONFIGURATION AND TIER.

Roadway Configuration		TIER (Number of Counts in Purchase Order)		
		1 to 20	21 to 100	101 to 300
TWO Lane	WITH physical barrier	\$ 65.00EA	\$ 60.00EA	\$ 55.00EA
	WITHOUT physical barrier	\$ 60.00EA	\$ 55.00EA	\$ 50.00EA
FOUR Lane	WITH physical barrier	\$105.00EA	\$100.00EA	\$ 95.00EA
	WITHOUT physical barrier	\$100.00EA	\$ 95.00EA	\$ 90.00EA
SIX Lane	WITH physical barrier	\$750.00EA	\$725.00EA	\$700.00EA
	WITHOUT physical barrier	\$750.00EA	\$725.00EA	\$700.00EA
EIGHT Lane	WITH physical barrier	\$900.00EA	\$875.00EA	\$850.00EA
	WITHOUT physical barrier	\$900.00EA	\$875.00EA	\$850.00EA

**PRICE SHEET for Manual Counts****SUBMITTER:** GAI Consultants, Inc.**NOTE:** Enter a price only in the District(s) in which you are willing to take manual counts; prices may vary by District.**Prices/Bids are to include ALL costs** (including but not limited to travel expenses, benefits, overhead, profit, waste, un-acceptable counts, etc.).

<b>DISTRICT</b>	<b>Hourly price per person</b>
1	\$100
2	-
3	-
4	-
5	-
6	-
7	-
8	-
9	-
10	\$100
11	\$100
12	\$100

**PRICE SHEET for Volume or Class Counts**

DISTRICT: 1 TYPE OF COUNTS (Circle) Volume Class **SUBMITTER:** GAI Consultants, Inc.

**NOTE:** A separate Price Sheet must be completed for each District in which you wish to place a bid and for each type of count. Bidders must submit a bid price for every price tier and every roadway configuration below. Any bids not so complete will be determined to be non-responsive. **Prices/Bids are to include ALL costs** (including but not limited to travel expenses, benefits, overhead, profit, waste, un-acceptable counts, etc.). Multiple and simultaneous purchase orders from the same contracting agency are permissible.

ENTER YOUR PRICE FOR A **SINGLE** COUNT FOR EACH ROADWAY CONFIGURATION AND TIER.

Roadway Configuration		Tier (Number of Counts in Purchase Order)		
		1 to 20	21 to 100	101 to 300
TWO Lane	WITH physical barrier	\$1,100	\$700	\$700
	WITHOUT physical barrier	\$1,000	\$600	\$520
FOUR Lane	WITH physical barrier	\$1,200	\$800	\$800
	WITHOUT physical barrier	\$1,050	\$650	\$570
SIX Lane	WITH physical barrier	\$1,400	\$1,000	\$1,000
	WITHOUT physical barrier	\$1,100	\$700	\$620
EIGHT Lane	WITH physical barrier	\$1,650	\$1,100	\$1,100
	WITHOUT physical barrier	\$1,150	\$750	\$670

**PRICE SHEET for Volume or Class Counts**DISTRICT: 1 TYPE OF COUNTS (Circle) Volume Class SUBMITTER: GAI Consultants, Inc.

**NOTE:** A separate Price Sheet must be completed for each District in which you wish to place a bid and for each type of count. Bidders must submit a bid price for every price tier and every roadway configuration below. Any bids not so complete will be determined to be non-responsive. **Prices/Bids are to include ALL costs** (including but not limited to travel expenses, benefits, overhead, profit, waste, un-acceptable counts, etc.). Multiple and simultaneous purchase orders from the same contracting agency are permissible.

ENTER YOUR PRICE FOR A **SINGLE** COUNT FOR EACH ROADWAY CONFIGURATION AND TIER.

Roadway Configuration		Tier (Number of Counts in Purchase Order)		
		1 to 20	21 to 100	101 to 300
TWO Lane	WITH physical barrier	\$1,150	\$750	\$750
	WITHOUT physical barrier	\$1,050	\$650	\$570
FOUR Lane	WITH physical barrier	\$1,250	\$850	\$850
	WITHOUT physical barrier	\$1,100	\$700	\$620
SIX Lane	WITH physical barrier	\$1,470	\$1,070	\$1,070
	WITHOUT physical barrier	\$1,150	\$750	\$670
EIGHT Lane	WITH physical barrier	\$1,720	\$1,170	\$1,170
	WITHOUT physical barrier	\$1,200	\$800	\$720

**PRICE SHEET for Volume or Class Counts**

DISTRICT: 10 TYPE OF COUNTS (Circle) Volume Class **SUBMITTER:** GAI Consultants, Inc.

**NOTE:** A separate Price Sheet must be completed for each District in which you wish to place a bid and for each type of count. Bidders must submit a bid price for every price tier and every roadway configuration below. Any bids not so complete will be determined to be non-responsive. **Prices/Bids are to include ALL costs** (including but not limited to travel expenses, benefits, overhead, profit, waste, un-acceptable counts, etc.). Multiple and simultaneous purchase orders from the same contracting agency are permissible.

ENTER YOUR PRICE FOR A **SINGLE** COUNT FOR EACH ROADWAY CONFIGURATION AND TIER.

Roadway Configuration		Tier (Number of Counts in Purchase Order)		
		1 to 20	21 to 100	101 to 300
TWO Lane	WITH physical barrier	\$1,100	\$610	\$610
	WITHOUT physical barrier	\$1,000	\$510	\$510
FOUR Lane	WITH physical barrier	\$1,200	\$710	\$710
	WITHOUT physical barrier	\$1,050	\$560	\$560
SIX Lane	WITH physical barrier	\$1,400	\$810	\$810
	WITHOUT physical barrier	\$1,100	\$610	\$610
EIGHT Lane	WITH physical barrier	\$1,650	\$910	\$910
	WITHOUT physical barrier	\$1,150	\$660	\$660

**PRICE SHEET for Volume or Class Counts**

DISTRICT: 10 TYPE OF COUNTS (Circle) Volume Class SUBMITTER: GAI Consultants, Inc.

**NOTE:** A separate Price Sheet must be completed for each District in which you wish to place a bid and for each type of count. Bidders must submit a bid price for every price tier and every roadway configuration below. Any bids not so complete will be determined to be non-responsive. **Prices/Bids are to include ALL costs** (including but not limited to travel expenses, benefits, overhead, profit, waste, un-acceptable counts, etc.). Multiple and simultaneous purchase orders from the same contracting agency are permissible.

ENTER YOUR PRICE FOR A **SINGLE** COUNT FOR EACH ROADWAY CONFIGURATION AND TIER.

Roadway Configuration		Tier (Number of Counts in Purchase Order)		
		1 to 20	21 to 100	101 to 300
TWO Lane	WITH physical barrier	\$1,150	\$660	\$660
	WITHOUT physical barrier	\$1,050	\$560	\$560
FOUR Lane	WITH physical barrier	\$1,250	\$760	\$760
	WITHOUT physical barrier	\$1,100	\$610	\$610
SIX Lane	WITH physical barrier	\$1,470	\$880	\$880
	WITHOUT physical barrier	\$1,150	\$660	\$660
EIGHT Lane	WITH physical barrier	\$1,720	\$980	\$980
	WITHOUT physical barrier	\$1,200	\$710	\$710

**PRICE SHEET for Volume or Class Counts**

DISTRICT: 11 TYPE OF COUNTS (Circle) Volume Class **SUBMITTER:** GAI Consultants, Inc.

**NOTE:** A separate Price Sheet must be completed for each District in which you wish to place a bid and for each type of count. Bidders must submit a bid price for every price tier and every roadway configuration below. Any bids not so complete will be determined to be non-responsive. **Prices/Bids are to include ALL costs** (including but not limited to travel expenses, benefits, overhead, profit, waste, un-acceptable counts, etc.). Multiple and simultaneous purchase orders from the same contracting agency are permissible.

ENTER YOUR PRICE FOR A **SINGLE** COUNT FOR EACH ROADWAY CONFIGURATION AND TIER.

Roadway Configuration		Tier (Number of Counts in Purchase Order)		
		1 to 20	21 to 100	101 to 300
TWO Lane	WITH physical barrier	\$1,000	\$600	\$600
	WITHOUT physical barrier	\$900	\$500	\$500
FOUR Lane	WITH physical barrier	\$1,100	\$700	\$700
	WITHOUT physical barrier	\$950	\$550	\$550
SIX Lane	WITH physical barrier	\$1,300	\$800	\$800
	WITHOUT physical barrier	\$1,000	\$600	\$600
EIGHT Lane	WITH physical barrier	\$1,550	\$900	\$900
	WITHOUT physical barrier	\$1,050	\$650	\$650

**PRICE SHEET for Volume or Class Counts**

DISTRICT: 11 TYPE OF COUNTS (Circle) Volume Class SUBMITTER: GAI Consultants, Inc.

**NOTE:** A separate Price Sheet must be completed for each District in which you wish to place a bid and for each type of count. Bidders must submit a bid price for every price tier and every roadway configuration below. Any bids not so complete will be determined to be non-responsive. **Prices/Bids are to include ALL costs** (including but not limited to travel expenses, benefits, overhead, profit, waste, un-acceptable counts, etc.). Multiple and simultaneous purchase orders from the same contracting agency are permissible.

ENTER YOUR PRICE FOR A **SINGLE** COUNT FOR EACH ROADWAY CONFIGURATION AND TIER.

Roadway Configuration		Tier (Number of Counts in Purchase Order)		
		1 to 20	21 to 100	101 to 300
TWO Lane	WITH physical barrier	\$1,050	\$650	\$650
	WITHOUT physical barrier	\$950	\$550	\$550
FOUR Lane	WITH physical barrier	\$1,150	\$750	\$750
	WITHOUT physical barrier	\$1,000	\$600	\$600
SIX Lane	WITH physical barrier	\$1,370	\$870	\$870
	WITHOUT physical barrier	\$1,050	\$650	\$650
EIGHT Lane	WITH physical barrier	\$1,620	\$970	\$970
	WITHOUT physical barrier	\$1,100	\$700	\$700

**PRICE SHEET for Volume or Class Counts**

DISTRICT: 12 TYPE OF COUNTS (Circle) Volume Class **SUBMITTER:** GAI Consultants, Inc.

**NOTE:** A separate Price Sheet must be completed for each District in which you wish to place a bid and for each type of count. Bidders must submit a bid price for every price tier and every roadway configuration below. Any bids not so complete will be determined to be non-responsive. **Prices/Bids are to include ALL costs** (including but not limited to travel expenses, benefits, overhead, profit, waste, un-acceptable counts, etc.). Multiple and simultaneous purchase orders from the same contracting agency are permissible.

ENTER YOUR PRICE FOR A **SINGLE** COUNT FOR EACH ROADWAY CONFIGURATION AND TIER.

Roadway Configuration		Tier (Number of Counts in Purchase Order)		
		1 to 20	21 to 100	101 to 300
TWO Lane	WITH physical barrier	\$1,000	\$600	\$600
	WITHOUT physical barrier	\$900	\$500	\$500
FOUR Lane	WITH physical barrier	\$1,100	\$700	\$700
	WITHOUT physical barrier	\$950	\$550	\$550
SIX Lane	WITH physical barrier	\$1,300	\$800	\$800
	WITHOUT physical barrier	\$1,000	\$600	\$600
EIGHT Lane	WITH physical barrier	\$1,550	\$900	\$900
	WITHOUT physical barrier	\$1,050	\$650	\$650

**PRICE SHEET for Volume or Class Counts**

DISTRICT: 12 TYPE OF COUNTS (Circle) Volume Class SUBMITTER: GAI Consultants, Inc.

**NOTE:** A separate Price Sheet must be completed for each District in which you wish to place a bid and for each type of count. Bidders must submit a bid price for every price tier and every roadway configuration below. Any bids not so complete will be determined to be non-responsive. **Prices/Bids are to include ALL costs** (including but not limited to travel expenses, benefits, overhead, profit, waste, un-acceptable counts, etc.). Multiple and simultaneous purchase orders from the same contracting agency are permissible.

ENTER YOUR PRICE FOR A **SINGLE** COUNT FOR EACH ROADWAY CONFIGURATION AND TIER.

Roadway Configuration		Tier (Number of Counts in Purchase Order)		
		1 to 20	21 to 100	101 to 300
TWO Lane	WITH physical barrier	\$1,050	\$650	\$650
	WITHOUT physical barrier	\$950	\$550	\$550
FOUR Lane	WITH physical barrier	\$1,150	\$750	\$750
	WITHOUT physical barrier	\$1,000	\$600	\$600
SIX Lane	WITH physical barrier	\$1,370	\$870	\$870
	WITHOUT physical barrier	\$1,050	\$650	\$650
EIGHT Lane	WITH physical barrier	\$1,620	\$970	\$970
	WITHOUT physical barrier	\$1,100	\$700	\$700

## PRICE SHEET for Manual Counts

SUBMITTER: MCV ASSOCIATES, INC.

NOTE: Enter a price only in the District(s) in which you are willing to take manual counts; prices may vary by District.

**Prices/Bids are to include ALL costs** (including but not limited to travel expenses, benefits, overhead, profit, waste, un-acceptable counts, etc.).

District	Hourly price per person
1	74.38
2	62.99
3	63.66
4	67.01
5	59.48
6	53.51
8	49.74
9	53.97
10	57.44
11	65.43
12	58.42

## PRICE SHEET for Volume or Class Counts

DISTRICT: 1 TYPE OF COUNTS (Circle) Volume Class SUBMITTER: MCV ASSOCIATES, INC.

**NOTE:** A separate Price Sheet must be completed for each District in which you wish to place a bid and for each type of count. Bidders must submit a bid price for every price tier and every roadway configuration below. Any bids not so complete will be determined to be non-responsive. **Prices/Bids are to include ALL costs** (including but not limited to travel expenses, benefits, overhead, profit, waste, un-acceptable counts, etc.). Multiple and simultaneous purchase orders from the same contracting agency are permissible.

**ENTER YOUR PRICE FOR A SINGLE COUNT FOR EACH ROADWAY CONFIGURATION AND TIER.**

Roadway Configuration		TIER (Number of Counts in Purchase Order)		
		1 to 20	21 to 100	101 to 300
TWO Lane	WITH physical barrier	339	295	295
	WITHOUT physical barrier	239	195	195
FOUR Lane	WITH physical barrier	339	295	295
	WITHOUT physical barrier	239	195	195
Six Lane	WITH physical barrier	339	295	295
	WITHOUT physical barrier	339	295	295
EIGHT Lane	WITH physical barrier	339	295	295
	WITHOUT physical barrier	339	295	295

## PRICE SHEET for Volume or Class Counts

DISTRICT:   2   TYPE OF COUNTS (Circle) Volume Class SUBMITTER: MCV ASSOCIATES, INC.

**NOTE:** A separate Price Sheet must be completed for each District in which you wish to place a bid and for each type of count. Bidders must submit a bid price for every price tier and every roadway configuration below. Any bids not so complete will be determined to be non-responsive. **Prices/Bids are to include ALL costs** (including but not limited to travel expenses, benefits, overhead, profit, waste, un-acceptable counts, etc.). Multiple and simultaneous purchase orders from the same contracting agency are permissible.

**ENTER YOUR PRICE FOR A SINGLE COUNT FOR EACH ROADWAY CONFIGURATION AND TIER.**

Roadway Configuration		TIER (Number of Counts in Purchase Order)		
		1 to 20	21 to 100	101 to 300
TWO Lane	WITH physical barrier	316	289	289
	WITHOUT physical barrier	216	189	189
FOUR Lane	WITH physical barrier	316	289	289
	WITHOUT physical barrier	216	189	189
Six Lane	WITH physical barrier	316	289	289
	WITHOUT physical barrier	316	289	289
EIGHT Lane	WITH physical barrier	316	289	289
	WITHOUT physical barrier	316	289	289

## PRICE SHEET for Volume or Class Counts

DISTRICT: 3 TYPE OF COUNTS (Circle) Volume Class SUBMITTER: MCV ASSOCIATES, INC.

**NOTE:** A separate Price Sheet must be completed for each District in which you wish to place a bid and for each type of count. Bidders must submit a bid price for every price tier and every roadway configuration below. Any bids not so complete will be determined to be non-responsive. **Prices/Bids are to include ALL costs** (including but not limited to travel expenses, benefits, overhead, profit, waste, un-acceptable counts, etc.). Multiple and simultaneous purchase orders from the same contracting agency are permissible.

ENTER YOUR PRICE FOR A SINGLE COUNT FOR EACH ROADWAY CONFIGURATION AND TIER.

Roadway Configuration		TIER (Number of Counts in Purchase Order)		
		1 to 20	21 to 100	101 to 300
TWO Lane	WITH physical barrier	316	289	289
	WITHOUT physical barrier	216	189	189
FOUR Lane	WITH physical barrier	316	289	289
	WITHOUT physical barrier	216	189	189
Six Lane	WITH physical barrier	316	289	289
	WITHOUT physical barrier	316	289	289
EIGHT Lane	WITH physical barrier	316	289	289
	WITHOUT physical barrier	316	289	289

PRICE SHEET for Volume or Class CountsDISTRICT: 4 TYPE OF COUNTS (Circle) Volume Class SUBMITTER: MCV ASSOCIATES, INC.

**NOTE:** A separate Price Sheet must be completed for each District in which you wish to place a bid and for each type of count. Bidders must submit a bid price for every price tier and every roadway configuration below. Any bids not so complete will be determined to be non-responsive. **Prices/Bids are to include ALL costs** (including but not limited to travel expenses, benefits, overhead, profit, waste, un-acceptable counts, etc.). Multiple and simultaneous purchase orders from the same contracting agency are permissible.

ENTER YOUR PRICE FOR A SINGLE COUNT FOR EACH ROADWAY CONFIGURATION AND TIER.

Roadway Configuration		TIER (Number of Counts in Purchase Order)		
		1 to 20	21 to 100	101 to 300
TWO Lane	WITH physical barrier	316	289	289
	WITHOUT physical barrier	216	189	189
FOUR Lane	WITH physical barrier	316	289	289
	WITHOUT physical barrier	216	189	189
Six Lane	WITH physical barrier	316	289	289
	WITHOUT physical barrier	316	289	289
EIGHT Lane	WITH physical barrier	316	289	289
	WITHOUT physical barrier	316	289	289

## PRICE SHEET for Volume or Class Counts

DISTRICT: 5 TYPE OF COUNTS (Circle) Volume Class SUBMITTER: MCV ASSOCIATES, INC.

**NOTE:** A separate Price Sheet must be completed for each District in which you wish to place a bid and for each type of count. Bidders must submit a bid price for every price tier and every roadway configuration below. Any bids not so complete will be determined to be non-responsive. **Prices/Bids are to include ALL costs** (including but not limited to travel expenses, benefits, overhead, profit, waste, un-acceptable counts, etc.). Multiple and simultaneous purchase orders from the same contracting agency are permissible.

**ENTER YOUR PRICE FOR A SINGLE COUNT FOR EACH ROADWAY CONFIGURATION AND TIER.**

Roadway Configuration		TIER (Number of Counts in Purchase Order)		
		1 to 20	21 to 100	101 to 300
TWO Lane	WITH physical barrier	309	285	285
	WITHOUT physical barrier	209	185	185
FOUR Lane	WITH physical barrier	309	285	285
	WITHOUT physical barrier	209	185	185
Six Lane	WITH physical barrier	309	285	285
	WITHOUT physical barrier	309	285	285
EIGHT Lane	WITH physical barrier	309	285	285
	WITHOUT physical barrier	309	285	285

PRICE SHEET for Volume or Class CountsDISTRICT: 6 TYPE OF COUNTS (Circle) Volume Class SUBMITTER: MCV ASSOCIATES, INC.

**NOTE:** A separate Price Sheet must be completed for each District in which you wish to place a bid and for each type of count. Bidders must submit a bid price for every price tier and every roadway configuration below. Any bids not so complete will be determined to be non-responsive. **Prices/Bids are to include ALL costs** (including but not limited to travel expenses, benefits, overhead, profit, waste, un-acceptable counts, etc.). Multiple and simultaneous purchase orders from the same contracting agency are permissible.

ENTER YOUR PRICE FOR A SINGLE COUNT FOR EACH ROADWAY CONFIGURATION AND TIER.

Roadway Configuration		TIER (Number of Counts in Purchase Order)		
		1 to 20	21 to 100	101 to 300
TWO Lane	WITH physical barrier	299	279	279
	WITHOUT physical barrier	199	179	179
FOUR Lane	WITH physical barrier	299	279	279
	WITHOUT physical barrier	199	179	179
Six Lane	WITH physical barrier	299	279	279
	WITHOUT physical barrier	299	279	279
EIGHT Lane	WITH physical barrier	299	279	279
	WITHOUT physical barrier	299	279	279

## PRICE SHEET for Volume or Class Counts

DISTRICT: 8 TYPE OF COUNTS (Circle) (Volume) Class SUBMITTER: MCV ASSOCIATES, INC.

**NOTE:** A separate Price Sheet must be completed for each District in which you wish to place a bid and for each type of count. Bidders must submit a bid price for every price tier and every roadway configuration below. Any bids not so complete will be determined to be non-responsive. **Prices/Bids are to include ALL costs** (including but not limited to travel expenses, benefits, overhead, profit, waste, un-acceptable counts, etc.). Multiple and simultaneous purchase orders from the same contracting agency are permissible.

ENTER YOUR PRICE FOR A SINGLE COUNT FOR EACH ROADWAY CONFIGURATION AND TIER.

Roadway Configuration		TIER (Number of Counts in Purchase Order)		
		1 to 20	21 to 100	101 to 300
TWO Lane	WITH physical barrier	299	279	279
	WITHOUT physical barrier	199	179	179
FOUR Lane	WITH physical barrier	299	279	279
	WITHOUT physical barrier	199	179	179
Six Lane	WITH physical barrier	299	279	279
	WITHOUT physical barrier	299	279	279
EIGHT Lane	WITH physical barrier	299	279	279
	WITHOUT physical barrier	299	279	279

## PRICE SHEET for Volume or Class Counts

DISTRICT: 9 TYPE OF COUNTS (Circle) Volume Class SUBMITTER: MCV ASSOCIATES, INC.

**NOTE:** A separate Price Sheet must be completed for each District in which you wish to place a bid and for each type of count. Bidders must submit a bid price for every price tier and every roadway configuration below. Any bids not so complete will be determined to be non-responsive. **Prices/Bids are to include ALL costs** (including but not limited to travel expenses, benefits, overhead, profit, waste, un-acceptable counts, etc.). Multiple and simultaneous purchase orders from the same contracting agency are permissible.

ENTER YOUR PRICE FOR A SINGLE COUNT FOR EACH ROADWAY CONFIGURATION AND TIER.

Roadway Configuration		TIER (Number of Counts in Purchase Order)		
		1 to 20	21 to 100	101 to 300
TWO Lane	WITH physical barrier	299	279	279
	WITHOUT physical barrier	199	179	179
FOUR Lane	WITH physical barrier	299	279	279
	WITHOUT physical barrier	199	179	179
Six Lane	WITH physical barrier	299	279	279
	WITHOUT physical barrier	299	279	279
EIGHT Lane	WITH physical barrier	299	279	279
	WITHOUT physical barrier	299	279	279

PRICE SHEET for Volume or Class CountsDISTRICT: 10 TYPE OF COUNTS (Circle) Volume Class SUBMITTER: MCV ASSOCIATES, INC.

**NOTE:** A separate Price Sheet must be completed for each District in which you wish to place a bid and for each type of count. Bidders must submit a bid price for every price tier and every roadway configuration below. Any bids not so complete will be determined to be non-responsive. **Prices/Bids are to include ALL costs** (including but not limited to travel expenses, benefits, overhead, profit, waste, un-acceptable counts, etc.). Multiple and simultaneous purchase orders from the same contracting agency are permissible.

ENTER YOUR PRICE FOR A SINGLE COUNT FOR EACH ROADWAY CONFIGURATION AND TIER.

Roadway Configuration		TIER (Number of Counts in Purchase Order)		
		1 to 20	21 to 100	101 to 300
TWO Lane	WITH physical barrier	299	279	279
	WITHOUT physical barrier	199	179	179
FOUR Lane	WITH physical barrier	299	279	279
	WITHOUT physical barrier	199	179	179
Six Lane	WITH physical barrier	299	279	279
	WITHOUT physical barrier	299	279	279
EIGHT Lane	WITH physical barrier	299	279	279
	WITHOUT physical barrier	299	279	279

**PRICE SHEET for Volume or Class Counts**

DISTRICT: 11 TYPE OF COUNTS (Circle) Volume Class SUBMITTER: MCV ASSOCIATES, INC.

**NOTE:** A separate Price Sheet must be completed for each District in which you wish to place a bid and for each type of count. Bidders must submit a bid price for every price tier and every roadway configuration below. Any bids not so complete will be determined to be non-responsive. **Prices/Bids are to include ALL costs** (including but not limited to travel expenses, benefits, overhead, profit, waste, un-acceptable counts, etc.). Multiple and simultaneous purchase orders from the same contracting agency are permissible.

**ENTER YOUR PRICE FOR A SINGLE COUNT FOR EACH ROADWAY CONFIGURATION AND TIER.**

Roadway Configuration		TIER (Number of Counts in Purchase Order)		
		1 to 20	21 to 100	101 to 300
TWO Lane	WITH physical barrier	316	289	289
	WITHOUT physical barrier	216	189	189
FOUR Lane	WITH physical barrier	316	289	289
	WITHOUT physical barrier	216	189	189
six Lane	WITH physical barrier	316	289	289
	WITHOUT physical barrier	316	289	289
EIGHT Lane	WITH physical barrier	316	289	289
	WITHOUT physical barrier	316	289	289

## PRICE SHEET for Volume or Class Counts

DISTRICT: 12 TYPE OF COUNTS (Circle) Volume Class SUBMITTER: MCV ASSOCIATES, INC.

**NOTE:** A separate Price Sheet must be completed for each District in which you wish to place a bid and for each type of count. Bidders must submit a bid price for every price tier and every roadway configuration below. Any bids not so complete will be determined to be non-responsive. **Prices/Bids are to include ALL costs** (including but not limited to travel expenses, benefits, overhead, profit, waste, un-acceptable counts, etc.). Multiple and simultaneous purchase orders from the same contracting agency are permissible.

ENTER YOUR PRICE FOR A SINGLE COUNT FOR EACH ROADWAY CONFIGURATION AND TIER.

Roadway Configuration		TIER (Number of Counts in Purchase Order)		
		1 to 20	21 to 100	101 to 300
TWO Lane	WITH physical barrier	309	285	285
	WITHOUT physical barrier	209	185	185
FOUR Lane	WITH physical barrier	309	285	285
	WITHOUT physical barrier	209	185	185
Six Lane	WITH physical barrier	309	285	285
	WITHOUT physical barrier	309	285	285
EIGHT Lane	WITH physical barrier	309	285	285
	WITHOUT physical barrier	309	285	285

TRI-STATE TRAFFIC DATA, INC.  
184 BAKER ROAD  
COATESVILLE PA 19320  
**PRICE SHEET for Manual Counts**

**SUBMITTER:** \_\_\_\_\_

**NOTE:** Enter a price only in the District(s) in which you are willing to take manual counts; prices may vary by District.

**Prices/Bids are to include ALL costs** (including but not limited to travel expenses, benefits, overhead, profit, waste, un-acceptable counts, etc.).

District	Hourly price per person
1	\$ 150
2	150
3	90
4	75
5	55
6	55
8	65
9	125
10	150
11	150
12	150

Line # 7  
District # 1

District 1 (Erie)		1 to 20		21 to 100		101 to 300
2 lane volume		\$500.00		\$225.00		\$165.00
2 lane volume w/barrier		\$500.00		\$225.00		\$165.00
4 lane volume		\$650.00		\$345.00		\$210.00
4 lane volume w/barrier		\$650.00		\$345.00		\$210.00
6 lane volume		\$700.00		\$410.00		\$255.00
6 lane volume w/barrier		\$700.00		\$410.00		\$255.00
8 lane volume		\$800.00		\$600.00		\$310.00
8 lane volume w/barrier		\$800.00		\$600.00		\$310.00
2 lane class		\$500.00		\$310.00		\$250.00
2 lane class w/barrier		\$500.00		\$310.00		\$250.00
4 lane class		\$650.00		\$410.00		\$360.00
4 lane class w/barrier		\$650.00		\$410.00		\$360.00
6 lane class		\$800.00		\$450.00		\$400.00
6 lane class w/barrier		\$800.00		\$450.00		\$400.00
8 lane class		\$1,200.00		\$1,200.00		\$1,200.00
8 lane class w/barrier		\$1,200.00		\$1,200.00		\$1,200.00

Line # 7  
District # 2

District 2 (Clearfiled)		1 to 20		21 to 100		101 to 300
2 lane volume		\$350.00		\$210.00		\$110.00
2 lane volume w/barrier		\$350.00		\$210.00		\$110.00
4 lane volume		\$550.00		\$375.00		\$185.00
4 lane volume w/barrier		\$550.00		\$375.00		\$185.00
6 lane volume		\$650.00		\$450.00		\$225.00
6 lane volume w/barrier		\$650.00		\$450.00		\$225.00
8 lane volume		\$800.00		\$600.00		\$300.00
8 lane volume w/barrier		\$800.00		\$600.00		\$300.00
2 lane class		\$350.00		\$300.00		\$225.00
2 lane class w/barrier		\$350.00		\$300.00		\$225.00
4 lane class		\$650.00		\$375.00		\$360.00
4 lane class w/barrier		\$650.00		\$375.00		\$360.00
6 lane class		\$700.00		\$400.00		\$425.00
6 lane class w/barrier		\$700.00		\$400.00		\$425.00
8 lane class		\$900.00		\$900.00		\$900.00
8 lane class w/barrier		\$900.00		\$900.00		\$900.00

Line # 7  
 District #3

District 3	1 to 20	21 to 100	101 to 300
2 lane volume	\$300.00	\$185.00	\$99.00
2 lane volume w/barrier	\$300.00	\$185.00	\$99.00
4 lane volume	\$500.00	\$325.00	\$155.00
4 lane volume w/barrier	\$500.00	\$325.00	\$155.00
6 lane volume	\$600.00	\$375.00	\$200.00
6 lane volume w/barrier	\$600.00	\$375.00	\$200.00
8 lane volume	\$700.00	\$500.00	\$300.00
8 lane volume w/barrier	\$700.00	\$500.00	\$300.00
2 lane class	\$350.00	\$225.00	\$185.00
2 lane class w/barrier	\$350.00	\$225.00	\$185.00
4 lane class	\$550.00	\$325.00	\$285.00
4 lane class w/barrier	\$550.00	\$325.00	\$285.00
6 lane class	\$600.00	\$400.00	\$425.00
6 lane class w/barrier	\$600.00	\$400.00	\$425.00
8 lane class	\$900.00	\$900.00	\$900.00
8 lane class w/barrier	\$900.00	\$900.00	\$900.00

Line # 7  
District #4

District 4	1 to 20	21 to 100	101 to 300
2 lane volume	\$300.00	\$175.00	\$90.00
2 lane volume w/barrier	\$300.00	\$175.00	\$90.00
4 lane volume	\$500.00	\$300.00	\$150.00
4 lane volume w/barrier	\$500.00	\$300.00	\$150.00
6 lane volume	\$600.00	\$350.00	\$200.00
6 lane volume w/barrier	\$600.00	\$350.00	\$200.00
8 lane volume	\$700.00	\$500.00	\$300.00
8 lane volume w/barrier	\$700.00	\$500.00	\$300.00
2 lane class	\$350.00	\$225.00	\$185.00
2 lane class w/barrier	\$350.00	\$225.00	\$185.00
4 lane class	\$550.00	\$325.00	\$285.00
4 lane class w/barrier	\$550.00	\$325.00	\$285.00
6 lane class	\$600.00	\$400.00	\$425.00
6 lane class w/barrier	\$600.00	\$400.00	\$425.00
8 lane class	\$900.00	\$900.00	\$900.00
8 lane class w/barrier	\$900.00	\$900.00	\$900.00

Line # 7  
DISTRICT # 5

District 5			1 to 20		21 to 100		101 to 300
2 lane volume			\$300.00		\$175.00		\$90.00
2 lane volume w/barrier			\$300.00		\$175.00		\$90.00
4 lane volume			\$500.00		\$300.00		\$150.00
4 lane volume w/barrier			\$500.00		\$300.00		\$150.00
6 lane volume			\$600.00		\$350.00		\$200.00
6 lane volume w/barrier			\$600.00		\$350.00		\$200.00
8 lane volume			\$700.00		\$500.00		\$300.00
8 lane volume w/barrier			\$700.00		\$500.00		\$300.00
2 lane class			\$350.00		\$225.00		\$185.00
2 lane class w/barrier			\$350.00		\$225.00		\$185.00
4 lane class			\$550.00		\$325.00		\$285.00
4 lane class w/barrier			\$550.00		\$325.00		\$285.00
6 lane class			\$600.00		\$400.00		\$350.00
6 lane class w/barrier			\$600.00		\$400.00		\$350.00
8 lane class			\$900.00		\$900.00		\$900.00
8 lane class w/barrier			\$900.00		\$900.00		\$900.00

Line # 7  
DISTRICT # 6

District 6		1 to 20	21 to 100	101 to 300
2 lane volume		\$225.00	\$135.00	\$90.00
2 lane volume w/barrier		\$225.00	\$135.00	\$90.00
4 lane volume		\$400.00	\$250.00	\$150.00
4 lane volume w/barrier		\$400.00	\$250.00	\$150.00
6 lane volume		\$450.00	\$295.00	\$200.00
6 lane volume w/barrier		\$450.00	\$295.00	\$200.00
8 lane volume		\$700.00	\$400.00	\$300.00
8 lane volume w/barrier		\$700.00	\$400.00	\$300.00
2 lane class		\$300.00	\$225.00	\$150.00
2 lane class w/barrier		\$300.00	\$225.00	\$150.00
4 lane class		\$400.00	\$325.00	\$250.00
4 lane class w/barrier		\$400.00	\$325.00	\$250.00
6 lane class		\$600.00	\$400.00	\$350.00
6 lane class w/barrier		\$600.00	\$400.00	\$350.00
8 lane class		\$800.00	\$800.00	\$900.00
8 lane class w/barrier		\$800.00	\$800.00	\$900.00

Line # 7  
District # 8

District 8		1 to 20		21 to 100		101 to 300
2 lane volume		\$225.00		\$135.00		\$90.00
2 lane volume w/barrier		\$225.00		\$135.00		\$90.00
4 lane volume		\$400.00		\$250.00		\$150.00
4 lane volume w/barrier		\$400.00		\$250.00		\$150.00
6 lane volume		\$450.00		\$295.00		\$200.00
6 lane volume w/barrier		\$450.00		\$295.00		\$200.00
8 lane volume		\$700.00		\$400.00		\$300.00
8 lane volume w/barrier		\$700.00		\$400.00		\$300.00
2 lane class		\$300.00		\$225.00		\$150.00
2 lane class w/barrier		\$300.00		\$225.00		\$150.00
4 lane class		\$400.00		\$325.00		\$250.00
4 lane class w/barrier		\$400.00		\$325.00		\$250.00
6 lane class		\$600.00		\$400.00		\$350.00
6 lane class w/barrier		\$600.00		\$400.00		\$350.00
8 lane class		\$800.00		\$800.00		\$900.00
8 lane class w/barrier		\$800.00		\$800.00		\$900.00

Line # 7  
 District # 9

District 9		1 to 20		21 to 100		101 to 300
2 lane volume		\$325.00		\$185.00		\$150.00
2 lane volume w/barrier		\$325.00		\$185.00		\$150.00
4 lane volume		\$550.00		\$250.00		\$185.00
4 lane volume w/barrier		\$550.00		\$250.00		\$185.00
6 lane volume		\$650.00		\$350.00		\$250.00
6 lane volume w/barrier		\$650.00		\$350.00		\$250.00
8 lane volume		\$700.00		\$450.00		\$300.00
8 lane volume w/barrier		\$700.00		\$450.00		\$300.00
2 lane class		\$300.00		\$225.00		\$150.00
2 lane class w/barrier		\$300.00		\$225.00		\$150.00
4 lane class		\$400.00		\$325.00		\$250.00
4 lane class w/barrier		\$400.00		\$325.00		\$250.00
6 lane class		\$600.00		\$400.00		\$350.00
6 lane class w/barrier		\$600.00		\$400.00		\$350.00
8 lane class		\$900.00		\$800.00		\$800.00
8 lane class w/barrier		\$900.00		\$800.00		\$800.00

Line # 7  
District # 10

District 10	1 to 20	21 to 100	101 to 300
2 lane volume	\$350.00	\$200.00	\$150.00
2 lane volume w/barrier	\$350.00	\$200.00	\$150.00
4 lane volume	\$550.00	\$250.00	\$185.00
4 lane volume w/barrier	\$550.00	\$250.00	\$185.00
6 lane volume	\$650.00	\$350.00	\$250.00
6 lane volume w/barrier	\$650.00	\$350.00	\$250.00
8 lane volume	\$700.00	\$450.00	\$300.00
8 lane volume w/barrier	\$700.00	\$450.00	\$300.00
2 lane class	\$300.00	\$225.00	\$150.00
2 lane class w/barrier	\$300.00	\$225.00	\$150.00
4 lane class	\$400.00	\$325.00	\$250.00
4 lane class w/barrier	\$400.00	\$325.00	\$250.00
6 lane class	\$600.00	\$400.00	\$350.00
6 lane class w/barrier	\$600.00	\$400.00	\$350.00
8 lane class	\$900.00	\$800.00	\$800.00
8 lane class w/barrier	\$900.00	\$800.00	\$800.00

Line # 7  
District # 11

District 11		1 to 20		21 to 100		101 to 300
2 lane volume		\$350.00		\$200.00		\$150.00
2 lane volume w/barrier		\$350.00		\$200.00		\$150.00
4 lane volume		\$550.00		\$250.00		\$185.00
4 lane volume w/barrier		\$550.00		\$250.00		\$185.00
6 lane volume		\$650.00		\$350.00		\$250.00
6 lane volume w/barrier		\$650.00		\$350.00		\$250.00
8 lane volume		\$700.00		\$450.00		\$300.00
8 lane volume w/barrier		\$700.00		\$450.00		\$300.00
2 lane class		\$300.00		\$225.00		\$150.00
2 lane class w/barrier		\$300.00		\$225.00		\$150.00
4 lane class		\$400.00		\$325.00		\$250.00
4 lane class w/barrier		\$400.00		\$325.00		\$250.00
6 lane class		\$600.00		\$400.00		\$350.00
6 lane class w/barrier		\$600.00		\$400.00		\$350.00
8 lane class		\$900.00		\$800.00		\$800.00
8 lane class w/barrier		\$900.00		\$800.00		\$800.00

Line # 7  
District # 12

District 12		1 to 20		21 to 100		101 to 300
2 lane volume		\$350.00		\$200.00		\$150.00
2 lane volume w/barrier		\$350.00		\$200.00		\$150.00
4 lane volume		\$550.00		\$250.00		\$185.00
4 lane volume w/barrier		\$550.00		\$250.00		\$185.00
6 lane volume		\$650.00		\$350.00		\$250.00
6 lane volume w/barrier		\$650.00		\$350.00		\$250.00
8 lane volume		\$700.00		\$450.00		\$300.00
8 lane volume w/barrier		\$700.00		\$450.00		\$300.00
2 lane class		\$300.00		\$225.00		\$150.00
2 lane class w/barrier		\$300.00		\$225.00		\$150.00
4 lane class		\$400.00		\$325.00		\$250.00
4 lane class w/barrier		\$400.00		\$325.00		\$250.00
6 lane class		\$600.00		\$400.00		\$350.00
6 lane class w/barrier		\$600.00		\$400.00		\$350.00
8 lane class		\$900.00		\$800.00		\$800.00
8 lane class w/barrier		\$900.00		\$800.00		\$800.00

### PRICE SHEET for Manual Counts

**SUBMITTER:** Transportation Resource Group, Inc.

**NOTE:** Enter a price only in the District(s) in which you are willing to take manual counts; prices may vary by District.

**Prices/Bids are to include ALL costs** (including but not limited to travel expenses, benefits, overhead, profit, waste, un-acceptable counts, etc.).

District	Hourly price per person
1	_____
2	_____
3	\$ 80.00
4	_____
5	\$ 80.00
6	\$ 75.00
8	\$ 65.00
9	\$ 80.00
10	_____
11	_____
12	_____

**PRICE SHEET for Volume or Class Counts**

DISTRICT: 3-0 TYPE OF COUNTS (Circle) Volume Class SUBMITTER: Transportation Resource Group, Inc.

**NOTE:** A separate Price Sheet must be completed for each District in which you wish to place a bid and for each type of count. Bidders must submit a bid price for every price tier and every roadway configuration below. Any bids not so complete will be determined to be non-responsive. **Prices/Bids are to include ALL costs** (including but not limited to travel expenses, benefits, overhead, profit, waste, un-acceptable counts, etc.). Multiple and simultaneous purchase orders from the same contracting agency are permissible.

ENTER YOUR PRICE FOR A **SINGLE** COUNT FOR EACH ROADWAY CONFIGURATION AND TIER.

Roadway Configuration		TIER (Number of Counts in Purchase Order)		
		1 to 20	21 to 100	101 to 300
TWO Lane	WITH physical barrier	\$ 350.00	\$ 332.50	\$ 315.00
	WITHOUT physical barrier	\$ 250.00	\$ 237.50	\$ 225.00
FOUR Lane	WITH physical barrier	\$ 440.00	\$ 418.00	\$ 396.00
	WITHOUT physical barrier	\$ 265.00	\$ 251.75	\$ 238.50
SIX Lane	WITH physical barrier	\$ 550.00	\$ 522.50	\$ 495.00
	WITHOUT physical barrier	\$ 420.00	\$ 399.00	\$ 378.00
EIGHT Lane	WITH physical barrier	\$ 550.00	\$ 522.50	\$ 495.00
	WITHOUT physical barrier	\$ 420.00	\$ 399.00	\$ 378.00

**PRICE SHEET for Volume or Class Counts**

DISTRICT: 3 - 0 TYPE OF COUNTS (Circle) Volume Class SUBMITTER: Transportation Resource Group, Inc.

**NOTE:** A separate Price Sheet must be completed for each District in which you wish to place a bid and for each type of count. Bidders must submit a bid price for every price tier and every roadway configuration below. Any bids not so complete will be determined to be non-responsive. **Prices/Bids are to include ALL costs** (including but not limited to travel expenses, benefits, overhead, profit, waste, un-acceptable counts, etc.). Multiple and simultaneous purchase orders from the same contracting agency are permissible.

ENTER YOUR PRICE FOR A **SINGLE** COUNT FOR EACH ROADWAY CONFIGURATION AND TIER.

Roadway Configuration		TIER (Number of Counts in Purchase Order)		
		1 to 20	21 to 100	101 to 300
TWO Lane	WITH physical barrier	\$ 350.00	\$ 332.50	\$ 315.00
	WITHOUT physical barrier	\$ 250.00	\$ 237.50	\$ 225.00
FOUR Lane	WITH physical barrier	\$ 500.00	\$ 475.00	\$ 450.00
	WITHOUT physical barrier	\$ 500.00	\$ 475.00	\$ 450.00
SIX Lane	WITH physical barrier	\$ 630.00	\$ 598.50	\$ 567.00
	WITHOUT physical barrier	\$ 630.00	\$ 598.50	\$ 567.00
EIGHT Lane	WITH physical barrier	\$ 1,000.00	\$ 950.00	\$ 900.00
	WITHOUT physical barrier	\$ 1,000.00	\$ 950.00	\$ 900.00

**PRICE SHEET for Volume or Class Counts**

DISTRICT: 5-0 TYPE OF COUNTS (Circle) Volume Class SUBMITTER: Transportation Resource Group, Inc.

**NOTE:** A separate Price Sheet must be completed for each District in which you wish to place a bid and for each type of count. Bidders must submit a bid price for every price tier and every roadway configuration below. Any bids not so complete will be determined to be non-responsive. **Prices/Bids are to include ALL costs** (including but not limited to travel expenses, benefits, overhead, profit, waste, un-acceptable counts, etc.). Multiple and simultaneous purchase orders from the same contracting agency are permissible.

ENTER YOUR PRICE FOR A **SINGLE** COUNT FOR EACH ROADWAY CONFIGURATION AND TIER.

Roadway Configuration		TIER (Number of Counts in Purchase Order)		
		1 to 20	21 to 100	101 to 300
TWO Lane	WITH physical barrier	\$ 350.00	\$ 332.50	\$ 315.00
	WITHOUT physical barrier	\$ 240.00	\$ 228.00	\$ 216.00
FOUR Lane	WITH physical barrier	\$ 430.00	\$ 408.50	\$ 387.00
	WITHOUT physical barrier	\$ 255.00	\$ 242.25	\$ 229.50
SIX Lane	WITH physical barrier	\$ 540.00	\$ 513.00	\$ 486.00
	WITHOUT physical barrier	\$ 400.00	\$ 380.00	\$ 360.00
EIGHT Lane	WITH physical barrier	\$ 540.00	\$ 513.00	\$ 486.00
	WITHOUT physical barrier	\$ 400.00	\$ 380.00	\$ 360.00

### PRICE SHEET for Volume or Class Counts

DISTRICT: 5 - 0 TYPE OF COUNTS (Circle) Volume Class SUBMITTER: Transportation Resource Group, Inc.

**NOTE:** A separate Price Sheet must be completed for each District in which you wish to place a bid and for each type of count. Bidders must submit a bid price for every price tier and every roadway configuration below. Any bids not so complete will be determined to be non-responsive. **Prices/Bids are to include ALL costs** (including but not limited to travel expenses, benefits, overhead, profit, waste, un-acceptable counts, etc.). Multiple and simultaneous purchase orders from the same contracting agency are permissible.

ENTER YOUR PRICE FOR A **SINGLE** COUNT FOR EACH ROADWAY CONFIGURATION AND TIER.

Roadway Configuration		TIER (Number of Counts in Purchase Order)		
		1 to 20	21 to 100	101 to 300
TWO Lane	WITH physical barrier	\$ 350.00	\$ 332.50	\$ 315.00
	WITHOUT physical barrier	\$ 240.00	\$ 228.00	\$ 216.00
FOUR Lane	WITH physical barrier	\$ 490.00	\$ 465.50	\$ 441.00
	WITHOUT physical barrier	\$ 490.00	\$ 465.50	\$ 441.00
SIX Lane	WITH physical barrier	\$ 615.00	\$ 584.25	\$ 553.50
	WITHOUT physical barrier	\$ 615.00	\$ 584.25	\$ 553.50
EIGHT Lane	WITH physical barrier	\$ 1,000.00	\$ 950.00	\$ 900.00
	WITHOUT physical barrier	\$ 1,000.00	\$ 950.00	\$ 900.00

**PRICE SHEET for Volume or Class Counts**

DISTRICT: 6-0 TYPE OF COUNTS (Circle) Volume Class SUBMITTER: Transportation Resource Group, Inc.

**NOTE:** A separate Price Sheet must be completed for each District in which you wish to place a bid and for each type of count. Bidders must submit a bid price for every price tier and every roadway configuration below. Any bids not so complete will be determined to be non-responsive. **Prices/Bids are to include ALL costs** (including but not limited to travel expenses, benefits, overhead, profit, waste, un-acceptable counts, etc.). Multiple and simultaneous purchase orders from the same contracting agency are permissible.

ENTER YOUR PRICE FOR A **SINGLE** COUNT FOR EACH ROADWAY CONFIGURATION AND TIER.

Roadway Configuration		TIER (Number of Counts in Purchase Order)		
		1 to 20	21 to 100	101 to 300
TWO Lane	WITH physical barrier	\$ 330.00	\$ 313.50	\$ 297.00
	WITHOUT physical barrier	\$ 225.00	\$ 213.75	\$ 202.50
FOUR Lane	WITH physical barrier	\$ 405.00	\$ 384.75	\$ 364.50
	WITHOUT physical barrier	\$ 245.00	\$ 232.75	\$ 220.50
SIX Lane	WITH physical barrier	\$ 510.00	\$ 484.50	\$ 459.00
	WITHOUT physical barrier	\$ 375.00	\$ 356.25	\$ 337.50
EIGHT Lane	WITH physical barrier	\$ 510.00	\$ 484.50	\$ 459.00
	WITHOUT physical barrier	\$ 375.00	\$ 356.25	\$ 337.50

**PRICE SHEET for Volume or Class Counts**

DISTRICT: 6-0 TYPE OF COUNTS (Circle) Volume Class SUBMITTER: Transportation Resource Group, Inc.

**NOTE:** A separate Price Sheet must be completed for each District in which you wish to place a bid and for each type of count. Bidders must submit a bid price for every price tier and every roadway configuration below. Any bids not so complete will be determined to be non-responsive. **Prices/Bids are to include ALL costs** (including but not limited to travel expenses, benefits, overhead, profit, waste, un-acceptable counts, etc.). Multiple and simultaneous purchase orders from the same contracting agency are permissible.

ENTER YOUR PRICE FOR A **SINGLE** COUNT FOR EACH ROADWAY CONFIGURATION AND TIER.

Roadway Configuration		TIER (Number of Counts in Purchase Order)		
		1 to 20	21 to 100	101 to 300
TWO Lane	WITH physical barrier	\$ 330.00	\$ 313.50	\$ 297.00
	WITHOUT physical barrier	\$ 225.00	\$ 213.75	\$ 202.50
FOUR Lane	WITH physical barrier	\$ 460.00	\$ 437.00	\$ 414.00
	WITHOUT physical barrier	\$ 460.00	\$ 437.00	\$ 414.00
SIX Lane	WITH physical barrier	\$ 590.00	\$ 560.50	\$ 531.00
	WITHOUT physical barrier	\$ 590.00	\$ 560.50	\$ 531.00
EIGHT Lane	WITH physical barrier	\$ 940.00	\$ 893.00	\$ 846.00
	WITHOUT physical barrier	\$ 940.00	\$ 893.00	\$ 846.00

**PRICE SHEET for Volume or Class Counts**

DISTRICT: 8-0 TYPE OF COUNTS (Circle) Volume Class SUBMITTER: Transportation Resource Group, Inc.

**NOTE:** A separate Price Sheet must be completed for each District in which you wish to place a bid and for each type of count. Bidders must submit a bid price for every price tier and every roadway configuration below. Any bids not so complete will be determined to be non-responsive. **Prices/Bids are to include ALL costs** (including but not limited to travel expenses, benefits, overhead, profit, waste, un-acceptable counts, etc.). Multiple and simultaneous purchase orders from the same contracting agency are permissible.

ENTER YOUR PRICE FOR A **SINGLE** COUNT FOR EACH ROADWAY CONFIGURATION AND TIER.

Roadway Configuration		TIER (Number of Counts in Purchase Order)		
		1 to 20	21 to 100	101 to 300
TWO Lane	WITH physical barrier	\$ 300.00	\$ 285.00	\$ 270.00
	WITHOUT physical barrier	\$ 200.00	\$ 190.00	\$ 180.00
FOUR Lane	WITH physical barrier	\$ 370.00	\$ 351.50	\$ 333.00
	WITHOUT physical barrier	\$ 215.00	\$ 204.25	\$ 193.50
SIX Lane	WITH physical barrier	\$ 470.00	\$ 446.50	\$ 423.00
	WITHOUT physical barrier	\$ 335.00	\$ 318.25	\$ 301.50
EIGHT Lane	WITH physical barrier	\$ 470.00	\$ 446.50	\$ 423.00
	WITHOUT physical barrier	\$ 335.00	\$ 318.25	\$ 301.50

**PRICE SHEET for Volume or Class Counts**

DISTRICT: 8-0 TYPE OF COUNTS (Circle) Volume Class SUBMITTER: Transportation Resource Group, Inc.

**NOTE:** A separate Price Sheet must be completed for each District in which you wish to place a bid and for each type of count. Bidders must submit a bid price for every price tier and every roadway configuration below. Any bids not so complete will be determined to be non-responsive. **Prices/Bids are to include ALL costs** (including but not limited to travel expenses, benefits, overhead, profit, waste, un-acceptable counts, etc.). Multiple and simultaneous purchase orders from the same contracting agency are permissible.

ENTER YOUR PRICE FOR A **SINGLE** COUNT FOR EACH ROADWAY CONFIGURATION AND TIER.

Roadway Configuration		TIER (Number of Counts in Purchase Order)		
		1 to 20	21 to 100	101 to 300
TWO Lane	WITH physical barrier	\$ 300.00	\$ 285.00	\$ 270.00
	WITHOUT physical barrier	\$ 200.00	\$ 190.00	\$ 180.00
FOUR Lane	WITH physical barrier	\$ 420.00	\$ 399.00	\$ 378.00
	WITHOUT physical barrier	\$ 420.00	\$ 399.00	\$ 378.00
SIX Lane	WITH physical barrier	\$ 550.00	\$ 522.50	\$ 495.00
	WITHOUT physical barrier	\$ 550.00	\$ 522.50	\$ 495.00
EIGHT Lane	WITH physical barrier	\$ 850.00	\$ 807.50	\$ 765.00
	WITHOUT physical barrier	\$ 850.00	\$ 807.50	\$ 765.00

**PRICE SHEET for Volume or Class Counts**

DISTRICT: 9-0 TYPE OF COUNTS (Circle) Volume Class SUBMITTER: Transportation Resource Group, Inc.

**NOTE:** A separate Price Sheet must be completed for each District in which you wish to place a bid and for each type of count. Bidders must submit a bid price for every price tier and every roadway configuration below. Any bids not so complete will be determined to be non-responsive. **Prices/Bids are to include ALL costs** (including but not limited to travel expenses, benefits, overhead, profit, waste, un-acceptable counts, etc.). Multiple and simultaneous purchase orders from the same contracting agency are permissible.

ENTER YOUR PRICE FOR A **SINGLE** COUNT FOR EACH ROADWAY CONFIGURATION AND TIER.

Roadway Configuration		TIER (Number of Counts in Purchase Order)		
		1 to 20	21 to 100	101 to 300
TWO Lane	WITH physical barrier	\$ 360.00	\$ 342.00	\$ 324.00
	WITHOUT physical barrier	\$ 255.00	\$ 242.25	\$ 229.50
FOUR Lane	WITH physical barrier	\$ 445.00	\$ 422.75	\$ 400.50
	WITHOUT physical barrier	\$ 270.00	\$ 256.50	\$ 243.00
SIX Lane	WITH physical barrier	\$ 560.00	\$ 532.00	\$ 504.00
	WITHOUT physical barrier	\$ 425.00	\$ 403.75	\$ 382.50
EIGHT Lane	WITH physical barrier	\$ 560.00	\$ 532.00	\$ 504.00
	WITHOUT physical barrier	\$ 425.00	\$ 403.75	\$ 382.50

**PRICE SHEET for Volume or Class Counts**

DISTRICT: 9-0 TYPE OF COUNTS (Circle) Volume Class SUBMITTER: Transportation Resource Group, Inc.

**NOTE:** A separate Price Sheet must be completed for each District in which you wish to place a bid and for each type of count. Bidders must submit a bid price for every price tier and every roadway configuration below. Any bids not so complete will be determined to be non-responsive. **Prices/Bids are to include ALL costs** (including but not limited to travel expenses, benefits, overhead, profit, waste, un-acceptable counts, etc.). Multiple and simultaneous purchase orders from the same contracting agency are permissible.

ENTER YOUR PRICE FOR A **SINGLE** COUNT FOR EACH ROADWAY CONFIGURATION AND TIER.

Roadway Configuration		TIER (Number of Counts in Purchase Order)		
		1 to 20	21 to 100	101 to 300
TWO Lane	WITH physical barrier	\$ 360.00	\$ 342.00	\$ 324.00
	WITHOUT physical barrier	\$ 255.00	\$ 242.25	\$ 229.50
FOUR Lane	WITH physical barrier	\$ 510.00	\$ 484.50	\$ 459.00
	WITHOUT physical barrier	\$ 510.00	\$ 484.50	\$ 459.00
SIX Lane	WITH physical barrier	\$ 635.00	\$ 603.25	\$ 571.50
	WITHOUT physical barrier	\$ 635.00	\$ 603.25	\$ 571.50
EIGHT Lane	WITH physical barrier	\$ 1,040.00	\$ 988.00	\$ 936.00
	WITHOUT physical barrier	\$ 1,040.00	\$ 988.00	\$ 936.00

## PRICE SHEET for Volume of Class Counts

DISTRICT: 3 TYPE OF COUNTS (Circle) Volume Class SUBMITTER: Urbitran Associates, Inc.

NOTE: A separate Price Sheet must be completed for each District in which you wish to place a bid and for each type of count. Bidders must submit a bid price for every price tier and every roadway configuration below. Any bids not so complete will be determined to be non-responsive. **Prices/Bids are to include ALL costs** (including but not limited to travel expenses, benefits, overhead, profit, waste, un-acceptable counts, etc.). Multiple and simultaneous purchase orders from the same contracting agency are permissible.

ENTER YOUR PRICE FOR A **SINGLE** COUNT FOR EACH ROADWAY CONFIGURATION AND TIER.

Roadway Configuration		TIER (Number of Counts in Purchase Order)		
		1 to 20	21 to 100	101 to 300
TWO Lane	WITH physical barrier	\$600.00	\$550.00	\$510.00
	WITHOUT physical barrier	\$600.00	\$550.00	\$510.00
FOUR Lane	WITH physical barrier	\$850.00	\$810.00	\$770.00
	WITHOUT physical barrier	\$850.00	\$810.00	\$770.00
SIX Lane	WITH physical barrier	\$1,620.00	\$1,530.00	\$1,450.00
	WITHOUT physical barrier	\$1,620.00	\$1,530.00	\$1,450.00
EIGHT Lane	WITH physical barrier	\$1,700.00	\$1,620.00	\$1,530.00
	WITHOUT physical barrier	\$1,700.00	\$1,620.00	\$1,530.00

\* Pricing for counts of 24-48 hour duration. Counts of longer duration are subject to possible increased pricing.

**PRICE SHEET for Volume or Class Counts**

DISTRICT: 3 TYPE OF COUNTS (Circle) Volume Class SUBMITTER: Urbitran Associates, Inc.

**NOTE:** A separate Price Sheet must be completed for each District in which you wish to place a bid and for each type of count. Bidders must submit a bid price for every price tier and every roadway configuration below. Any bids not so complete will be determined to be non-responsive. **Prices/Bids are to include ALL costs** (including but not limited to travel expenses, benefits, overhead, profit, waste, un-acceptable counts, etc.). Multiple and simultaneous purchase orders from the same contracting agency are permissible.

ENTER YOUR PRICE FOR A **SINGLE** COUNT FOR EACH ROADWAY CONFIGURATION AND TIER.

Roadway Configuration		TIER (Number of Counts in Purchase Order)		
		1 to 20	21 to 100	101 to 300
TWO Lane	WITH physical barrier	\$470.00	\$450.00	\$425.00
	WITHOUT physical barrier	\$390.00	\$370.00	\$350.00
FOUR Lane	WITH physical barrier	\$570.00	\$540.00	\$515.00
	WITHOUT physical barrier	\$600.00	\$570.00	\$540.00
SIX Lane	WITH physical barrier	\$1,090.00	\$1,040.00	\$980.00
	WITHOUT physical barrier	\$850.00	\$810.00	\$770.00
EIGHT Lane	WITH physical barrier	\$1,140.00	\$1,080.00	\$1,030.00
	WITHOUT physical barrier	\$1,140.00	\$1,080.00	\$1,030.00

\* Pricing for counts of 24-48 hour duration. Counts of longer duration are subject to possible increased pricing.

**PRICE SHEET for Volume or Class Counts**

DISTRICT: 4 TYPE OF COUNTS (Circle) Volume Class SUBMITTER: Urbitran Associates, Inc.

**NOTE:** A separate Price Sheet must be completed for each District in which you wish to place a bid and for each type of count. Bidders must submit a bid price for every price tier and every roadway configuration below. Any bids not so complete will be determined to be non-responsive. **Prices/Bids are to include ALL costs** (including but not limited to travel expenses, benefits, overhead, profit, waste, un-acceptable counts, etc.). Multiple and simultaneous purchase orders from the same contracting agency are permissible.

ENTER YOUR PRICE FOR A **SINGLE** COUNT FOR EACH ROADWAY CONFIGURATION AND TIER.

Roadway Configuration		TIER (Number of Counts in Purchase Order)		
		1 to 20	21 to 100	101 to 300
TWO Lane	WITH physical barrier	\$510.00	\$490.00	\$470.00
	WITHOUT physical barrier	\$510.00	\$490.00	\$470.00
FOUR Lane	WITH physical barrier	\$640.00	\$600.00	\$560.00
	WITHOUT physical barrier	\$640.00	\$600.00	\$560.00
SIX Lane	WITH physical barrier	\$1,450.00	\$1,380.00	\$1,320.00
	WITHOUT physical barrier	\$1,450.00	\$1,380.00	\$1,320.00
EIGHT Lane	WITH physical barrier	\$1,530.00	\$1,450.00	\$1,360.00
	WITHOUT physical barrier	\$1,530.00	\$1,450.00	\$1,360.00

\* Pricing for counts of 24-48 hour duration. Counts of longer duration are subject to possible increased pricing.

**PRICE SHEET for Volume or Class Counts**

DISTRICT: 4 TYPE OF COUNTS (Circle) Volume Class SUBMITTER: Urbitran Associates, Inc.

**NOTE:** A separate Price Sheet must be completed for each District in which you wish to place a bid and for each type of count. Bidders must submit a bid price for every price tier and every roadway configuration below. Any bids not so complete will be determined to be non-responsive. Prices/Bids are to include ALL costs (including but not limited to travel expenses, benefits, overhead, profit, waste, un-acceptable counts, etc.). Multiple and simultaneous purchase orders from the same contracting agency are permissible.

ENTER YOUR PRICE FOR A **SINGLE** COUNT FOR EACH ROADWAY CONFIGURATION AND TIER.

Roadway Configuration		TIER (Number of Counts in Purchase Order)		
		1 to 20	21 to 100	101 to 300
TWO Lane	WITH physical barrier	\$410.00	\$390.00	\$370.00
	WITHOUT physical barrier	\$325.00	\$310.00	\$290.00
FOUR Lane	WITH physical barrier	\$510.00	\$490.00	\$460.00
	WITHOUT physical barrier	\$530.00	\$500.00	\$480.00
SIX Lane	WITH physical barrier	\$940.00	\$890.00	\$850.00
	WITHOUT physical barrier	\$760.00	\$720.00	\$690.00
EIGHT Lane	WITH physical barrier	\$990.00	\$940.00	\$900.00
	WITHOUT physical barrier	\$990.00	\$940.00	\$900.00

\* Pricing for counts of 24-48 hour duration. Counts of longer duration are subject to possible increased pricing.

**PRICE SHEET for Volume of Class Counts**

DISTRICT: 5 TYPE OF COUNTS (Circle) Volume Class SUBMITTER: Urbitran Associates, Inc..

**NOTE:** A separate Price Sheet must be completed for each District in which you wish to place a bid and for each type of count. Bidders must submit a bid price for every price tier and every roadway configuration below. Any bids not so complete will be determined to be non-responsive. **Prices/Bids are to include ALL costs** (including but not limited to travel expenses, benefits, overhead, profit, waste, un-acceptable counts, etc.). Multiple and simultaneous purchase orders from the same contracting agency are permissible.

ENTER YOUR PRICE FOR A **SINGLE** COUNT FOR EACH ROADWAY CONFIGURATION AND TIER.

Roadway Configuration		TIER (Number of Counts in Purchase Order)		
		1 to 20	21 to 100	101 to 300
TWO Lane	WITH physical barrier	\$450.00	\$425.00	\$400.00
	WITHOUT physical barrier	\$450.00	\$425.00	\$400.00
FOUR Lane	WITH physical barrier	\$600.00	\$575.00	\$530.00
	WITHOUT physical barrier	\$600.00	\$575.00	\$530.00
SIX Lane	WITH physical barrier	\$1,360.00	\$1,300.00	\$1,230.00
	WITHOUT physical barrier	\$1,360.00	\$1,300.00	\$1,230.00
EIGHT Lane	WITH physical barrier	\$1,450.00	\$1,390.00	\$1,320.00
	WITHOUT physical barrier	\$1,450.00	\$1,390.00	\$1,320.00

\* Pricing for counts of 24-48 hour duration. Counts of longer duration are subject to possible increased pricing.

**PRICE SHEET for Volume or Class Counts**

DISTRICT: 5 TYPE OF COUNTS (Circle) Volume Class SUBMITTER: Urbitran Associates, Inc.

**NOTE:** A separate Price Sheet must be completed for each District in which you wish to place a bid and for each type of count. Bidders must submit a bid price for every price tier and every roadway configuration below. Any bids not so complete will be determined to be non-responsive. **Prices/Bids are to include ALL costs** (including but not limited to travel expenses, benefits, overhead, profit, waste, un-acceptable counts, etc.). Multiple and simultaneous purchase orders from the same contracting agency are permissible.

ENTER YOUR PRICE FOR A **SINGLE** COUNT FOR EACH ROADWAY CONFIGURATION AND TIER.

Roadway Configuration		TIER (Number of Counts in Purchase Order)		
		1 to 20	21 to 100	101 to 300
TWO Lane	WITH physical barrier	\$370.00	\$350.00	\$330.00
	WITHOUT physical barrier	\$280.00	\$275.00	\$250.00
FOUR Lane	WITH physical barrier	\$450.00	\$425.00	\$400.00
	WITHOUT physical barrier	\$480.00	\$460.00	\$430.00
SIX Lane	WITH physical barrier	\$840.00	\$800.00	\$760.00
	WITHOUT physical barrier	\$680.00	\$650.00	\$610.00
EIGHT Lane	WITH physical barrier	\$890.00	\$850.00	\$800.00
	WITHOUT physical barrier	\$890.00	\$850.00	\$800.00

\* Pricing for counts of 24-48 hour duration. Counts of longer duration are subject to possible increased pricing.

## PRICE SHEET for Manual Counts

**SUBMITTER:** Gilmore & Associates, Inc.

**NOTE:** Enter a price only in the District(s) in which you are willing to take manual counts; prices may vary by District.

**Prices/Bids are to include ALL costs** (including but not limited to travel expenses, benefits, overhead, profit, waste, un-acceptable counts, etc.).

District	Hourly price per person
1	N/A
2	N/A
3	N/A
4	N/A
5	\$340.00
6	\$260.00
8	N/A
9	N/A
10	N/A
11	N/A
12	N/A

**PRICE SHEET for Volume or Class Counts**

DISTRICT: 5-0 TYPE OF COUNTS (Circle) Volume Class SUBMITTER: Gilmore & Assoc., Inc.

**NOTE:** A separate Price Sheet must be completed for each District in which you wish to place a bid and for each type of count. Bidders must submit a bid price for every price tier and every roadway configuration below. Any bids not so complete will be determined to be non-responsive. **Prices/Bids are to include ALL costs** (including but not limited to travel expenses, benefits, overhead, profit, waste, un-acceptable counts, etc.). Multiple and simultaneous purchase orders from the same contracting agency are permissible.

ENTER YOUR PRICE FOR A **SINGLE** COUNT FOR EACH ROADWAY CONFIGURATION AND TIER.

Roadway Configuration		TIER (Number of Counts in Purchase Order)		
		1 to 20	21 to 100	101 to 300
TWO Lane	WITH physical barrier	\$1,600.00	\$3,200.00	\$4,800.00
	WITHOUT physical barrier	\$1,400.00	\$2,800.00	\$4,200.00
FOUR Lane	WITH physical barrier	\$1,600.00	\$3,200.00	\$4,800.00
	WITHOUT physical barrier	\$1,400.00	\$2,800.00	\$4,200.00
SIX Lane	WITH physical barrier	\$2,300.00	\$4,600.00	\$6,900.00
	WITHOUT physical barrier	\$1,800.00	\$3,600.00	\$5,400.00
EIGHT Lane	WITH physical barrier	\$2,300.00	\$4,600.00	\$6,900.00
	WITHOUT physical barrier	\$1,800.00	\$3,600.00	\$5,400.00

**PRICE SHEET for Volume or Class Counts**DISTRICT: 5-0 TYPE OF COUNTS (Circle) Volume Class SUBMITTER: Gilmore & Assoc., Inc.

**NOTE:** A separate Price Sheet must be completed for each District in which you wish to place a bid and for each type of count. Bidders must submit a bid price for every price tier and every roadway configuration below. Any bids not so complete will be determined to be non-responsive. **Prices/Bids are to include ALL costs** (including but not limited to travel expenses, benefits, overhead, profit, waste, un-acceptable counts, etc.). Multiple and simultaneous purchase orders from the same contracting agency are permissible.

ENTER YOUR PRICE FOR A **SINGLE** COUNT FOR EACH ROADWAY CONFIGURATION AND TIER.

Roadway Configuration		TIER (Number of Counts in Purchase Order)		
		1 to 20	21 to 100	101 to 300
TWO Lane	WITH physical barrier	\$1,600.00	\$3,200.00	\$4,800.00
	WITHOUT physical barrier	\$1,400.00	\$2,800.00	\$4,200.00
FOUR Lane	WITH physical barrier	\$1,600.00	\$3,200.00	\$4,800.00
	WITHOUT physical barrier	\$1,400.00	\$2,800.00	\$4,200.00
SIX Lane	WITH physical barrier	\$2,300.00	\$4,600.00	\$6,900.00
	WITHOUT physical barrier	\$1,800.00	\$3,600.00	\$5,400.00
EIGHT Lane	WITH physical barrier	\$2,300.00	\$4,600.00	\$6,900.00
	WITHOUT physical barrier	\$1,800.00	\$3,600.00	\$5,400.00

**PRICE SHEET for Volume or Class Counts**

DISTRICT: 6-0 TYPE OF COUNTS (Circle) Volume Class SUBMITTER: Gilmore & Assoc., Inc.

**NOTE:** A separate Price Sheet must be completed for each District in which you wish to place a bid and for each type of count. Bidders must submit a bid price for every price tier and every roadway configuration below. Any bids not so complete will be determined to be non-responsive. **Prices/Bids are to include ALL costs** (including but not limited to travel expenses, benefits, overhead, profit, waste, un-acceptable counts, etc.). Multiple and simultaneous purchase orders from the same contracting agency are permissible.

ENTER YOUR PRICE FOR A **SINGLE** COUNT FOR EACH ROADWAY CONFIGURATION AND TIER.

Roadway Configuration		TIER (Number of Counts in Purchase Order)		
		1 to 20	21 to 100	101 to 300
TWO Lane	WITH physical barrier	\$1,400.00	\$2,800.00	\$4,200.00
	WITHOUT physical barrier	\$1,000.00	\$2,000.00	\$3,000.00
FOUR Lane	WITH physical barrier	\$1,400.00	\$2,800.00	\$4,200.00
	WITHOUT physical barrier	\$1,000.00	\$2,000.00	\$3,000.00
SIX Lane	WITH physical barrier	\$1,800.00	\$3,600.00	\$5,400.00
	WITHOUT physical barrier	\$1,400.00	\$2,800.00	\$4,200.00
EIGHT Lane	WITH physical barrier	\$1,800.00	\$3,600.00	\$5,400.00
	WITHOUT physical barrier	\$1,400.00	\$2,800.00	\$4,200.00

**PRICE SHEET for Volume or Class Counts**

DISTRICT: 6-0 TYPE OF COUNTS (Circle) Volume Class SUBMITTER: Gilmore & Assoc., Inc.

**NOTE:** A separate Price Sheet must be completed for each District in which you wish to place a bid and for each type of count. Bidders must submit a bid price for every price tier and every roadway configuration below. Any bids not so complete will be determined to be non-responsive. **Prices/Bids are to include ALL costs** (including but not limited to travel expenses, benefits, overhead, profit, waste, un-acceptable counts, etc.). Multiple and simultaneous purchase orders from the same contracting agency are permissible.

ENTER YOUR PRICE FOR A **SINGLE** COUNT FOR EACH ROADWAY CONFIGURATION AND TIER.

Roadway Configuration		TIER (Number of Counts in Purchase Order)		
		1 to 20	21 to 100	101 to 300
TWO Lane	WITH physical barrier	\$1,400.00	\$2,800.00	\$4,200.00
	WITHOUT physical barrier	\$1,000.00	\$2,000.00	\$3,000.00
FOUR Lane	WITH physical barrier	\$1,400.00	\$2,800.00	\$4,200.00
	WITHOUT physical barrier	\$1,000.00	\$2,000.00	\$3,000.00
SIX Lane	WITH physical barrier	\$1,800.00	\$3,600.00	\$5,400.00
	WITHOUT physical barrier	\$1,400.00	\$2,800.00	\$4,200.00
EIGHT Lane	WITH physical barrier	\$1,800.00	\$3,600.00	\$5,400.00
	WITHOUT physical barrier	\$1,400.00	\$2,800.00	\$4,200.00

**PRICE SHEET for Volume or Class Counts**DISTRICT: 6 TYPE OF COUNTS (Circle) Volume **Class** SUBMITTER: PET Corp

**NOTE:** A separate Price Sheet must be completed for each District in which you wish to place a bid and for each type of count. Bidders must submit a bid price for every price tier and every roadway configuration below. Any bids not so complete will be determined to be non-responsive. **Prices/Bids are to include ALL costs** (including but not limited to travel expenses, benefits, overhead, profit, waste, un-acceptable counts, etc.). Multiple and simultaneous purchase orders from the same contracting agency are permissible.

ENTER YOUR PRICE FOR A **SINGLE** COUNT FOR EACH ROADWAY CONFIGURATION AND TIER.

Roadway Configuration		TIER (Number of Counts in Purchase Order)		
		1 to 20	21 to 100	101 to 300
TWO Lane	WITH physical barrier	\$510	\$510	\$510
	WITHOUT physical barrier	\$510	\$510	\$510
FOUR Lane	WITH physical barrier	\$1020	\$1020	\$1020
	WITHOUT physical barrier	\$1020	\$1020	\$1020
SIX Lane	WITH physical barrier	\$1530	\$1530	\$1530
	WITHOUT physical barrier	\$1530	\$1530	\$1530
EIGHT Lane	WITH physical barrier	\$2040	\$2040	\$2040
	WITHOUT physical barrier	\$2040	\$2040	\$2040

**PRICE SHEET for Volume or Class Counts**DISTRICT: 8 TYPE OF COUNTS (Circle) Volume **Class** SUBMITTER: PET Corp

**NOTE:** A separate Price Sheet must be completed for each District in which you wish to place a bid and for each type of count. Bidders must submit a bid price for every price tier and every roadway configuration below. Any bids not so complete will be determined to be non-responsive. **Prices/Bids are to include ALL costs** (including but not limited to travel expenses, benefits, overhead, profit, waste, un-acceptable counts, etc.). Multiple and simultaneous purchase orders from the same contracting agency are permissible.

ENTER YOUR PRICE FOR A **SINGLE** COUNT FOR EACH ROADWAY CONFIGURATION AND TIER.

Roadway Configuration		TIER (Number of Counts in Purchase Order)		
		1 to 20	21 to 100	101 to 300
TWO Lane	WITH physical barrier	\$510	\$510	\$510
	WITHOUT physical barrier	\$510	\$510	\$510
FOUR Lane	WITH physical barrier	\$1020	\$1020	\$1020
	WITHOUT physical barrier	\$1020	\$1020	\$1020
SIX Lane	WITH physical barrier	\$1530	\$1530	\$1530
	WITHOUT physical barrier	\$1530	\$1530	\$1530
EIGHT Lane	WITH physical barrier	\$2040	\$2040	\$2040
	WITHOUT physical barrier	\$2040	\$2040	\$2040

**PRICE SHEET for Volume or Class Counts**

DISTRICT: 9 TYPE OF COUNTS (Circle) Volume **Class** SUBMITTER: PET Corp

**NOTE:** A separate Price Sheet must be completed for each District in which you wish to place a bid and for each type of count. Bidders must submit a bid price for every price tier and every roadway configuration below. Any bids not so complete will be determined to be non-responsive. **Prices/Bids are to include ALL costs** (including but not limited to travel expenses, benefits, overhead, profit, waste, un-acceptable counts, etc.). Multiple and simultaneous purchase orders from the same contracting agency are permissible.

ENTER YOUR PRICE FOR A **SINGLE** COUNT FOR EACH ROADWAY CONFIGURATION AND TIER.

Roadway Configuration		TIER (Number of Counts in Purchase Order)		
		1 to 20	21 to 100	101 to 300
TWO Lane	WITH physical barrier	\$510	\$510	\$510
	WITHOUT physical barrier	\$510	\$510	\$510
FOUR Lane	WITH physical barrier	\$1020	\$1020	\$1020
	WITHOUT physical barrier	\$1020	\$1020	\$1020
SIX Lane	WITH physical barrier	\$1530	\$1530	\$1530
	WITHOUT physical barrier	\$1530	\$1530	\$1530
EIGHT Lane	WITH physical barrier	\$2040	\$2040	\$2040
	WITHOUT physical barrier	\$2040	\$2040	\$2040

**PRICE SHEET for Volume or Class Counts**

DISTRICT: 11 TYPE OF COUNTS (Circle) Volume **Class** SUBMITTER: PET Corp

**NOTE:** A separate Price Sheet must be completed for each District in which you wish to place a bid and for each type of count. Bidders must submit a bid price for every price tier and every roadway configuration below. Any bids not so complete will be determined to be non-responsive. **Prices/Bids are to include ALL costs** (including but not limited to travel expenses, benefits, overhead, profit, waste, un-acceptable counts, etc.). Multiple and simultaneous purchase orders from the same contracting agency are permissible.

ENTER YOUR PRICE FOR A **SINGLE** COUNT FOR EACH ROADWAY CONFIGURATION AND TIER.

Roadway Configuration		TIER (Number of Counts in Purchase Order)		
		1 to 20	21 to 100	101 to 300
TWO Lane	WITH physical barrier	\$510	\$510	\$510
	WITHOUT physical barrier	\$510	\$510	\$510
FOUR Lane	WITH physical barrier	\$1020	\$1020	\$1020
	WITHOUT physical barrier	\$1020	\$1020	\$1020
SIX Lane	WITH physical barrier	\$1530	\$1530	\$1530
	WITHOUT physical barrier	\$1530	\$1530	\$1530
EIGHT Lane	WITH physical barrier	\$2040	\$2040	\$2040
	WITHOUT physical barrier	\$2040	\$2040	\$2040

**PRICE SHEET for Volume or Class Counts**

DISTRICT: 12 TYPE OF COUNTS (Circle) Volume **Class** SUBMITTER: PET Corp

**NOTE:** A separate Price Sheet must be completed for each District in which you wish to place a bid and for each type of count. Bidders must submit a bid price for every price tier and every roadway configuration below. Any bids not so complete will be determined to be non-responsive. **Prices/Bids are to include ALL costs** (including but not limited to travel expenses, benefits, overhead, profit, waste, un-acceptable counts, etc.). Multiple and simultaneous purchase orders from the same contracting agency are permissible.

ENTER YOUR PRICE FOR A **SINGLE** COUNT FOR EACH ROADWAY CONFIGURATION AND TIER.

Roadway Configuration		TIER (Number of Counts in Purchase Order)		
		1 to 20	21 to 100	101 to 300
TWO Lane	WITH physical barrier	\$510	\$510	\$510
	WITHOUT physical barrier	\$510	\$510	\$510
FOUR Lane	WITH physical barrier	\$1020	\$1020	\$1020
	WITHOUT physical barrier	\$1020	\$1020	\$1020
SIX Lane	WITH physical barrier	\$1530	\$1530	\$1530
	WITHOUT physical barrier	\$1530	\$1530	\$1530
EIGHT Lane	WITH physical barrier	\$2040	\$2040	\$2040
	WITHOUT physical barrier	\$2040	\$2040	\$2040

Contract Number 9985-27  
Change Number: 1  
Change Effective Date: IMMEDIATLY

COMMONWEALTH OF PENNSYLVANIA  
DEPARTMENT OF GENERAL SERVICES  
HARRISBURG

For: ALL USING COMMONWEALTH AGENCIES  
Subject: TRAFFIC COUNT SERVICES  
Contract Period: Effective date of April1, 2003 and Termination date of March 31, 2005.  
Buyer Name: B23/NORM KEE 717 787 7675

CHANGE SUMMARY: Line # 7 Tri-State Traffic Data, Inc. Service Code 9999-4350-014 has agreed to sell the awarded items at the same prices and /or discounts to local public procurement units in accordance with the contractual terms and conditions as amended by Act 142 of 2002.

ALL OTHER TERMS AND CONDITIONS OF THIS AGREEMENT WHICH ARE NOT CHANGED BY THIS AMENDMENT REMAIN IN FULL FORCE AND EFFECT.

Contract Number 9985-27  
Change Number: 2  
Change Effective Date: 10/07/2004

COMMONWEALTH OF PENNSYLVANIA  
DEPARTMENT OF GENERAL SERVICES  
HARRISBURG

For: ALL USING COMMONWEALTH AGENCIES  
Subject: TRAFFIC COUNT SERVICES  
Contract Period: Effective date of April 1, 2003 and Termination date of March 31, 2005.  
Buyer Name: B23/NORM KEE 717 787 7675

CHANGE SUMMARY: Line # 2 Computerized Traffic Data, Inc. VIN # 183578 Purch. Doc # 4600007760 has changed their address to: 14286 Beach Blvd. Suite 19-355, Jacksonville, FL 32250-1568 phone and fax number remain the same.

ALL OTHER TERMS AND CONDITIONS OF THIS AGREEMENT WHICH ARE NOT CHANGED BY THIS AMENDMENT REMAIN IN FULL FORCE AND EFFECT.

Contract Number 9985-27  
Collective Number: None  
Change Number: 3  
Change Effective Date: March 1, 2005

COMMONWEALTH OF PENNSYLVANIA  
DEPARTMENT OF GENERAL SERVICES  
HARRISBURG

For: ALL USING COMMONWEALTH AGENCIES  
Subject: TRAFFIC COUNT SERVICES  
Contract Period: Effective date of April 1, 2003 and Termination date of March 31, 2005.  
Buyer Name: B23/NORM KEE 717 787 7675

CHANGE SUMMARY:

Paragraph 13 and 15 listed on pages 5 and 6 of the contract are changed because the method for data collection is moving from CD Disk format to internet format.

13. All counts on State Routes (SR) must be submitted in a format identical to the output for PennDOT's iTDUS web application, specifically the Volume Count Record Layout. The format is detailed in **Exhibit B**. The iTDUS web application may be obtained from PennDOT's Bureau of Planning and Research's website at [www.dot.state.pa.us](http://www.dot.state.pa.us) starting March 1, 2005

15. All counts on State Routes (SR) must be submitted in a format identical to the output for PennDOT's iTDUS web application, specifically the Machine Vehicle Classification Count Record Layout. The format is detailed in **Exhibit C**. The iTDUS web application may be obtained from PennDOT's Bureau of Planning and Research's website at [www.dot.state.pa.us](http://www.dot.state.pa.us) starting March 1, 2005.

ALL OTHER TERMS AND CONDITIONS OF THIS AGREEMENT WHICH ARE NOT CHANGED BY THIS AMENDMENT REMAIN IN FULL FORCE AND EFFECT.

Contract Number 9985-27  
Collective Number: None  
Change Number: 4  
Change Effective Date: March 1, 2005

COMMONWEALTH OF PENNSYLVANIA  
DEPARTMENT OF GENERAL SERVICES  
HARRISBURG

**For:** ALL USING COMMONWEALTH AGENCIES  
**Subject:** TRAFFIC COUNT SERVICES  
**Contract Period:** Effective date of April 1, 2003 and Termination date of March 31, 2005. (Renewed  
Through March 31, 2006)

**Buyer Name:** B23/NORM KEE 717 787 7675

**CHANGE SUMMARY:** In accordance with the Option to Renew clause ALL suppliers have renewed from  
April 1, 2005 through March 31, 2006.

**OTHER CHANGES:** GAI Consultants, Inc. has changed their address to: 385 East Waterfront Drive, Homestead, PA.  
15120-5005. New Phone # 412-476-2000 ext. 1722; New Fax # 412-476-2020;

ALL OTHER TERMS AND CONDITIONS OF THIS AGREEMENT WHICH ARE NOT CHANGED BY THIS AMENDMENT REMAIN IN  
FULL FORCE AND EFFECT.

Contract Reference Number: 9985-27  
Collective Number: None  
Change Number: 5  
Change Effective Date: August 23, 2005

**COMMONWEALTH OF PENNSYLVANIA  
DEPARTMENT OF GENERAL SERVICES  
HARRISBURG**

**For:** ALL USING COMMONWEALTH AGENCIES  
**Subject:** TRAFFIC COUNT SERVICES  
**Contract Period:** Effective date of April 1, 2003 and Termination date of  
March 31, 2005. (Renewed through March 31, 2006)

**Buyer Name:** XF4/SYLINE M. SHINGARA (717) 346-3833

**CHANGE SUMMARY:** EFFECTIVE IMMEDIATELY ALL INQUIRES RELEVANT TO THIS CONTRACT SHALL BE DIRECTED TO SYLINE M. SHINGARA, COMMODITY SPECIALIST, DEPARTMENT OF GENERAL SERVICES, BUREAU OF PROCUREMENT, SERVICES DIVISION.

ALL OTHER TERMS AND CONDITIONS OF THIS AGREEMENT NOT CHANGED BY THIS CHANGE NOTICE REMAIN AS ORGINALLY WRITTEN.

Contract Reference Number: 9985-27  
Collective Number: None  
SAP Contract Number (s):  
4600007760  
4600007761  
4600007762  
4600007763  
4600007765  
4600007766  
4600007767  
4600007768  
4600007769  
4600007770  
4600009517

Change Number: 6

**Change Effective Date: December 22, 2005**

**COMMONWEALTH OF PENNSYLVANIA  
DEPARTMENT OF GENERAL SERVICES  
HARRISBURG**

**FOR:** ALL USING COMMONWEALTH AGENCIES

**SUBJECT:** TRAFFIC COUNT SERVICES

**CONTRACT PERIOD:** EFFECTIVE DATE APRIL 1, 2003 THRU  
MARCH 31, 2007 (RENEWED THROUGH  
MARCH 31, 2007)

**COMMODITY SPECIALIST:** XF4/SYLINE M. SHINGARA  
PHONE: (717) 346-3833  
FAX: (717) 214-9505

**CHANGE SUMMARY:** IN ACCORDANCE WITH THE **OPTION TO RENEW CLAUSE**, THE COMMONWEALTH, BY MUTUAL  
CONSENT OF **ALL SUPPLIERS** HAVE RENEWED FOR THE 2<sup>ND</sup> RENEWAL PERIOD **EFFECTIVE  
APRIL 1, 2006 THRU MARCH 31, 2007.**

THE ITEM LIST & SUPPLIER LIST INFORMATION HAS BEEN UPDATE ON THE COMMONWEALTH OF  
PENNSYLVANIA, DEPARTMENT OF GENERAL SERVICES WEBSITE AT [www.dgs.state.pa.us](http://www.dgs.state.pa.us)  
**EFFECTIVE IMMEDIATELY.**

**ALL OTHER TERMS AND CONDITIONS OF THIS AGREEMENT WHICH, ARE NOT CHANGED BY  
THIS AMENDMENT, REMAIN IN FULL FORCE AND EFFECT.**

**CONTRACTOR LIST**

The contractor(s) identified by "YES" in the Act 57 column have agreed to sell the awarded item(s) at the same prices and/or discounts, and in accordance with the contractual terms and conditions, to local public procurement units, which elect to participate in the contract. A "local public procurement unit" is defined as: any political subdivision; public authority; educational, health, or other institution; and to the extent provided by law, any other entity, including a council of governments or an area government; nonprofit fire, rescue, or ambulance company; and any nonprofit corporation operating a charitable hospital. Unless otherwise specified below, payment terms are Net 30 days.

Act 57	CONTRACTOR EIN & VENDOR ID #s	SAP OUTLINE AGREEMENT #	CONTRACTOR NAME/ADDRESS	TELEPHONE NUMBER	FAX NUMBER	CONTACT PERSON
YES	52-1391057 <b>SAP #199427</b>	4600007770	THE TRAFFIC GROUP, INC. 9900 FRANKLIN SQUARE DRIVE SUITE "H" BALTIMORE, MARYLAND 21236-5915	(410) 931-6600	(410) 931-6601	DONALD HAYES dhayes@trafficgroup.com
YES	59-2835963 <b>SAP # 183578</b>	4600007760	COMPUTERIZED TRAFFIC DATA, INC. 14286 BEACH BOULEVARD SUITE 19-355 JACKSONVILLE, FLORIDA 32250-1568	(904) 673-6806	(904) 223-0021	MICHAEL LOWRY hmichaellowry@comcast.net
YES	36-3467928 <b>SAP # 162863</b>	4600007761	JOHN J. CLARK & ASSOCIATES 5933 BAUM BOULEVARD PITTSBURGH, PA 15206-3807	(412) 361-3200	(412) 361-3319	JOHN J. CLARK jjca5933@aol.com
YES	34-1830939 <b>SAP # 185620</b>	4600007762	COUNT ELECTRONICS P O BOX 30 7166 DEERVILLE AVENUE UHRICHSVILLE, OHIO 46583-0030	(740) 922-3183	(740) 922-3183	TODD M RENICKER countelectronics@earthlink.net
YES	25-1260999 <b>SAP # 150549</b>	4600007763	GAI CONSULTANTS, INC. 385 EAST WATERFRONT DRIVE HOMESTEAD, PA 15120-5005	(412) 476-2000	(412) 476-2020	DAVID F. KUNDRAT d.kundrat@gaiconsultants.com

YES	54-1553636 <b>SAP # 199420</b>	4600007764	MCV ASSOCIATES, INC. 4605-C PINECREST OFFICE PARK DRIVE ALEXANDRIA, VIRGINIA 22312-1442	(703) 914-4850	(703) 914-4865	JAWAHAR MEHARA jmehra@mvinc.com
YES	23-2843075 <b>SAP # 134600</b>	4600007765	TRI-STATE TRAFFIC DATA 184 BAKER ROAD COATSVILLE, PA 19320-1402	(610) 466-1469	(610) 466-1470	PATRICK J. FIORE tstdata@aol.com
YES	23-2462387 <b>SAP # 128483</b>	4600007766	MCMAHON ASSOCIATES, INC. 425 COMMERCE DRIVE SUITE 200 FORT WASHINGTON, PA 19034-2713	(215) 283-9444	(215) 283-9445	JOSEPH J. DESANTIS Joe.desantis@mcmtrans.com
YES	23-2553315 <b>SAP # 128483</b>	4600007767	TRANSPORTATION RESOURCE GROUP, INC. 204 NORTH GEORGE STREET SUITE 110 YORK, PA 17401-1108	(717) 846-4660	(717) 846-4858	JON A. SIETZ jseitz@trgyorkpa.com
YES	13-5429150 <b>SAP # 197783</b>	4600007768	URBITRAN 150 RIVER ROAD BUILDING "E" MONTVILLE, NEW JERSEY 07045- 9421	(973) 299-2910 Ext. 202	(973) 299-0347	GARY W. DAVIES gdavies@urbitran.com
YES	52-1733642 <b>SAP # 196289</b>	4600007769	PROGRESSIVE ENGINEERING TECHNOLOGIES CORPORATION 6660-H DOBBIN ROAD COLUMBIA, MARYLAND 21045-4844	(410) 381-1995	(410) 381-7829	JOHN REED jreed@petcorp.com
YES	23-1992323 <b>SAP # 201700- 001</b>	4600009517	GILMORE & ASSOCIATES, INC. 350 EAST BUTLER AVENUE NEW BRITAIN, PA 18901-5209	(215) 345-4330	(215) 345-8606	ERIC M. KAUFMAN ekaufman@Gilmore-Assoc.com

**TRAFFIC COUNT SERVICES  
ITEM SHEET**

ITEM NO.	SAP VENDOR NUMBER & CONTRACT NUMBER	PRICE LIST EFFECTIVE DATE AND AREAS OF SERVICE	COMPANY NAME	FIN #
1.	SAP #199427 4600007770	District Coverage: 6 & 8 For Volume, Class and Manual See attached Price Sheets	The Traffic Group Inc. 9900 Franklin Square Drive, Suite H Baltimore, Md. 21236-5915	52-1391057
2.	SAP # 183578 4600007760	District Coverage: All except 6 & 11 For Volume and Class Manual: <u>ALL DISTRICTS</u> See attached Price Sheets	Computerized Traffic Data Inc. 14286 Beach Blvd. Ste 19-355 Jacksonville, FLA. 32250-1568	59-2835963
3.	SAP # 162863 4600007761	District Coverage: 1,9,10,11 & 12 <u>MANUAL ONLY</u> See attached Price Sheets	John J. Clark & Associates 5933 Baum Blvd. Pittsburgh, PA. 15206-3807	36-3467928
4.	SAP # 185620 4600007762	District Coverage: ALL For <u>Volume</u> and <u>Manual</u> See attached Price Sheets	Count Electronics P. O. Box 30 7166 Deerville Ave Uhrichsville, OH. 44683-0030	34-1830939
5.	SAP # 150549 4600007763	District Coverage: 1, 10, 11 & 12 For Volume, Class & Manual See attached Price Sheets	GAI Consultants, Inc. 385 East Waterfront Drive Homestead, PA 15120-5005	25-1260999
6.	SAP # 199420 4600007764	District Coverage: ALL For <u>Volume</u> and <u>Manual</u> See attached Price Sheets	MCV Associates, Inc. 4605-C Pinecrest Office Park Drive Alexandria, VA. 22312	54-1553636

**TRAFFIC COUNT SERVICES  
ITEM SHEET**

7.	SAP # 134600 4600007765	<b>District Coverage: ALL For Volume, Class &amp; Manual See attached Price Lists</b>	<b>Tri-State Traffic Data, Inc. 184 Baker Road Coatesville, PA. 19320-1402</b>	<b>23-2843075</b>
8.	SAP # 128483 4600007766	<b>District Coverage: 4, 5, 6 &amp; 8 For Volume, Class &amp; Manual See attached Price Sheets</b>	<b>McMahon Associates, Inc. 425 Commerce Drive Suite 200 Fort Washington, PA. 19034-2713</b>	<b>23-2462387</b>
9.	SAP # 184714 4600007767	<b>District Coverage: 3, 5, 6, 8 &amp; 9 For Volume, Class &amp; Manual See attached Price Sheets</b>	<b>Transportation Resource Group, Inc. 204 N. George Street, Suite 110 York, PA. 17401-1108</b>	<b>23-2553315</b>
10.	SAP # 197783 4600007768	<b>District Coverage: 3, 4, &amp; 5 For Volume &amp; Class See attached Price Sheets</b>	<b>URBITRAN 150 River Road, Bldg. E Montville, N.J. 07045-9421</b>	<b>13-5429150</b>
11.	SAP # 201700-001 4600009517	<b>District Coverage: 5 &amp; 6 For Volume, Class &amp; Manual See attached Price Sheets</b>	<b>Gilmore &amp; Associates, Inc. 350 East Butler Avenue New Britain, PA. 18901-5209</b>	<b>23-1992323</b>
12.	SAP # 197783 4600007769	<b>District Coverage: 6, 8, 9, 11 &amp; 12 For Class Counts only See attached Price Sheets</b>	<b>Progressive Engineering Technologies Corp. (PET) 6660-H Dobbin Road Columbia, MD. 21045-4844</b>	<b>52-1733642</b>

Contract Reference Number: 9985-27  
Collective Number: None  
SAP Contract Number (s):  
4600007760  
4600007761  
4600007762  
4600007763  
4600007765  
4600007766  
4600007767  
4600007768  
4600007769  
4600007770  
4600009517

Change Number: 7

**Change Effective Date: December 23, 2005**

**COMMONWEALTH OF PENNSYLVANIA  
DEPARTMENT OF GENERAL SERVICES  
HARRISBURG**

**FOR:** ALL USING COMMONWEALTH AGENCIES

**SUBJECT:** TRAFFIC COUNT SERVICES

**CONTRACT PERIOD:** EFFECTIVE DATE APRIL 1, 2003 THRU  
MARCH 31, 2007 (RENEWED THROUGH  
MARCH 31, 2007)

**COMMODITY SPECIALIST:** XF4/SYLINE M. SHINGARA  
PHONE: (717) 346-3833  
FAX: (717) 214-9505

**CHANGE SUMMARY:** CHANGED MATERIAL GROUP NUMBER FOR MANUAL/VOLUME/CLASS COUNTS FROM  
MATERIAL GROUP #72130000 – GENERAL BUILDING CONSTRUCTION TO  
MATERIAL GROUP #81102201 – TRAFFIC ENGINEERING EFFECTIVE IMMEDIATELY.

**ALL OTHER TERMS AND CONDITIONS OF THIS AGREEMENT WHICH, ARE NOT CHANGED BY  
THIS AMENDMENT, REMAIN IN FULL FORCE AND EFFECT.**

Contract Reference Number: **9985-27**  
Collective Number:  
SAP Contract Number: **4600007762**  
Change Number: **8**  
Change Effective Date: **JANUARY 30, 2006**

**COMMONWEALTH OF PENNSYLVANIA  
DEPARTMENT OF GENERAL SERVICES  
HARRISBURG**

**For:** ALL USING COMMONWEALTH AGENCIES  
**Subject:** TRAFFIC COUNT SERVICES  
**Contract Period:** JANUARY 30, 2006 THRU MARCH 31, 2007  
**Buyer Name:** XF4/SYLINE M. SHINGARA  
**Phone:** (717) 346-3833  
**FAX:** (717) 214-9505

**CHANGE SUMMARY:**

**ADDED VEHICLE CLASSIFICATION COUNTS FOR PENN DOT DISTRICTS:  
#1; #2; #3; #5; #8; #9; #10; #11 AND #12, TO COUNT ELECTRONICS CONTRACT #4600007762,  
EFFECTIVE JANUARY 30, 2006 THRU MARCH 31, 2007.**

**REFER TO DGS WEBSITE: <http://www.dgsweb.state.pa.us/comod/contract.asp?dgsNav=|5053|>  
FOR PRICE SHEETS.**

**ALL OTHER TERMS AND CONDITIONS OF THIS AGREEMENT WHICH ARE NOT CHANGED BY THIS  
AMENDMENT, REMAIN IN FULL FORCE AND EFFECT.**

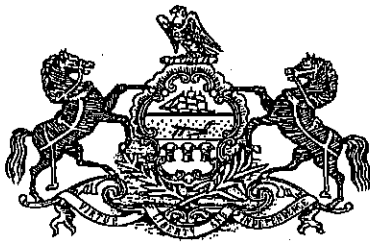

All using Agencies of the Commonwealth, Political Subdivision,  
 Authorities, Private Colleges and Universities

ORIGINAL Page 1 / 1  
 Contract Number: 4600007762  
 Creation Date: 10/07/2004

Purchasing Agent:  
 Name: Norman Kee  
 Phone: 717-346-3833  
 Fax: 717 346-3820  
 E-mail: nkee@state.pa.us  
 Valid from/to: 04/01/2003 - 03/31/2007

Your vendor number with us: 185620

Vendor Name/Address:  
 TODD M RENICKER  
 DBA COUNT ELECTRONICS  
 PO Box 30  
 UHRICHSVILLE OH 44683-0030  
  
 Vendor Fax Number: 740-922-3183

Please Deliver To:  
  
 \*\*\* TBD AT TIME OF PURCHASE ORDER \*\*\*  
  
 \*\*\* UNLESS SPECIFIED BELOW \*\*\*

Your Quotation: \_\_\_\_\_ Date: \_\_\_\_\_  
 Collective No.: \_\_\_\_\_  
 Our Quotation: \_\_\_\_\_

Payment Terms: NET 30

The Commonwealth of Pennsylvania, through the Department of General Services, accepts the submission of the Bidder/Contractor for the awarded item(s) at the price(s) set forth below in accordance with: 1) the RFQ submitted by the Bidder/Contractor, if any; 2) the documents attached to this Contract or incorporated by reference, if any, and 3) the contract terms and conditions stored on the website address at www.dgs.state.pa.us for this type of Contract as of the date of the RFQ, if any, or other solicitation for this Contract, all of which, as appropriate, are incorporated herein by reference. When the Bidder/Contractor receives an order from a Commonwealth agency, the order constitutes the Bidder/Contractor's authority to furnish the item(s) to the agency at the time(s) and place(s) specified in the order. RFQ, as used herein, means Request for Quotations, Invitation for Bids, Invitation to Qualify, or Request for Proposals, as appropriate.

Item Description Material/Service No.	Quantity UOM	Price	Per Unit	TOTAL
00010 Manual Counts	0.000 h	1.00	h	0.00
00020 Volume	0 EA	1.00	EA	0.00
00030 Class	0 EA	1.00	EA	0.00

-----SUPPLEMENTAL INFORMATION-----

Header text  
 REFER TO DEPARTMENT OF GENERAL SERVICES  
 WEBSITE FOR PRICE SHEETS.

NO FURTHER INFORMATION FOR THIS CONTRACT

Currency: USD  
  
999,999,999.00  
 \*\*\*ESTIMATED VALUE\*\*\*

Count Electronics  
P.O. Box 30  
Uhrichsville, Ohio 44683  
(740) 922-3183

Todd M. Renicker  
Owner

Fax Cover Sheet

Date 1/13/2006

To: Sylvie M. Shingara

Fax# 717-214-9505

Phone: 717-346-3833

From: Todd M. Renicker Count Electronics

# Pages in Fax: 13 (Incl. Cover)

Comments: Dear Sylvie,

Here is our pricing for class counts.

Thanks  
Todd

**COUNT ELECTRONICS**  
**P.O. Box 30**  
**Uhrichsville, Ohio 44683**  
**(740) 922-3183**

**Todd M. Renicker**  
**Owner**



Jan. 13, 2006.

Commonwealth of Pennsylvania  
Department of General Services  
Attn: Syline M. Shingara - Commodity Specialist  
555 Walnut Street  
Forum Place, 6<sup>th</sup>. Floor  
Harrisburg, PA. 17101

Dear Syline,

Count Electronics would like to submit pricing for Classification Counting in the Commonwealth of Pennsylvania. We are currently listed to do Volume and Manual Counts under SAP Contract # 4600007762 under Vendor # 185620. We have reviewed Page 1, of The Special Contract Terms and Conditions as suggested to us by Andrea Bahoric, Penn Dot Representative. We will submit this page with our pricing for class counts. It has the provision for piggybacking off of this contract and our current address for purchase orders.

If there are anymore requirements please let us know.

Looking forward to hearing from you,

Todd M. Renicker - Owner  
Count Electronics  
740-922-3183 Phone and Fax

Department of General Services  
GSPUR138 Rev. 11/19/02

**TRAFFIC COUNT SERVICES**

**SPECIAL CONTRACT TERMS AND CONDITIONS**

**CONTRACT SCOPE/OVERVIEW:** This Contract No. 9985-27 (identified here and in the other documents as the "Contract") will cover the requirements of Commonwealth agencies for "Traffic Count Services". Agencies may select one (1) or more Contractors, as needed to full-fill their requirements.

**ORDER OF PRECEDENCE:** These Special Contract Terms and Conditions supplement the Standard Contract Terms and Conditions For Statewide Contracts for Supplies. To the extent that these Special Contract Terms and Conditions conflict with the Standard Contract Terms and Conditions For Statewide Contracts for Supplies, these Special Contract Terms and Conditions shall prevail.

**TERM OF CONTRACT:** The Contract shall commence on the Effective Date, which shall be no earlier than April 1, 2003 and expire on March 31, 2005.

**OPTION TO EXTEND:** The Department of General Services reserves the right, upon notice to the Contractor, to extend the Contract or any part of the Contract for up to three (3) months upon the same terms and conditions. This will be utilized to prevent a lapse in Contract coverage and only for the time necessary, up to three (3) months, to enter into a new contract.

**OPTION FOR SEPARATE COMPETITIVE BIDDING PROCEDURE:** The Department of General Services reserves the right to purchase supplies covered under this Contract through a separate competitive bidding procedure, whenever the department deems it to be in the best interest of the Commonwealth. The right will generally be exercised only when a specific need for a large quantity of the supply exists or the price offered is significantly lower than the Contract price.

**E-CATALOG:** The Commonwealth may require the awarded bidder(s) to supply its price list/catalog and any updated price lists/catalogs in electronic format. Price lists/catalogs must be provided in one of the following formats: Word document, Excel spreadsheet, or PDF file on 3.5-inch diskette or CD-ROM.

**PROVISIONS FOR PIGGYBACKING OFF OF THIS CONTRACT:** Act 57 of May 15, 1998 permits local public procurement units to participate in those contracts for supplies, services, or construction entered into by the Department of General Services that are made available to local public procurement units. A "local public procurement unit" is defined as: any political subdivision; public authority; educational, health, or other institution; and to the extent provided by law, any other entity, including a council of governments or an area government; nonprofit fire, rescue or ambulance company; and any nonprofit corporation operating a charitable hospital. Local public procurement units which elect to participate in the contract will order items directly from the contractor and will be responsible for payment directly to the contractor.

Those local public procurement units listed above which issue orders under the contract are intended beneficiaries under the contract and are real parties in interest with the right to sue and be sued without joining the Commonwealth of Pennsylvania Department of General Services as a party.

If your firm is awarded a contract, does it agree to sell the awarded items at the same prices and/or discounts, and in accordance with the contractual terms and conditions, to local public procurement units which elect to participate in the contract?

Please Answer: YES  X  NO \_\_\_\_\_

**ADDRESS OF PURCHASE ORDER:** Commonwealth agencies may issue purchase orders against this Contract for supplies required by the agencies (using agencies). Please state below where the Purchase Orders should be sent (name, address, city, state, zip code).

Count Electronics  
P.O. Box 30  
Urichville, OH. 44683

## PRICE SHEET FOR CLASS COUNTS

DISTRICT : 1 TYPE OF COUNTS: CLASS SUBMITTER: COUNT ELECTRONICS

Roadway Configuration

TIER { Number of Counts in Purchase Order }

District: 1

1 to 20

21 to 100

101 to 300

2 lane class	\$ 240.00	\$ 210.00	\$ 180.00
2 lane class w/barrier	\$ 240.00	\$ 210.00	\$ 180.00
4 lane class	\$ 350.00	\$ 325.00	\$ 325.00
4 lane class w/barrier	\$ 400.00	\$ 350.00	\$ 350.00
6 lane class	\$ 600.00	\$ 575.00	\$ 550.00
6 lane class w/barrier	\$ 850.00	\$ 775.00	\$ 670.00
8 lane class	\$ 1025.00	\$ 890.00	\$ 760.00
8 lane class w/barrier	\$ 1175.00	\$ 1100.00	\$ 1000.00

## PRICE SHEET FOR CLASS COUNTS

DISTRICT: 2 TYPE OF COUNTS: CLASS SUBMITTER: COUNT ELECTRONICS

Roadway Configuration

TIER { Number of Counts in Purchase Order }

District: 2

1 to 20

21 to 100

101 to 300

2 lane class	\$ 230.00	\$ 200.00	\$ 175.00
2 lane class w/barrier	\$ 230.00	\$ 200.00	\$ 175.00
4 lane class	\$ 375.00	\$ 340.00	\$ 340.00
4 lane class w/barrier	\$ 400.00	\$ 375.00	\$ 375.00
6 lane class	\$ 640.00	\$ 575.00	\$ 550.00
6 lane class w/barrier	\$ 880.00	\$ 770.00	\$ 655.00
8 lane class	\$ 875.00	\$ 870.00	\$ 800.00
8 lane class w/barrier	\$ 900.00	\$ 875.00	\$ 825.00

## PRICE SHEET FOR CLASS COUNTS

DISTRICT : 3 TYPE OF COUNTS: CLASS SUBMITTER: COUNT ELECTRONICS

Roadway Configuration

TIER { Number of Counts in Purchase Order }

District: 3

1 to 20

21 to 100

101 to 300

2 lane class	\$ 235.00	\$ 200.00	\$ 175.00
2 lane class w/barrier	\$ 235.00	\$ 200.00	\$ 175.00
4 lane class	\$ 375.00	\$ 300.00	\$ 275.00
4 lane class w/barrier	\$ 400.00	\$ 325.00	\$ 280.00
6 lane class	\$ 500.00	\$ 350.00	\$ 325.00
6 lane class w/barrier	\$ 550.00	\$ 375.00	\$ 350.00
8 lane class	\$ 850.00	\$ 825.00	\$ 800.00
8 lane class w/barrier	\$ 875.00	\$ 850.00	\$ 825.00

## PRICE SHEET FOR CLASS COUNTS

DISTRICT : 4 TYPE OF COUNTS: CLASS SUBMITTER: COUNT ELECTRONICS

Roadway Configuration

TIER { Number of Counts in Purchase Order }

District: 4

1 to 20

21 to 100

101 to 300

2 lane class	\$ 225.00	\$ 215.00	\$ 180.00
2 lane class w/barrier	\$ 225.00	\$ 215.00	\$ 180.00
4 lane class	\$ 380.00	\$ 300.00	\$ 275.00
4 lane class w/barrier	\$ 400.00	\$ 325.00	\$ 280.00
6 lane class	\$ 550.00	\$ 375.00	\$ 380.00
6 lane class w/barrier	\$ 575.00	\$ 380.00	\$ 400.00
8 lane class	\$ 850.00	\$ 800.00	\$ 700.00
8 lane class w/barrier	\$ 875.00	\$ 850.00	\$ 825.00

## PRICE SHEET FOR CLASS COUNTS

DISTRICT : 5 TYPE OF COUNTS: CLASS SUBMITTER: COUNT ELECTRONICS

Roadway Configuration

TIER { Number of Counts in Purchase Order }

District: 5

1 to 20

21 to 100

101 to 300

2 lane class	\$ 235.00	\$ 200.00	\$ 175.00
2 lane class w/barrier	\$ 235.00	\$ 200.00	\$ 180.00
4 lane class	\$ 375.00	\$ 300.00	\$ 280.00
4 lane class w/barrier	\$ 380.00	\$ 325.00	\$ 285.00
6 lane class	\$ 550.00	\$ 385.00	\$ 330.00
6 lane class w/barrier	\$ 575.00	\$ 390.00	\$ 345.00
8 lane class	\$ 885.00	\$ 850.00	\$ 825.00
8 lane class w/barrier	\$ 895.00	\$ 875.00	\$ 850.00

## PRICE SHEET FOR CLASS COUNTS

DISTRICT: 8 TYPE OF COUNTS: CLASS SUBMITTER: COUNT ELECTRONICS

Roadway Configuration

TIER { Number of Counts in Purchase Order }

District: 8

1 to 20

21 to 100

101 to 300

2 lane class	\$ 225.00	\$ 190.00	\$ 145.00
2 lane class w/barrier	\$ 230.00	\$ 200.00	\$ 150.00
4 lane class	\$ 360.00	\$ 315.00	\$ 240.00
4 lane class w/barrier	\$ 395.00	\$ 320.00	\$ 245.00
6 lane class	\$ 580.00	\$ 390.00	\$ 340.00
6 lane class w/barrier	\$ 595.00	\$ 395.00	\$ 345.00
8 lane class	\$ 785.00	\$ 780.00	\$ 880.00
8 lane class w/barrier	\$ 795.00	\$ 785.00	\$ 890.00

## PRICE SHEET FOR CLASS COUNTS

DISTRICT : 9 TYPE OF COUNTS: CLASS SUBMITTER: COUNT ELECTRONICS

Roadway Configuration

TIER { Number of Counts in Purchase Order }

District: 9

1 to 20

21 to 100

101 to 300

2 lane class	\$ 225.00	\$ 195.00	\$ 145.00
2 lane class w/barrier	\$ 225.00	\$ 195.00	\$ 145.00
4 lane class	\$ 345.00	\$ 320.00	\$ 245.00
4 lane class w/barrier	\$ 395.00	\$ 325.00	\$ 250.00
6 lane class	\$ 580.00	\$ 380.00	\$ 325.00
6 lane class w/barrier	\$ 595.00	\$ 395.00	\$ 345.00
8 lane class	\$ 875.00	\$ 785.00	\$ 780.00
8 lane class w/barrier	\$ 895.00	\$ 795.00	\$ 785.00

## PRICE SHEET FOR CLASS COUNTS

DISTRICT : 10 TYPE OF COUNTS: CLASS SUBMITTER: COUNT ELECTRONICS

Roadway Configuration

TIER { Number of Counts in Purchase Order }

District: 10

1 to 20

21 to 100

101 to 300

2 lane class	\$ 225.00	\$ 195.00	\$ 145.00
2 lane class w/barrier	\$ 225.00	\$ 195.00	\$ 145.00
4 lane class	\$ 365.00	\$ 320.00	\$ 245.00
4 lane class w/barrier	\$ 395.00	\$ 325.00	\$ 250.00
6 lane class	\$ 580.00	\$ 380.00	\$ 325.00
6 lane class w/barrier	\$ 595.00	\$ 395.00	\$ 345.00
8 lane class	\$ 875.00	\$ 785.00	\$ 780.00
8 lane class w/barrier	\$ 895.00	\$ 795.00	\$ 785.00

## PRICE SHEET FOR CLASS COUNTS

DISTRICT : 11 TYPE OF COUNTS: CLASS SUBMITTER: COUNT ELECTRONICS

Roadway Configuration

TIER { Number of Counts in Purchase Order }

District: 11

1 to 20

21 to 100

101 to 300

2 lane class	\$ 280.00	\$ 200.00	\$ 140.00
2 lane class w/barrier	\$ 280.00	\$ 225.00	\$ 145.00
4 lane class	\$ 380.00	\$ 320.00	\$ 240.00
4 lane class w/barrier	\$ 390.00	\$ 325.00	\$ 245.00
6 lane class	\$ 580.00	\$ 380.00	\$ 325.00
6 lane class w/barrier	\$ 595.00	\$ 395.00	\$ 345.00
8 lane class	\$ 880.00	\$ 775.00	\$ 770.00
8 lane class w/barrier	\$ 895.00	\$ 790.00	\$ 785.00

## PRICE SHEET FOR CLASS COUNTS

DISTRICT : 12 TYPE OF COUNTS: CLASS SUBMITTER: COUNT ELECTRONICS

Roadway Configuration

TIER { Number of Counts in Purchase Order }

District: 12

1 to 20

21 to 100

101 to 300

2 lane class	\$ 225.00	\$ 195.00	\$ 145.00
2 lane class w/barrier	\$ 225.00	\$ 195.00	\$ 145.00
4 lane class	\$ 300.00	\$ 320.00	\$ 240.00
4 lane class w/barrier	\$ 395.00	\$ 325.00	\$ 245.00
6 lane class	\$ 580.00	\$ 380.00	\$ 325.00
6 lane class w/barrier	\$ 595.00	\$ 395.00	\$ 345.00
8 lane class	\$ 880.00	\$ 780.00	\$ 785.00
8 lane class w/barrier	\$ 895.00	\$ 790.00	\$ 795.00

Contract Reference Number: 9985-27  
Collective Number:  
SAP Contract Number: **460007762**  
Change Number: 9  
Change Effective Date: 11/13/2006

**COMMONWEALTH OF PENNSYLVANIA  
DEPARTMENT OF GENERAL SERVICES  
HARRISBURG**

**For:** All using Agencies of the Commonwealth  
**Subject:** TRAFFIC COUNT SERVICES  
**Contract Period:** JANUARY 30, 2006 THRU MARCH 31, 2007  
**Commodity Specialist Name:** James H. Kling

**CHANGE SUMMARY:\**  
**Commodity Specialist change from Syline Shingara to James Kling(XF5).**

ALL OTHER TERMS AND CONDITIONS OF THIS AGREEMENT NOT CHANGED BY THIS CHANGE NOTICE REMAIN AS ORIGINALLY WRITTEN.

Contract Reference Number: 9985-27  
Collective Number: N/A  
SAP Contract Number: 4600007760  
4600007761  
4600007762  
4600007763  
4600007765  
4600007766  
4600007767  
4600007768  
4600007769  
4600007770  
4600009517  
Change Number: 10

Change Effective Date: January 10, 2006

**COMMONWEALTH OF PENNSYLVANIA  
DEPARTMENT OF GENERAL SERVICES  
HARRISBURG**

**For:** All using Agencies of the Commonwealth  
**Subject:** Traffic Count Services  
**Contract Period:** Beginning April 1, 2003 and Ending March 31,  
2008 (by renewal)  
**Commodity Specialist Name:** James Kling, 717-703-2939, jkling@state.pa.us

**CHANGE SUMMARY:**

In accordance with the **option to renew clause**, the commonwealth, by mutual consent of **all** suppliers have renewed for the 3<sup>rd</sup> and final renewal period **effective April 1, 2007 thru March 31, 2008**.

**All other terms and conditions of this agreement which, are not changed by this amendment, remain in full force and effect.**

ALL OTHER TERMS AND CONDITIONS OF THIS AGREEMENT NOT CHANGED BY THIS CHANGE NOTICE REMAIN AS ORIGINALLY WRITTEN.

Contract Reference Number: 9985-27  
Collective Number: N/A  
SAP Contract Number: 4600007760  
Change Number: 11  
Change Effective Date: January 10, 2006

**COMMONWEALTH OF PENNSYLVANIA  
DEPARTMENT OF GENERAL SERVICES  
HARRISBURG**

**For:** All using Agencies of the Commonwealth  
**Subject:** Traffic Count Services  
**Contract Period:** Beginning April 1, 2003 and Ending March 31,  
2007 (by renewal)

**Commodity Specialist Name: James Kling**

**CHANGE SUMMARY:**

**Computerized Traffic Data, Inc. has been purchased by Peggy Malone and Associates. All invoices and payments are to be made accordingly. Contact information is listed below:**

**Peggy Malone & Associates**  
14286 Beach Boulevard  
Suite 19-345  
Jacksonville, FL 32250  
(904) 992-8072 (800)247-8602  
Fax: (904) 223-0021  
[pmalone@peggymalone.com](mailto:pmalone@peggymalone.com) [www.peggymalone.com](http://www.peggymalone.com)

**SAP Vendor number: 213982**

ALL OTHER TERMS AND CONDITIONS OF THIS AGREEMENT NOT CHANGED BY THIS CHANGE NOTICE REMAIN AS ORIGINALLY WRITTEN.

Contract Reference Number: 9985-27  
Collective Number: N/A  
SAP Contract Number: 4600007760  
4600007761  
4600007762  
4600007763  
4600007765  
4600007766  
4600007767  
4600007768  
4600007769  
4600007770  
4600009517  
Change Number: 12  
Change Effective Date: May 3, 2007

**COMMONWEALTH OF PENNSYLVANIA  
DEPARTMENT OF GENERAL SERVICES  
HARRISBURG**

**For:** All using Agencies of the Commonwealth  
**Subject:** Traffic Count Services  
**Contract Period:** Beginning April 1, 2003 and Ending March 31, 2008 (by renewal)

**Commodity Specialist Name: James Kling**

**CHANGE SUMMARY:**

This change notice serves to reaffirm that **all** supplier contracts listed above and in change notice #10 have been renewed a third and final period, **effective April 1, 2007 through March 31, 2008**. This renewal supersedes the contract period ending date of change notice #11, which provided the name change of supplier Computerized Traffic Data, Inc. to Peggy Malone and Associates.

ALL OTHER TERMS AND CONDITIONS OF THIS AGREEMENT NOT CHANGED BY THIS CHANGE NOTICE REMAIN AS ORIGINALLY WRITTEN.